

N 90  
B47CS34NOB  
SINGLE OVEN



COOKING PASSION SINCE 1877



A

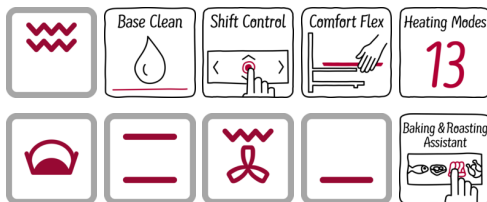

#### Included accessories

2 x combination grid, 1 x universal pan

#### Optional accessories

Z11CR10X0 Baking and roasting grid (standard)  
Z11SZ80X0 SeamlessCombination 60 + 29cm  
Z11SZ90X0 SeamlessCombination 60 + 45cm  
Z11TC10X0 ComfortFlex Rail (1 level)  
Z12CB10A0 Baking tray, anthracite enamelled  
Z12CM10A0 Moussaka pan, anthracite enamelled  
Z12CQ10A0 Grill tray, anthracite enamelled  
Z18C60X0 Cookbook

Built-in oven with SLIDE&HIDE® - unrestricted access to the oven interior

- ✓ Slide&Hide® - unrestricted access in the oven interior and easy handling due to rotating handle
- ✓ CircoTherm® - the unique hot air-system for simultaneous baking and roasting on up to 3 levels
- ✓ EcoClean - the self-cleaning catalytic coating on the sides of your oven make cleaning the inside easier.
- ✓ EasyClean - the quick and easy option for day-to-day maintenance
- ✓ BaseClean - a special cleaning programme designed to help clean the base of the oven
- ✓ Shift Control - fast navigation through menus and simple operation with the generous TFT display.
- ✓ ComfortFlex® - the telescopic rails come out far enough to let you grasp the baking sheet conveniently from the sides.

#### Features

##### Technical Data

Color / Material Front : Stainless steel  
Construction type : Built-in  
Integrated Cleaning system : Catalytic all sides, Hydrolytic  
Required niche size for installation (HxWxD) : 585-595 x 560-568 x 550  
Dimensions of the product (mm) : 595 x 596 x 548  
Dimensions of the packed product (HxWxD) (mm) : 675 x 690 x 660  
Control Panel Material : Stainless steel  
Door Material : Glass  
Net weight (kg) : 38.330  
Usable volume of cavity (l) : 71  
Cooking method : , 4D hot air, Bottom heat, Bread Baking Setting, Conventional heat, Defrost, Dough proving setting, Full width grill, Half width grill, Hot Air-Eco, Hot air grilling, low temperature cooking, Pizza setting  
First cavity material : Enamelled  
Temperature control : electronic  
Number of interior lights : 1  
Approval certificates : CE, VDE  
Length of electrical supply cord (cm) : 120  
EAN code : 4242004181576  
Number of cavities (2010/30/EC) : 1  
Energy efficiency class (2010/30/EC) : A  
Energy consumption per cycle conventional (2010/30/EC) : 0.90  
Energy consumption per cycle forced air convection (2010/30/EC) : 0.74  
Energy efficiency index (2010/30/EC) : 87.1  
Electrical connection rating (W) : 3450  
Current (A) : 16  
Voltage (V) : 220-240  
Frequency (Hz) : 60; 50  
Plug type : no plug



4 242004 181576

N 90  
B47CS34NOB  
SINGLE OVEN

## Features

### Design

- 4.1" TFT colour and graphics display with ShiftControl
- Illuminated Shift Control
- Cavity inner surface: Enamel anthracite
- Slide&Hide® with rotating handle

### Features

- Control panel lock  
Automatic safety switch off  
Residual heat indicator  
Start button  
Door contact switch
- Temperature proposal  
Actual temperature display  
Heating up indicator  
Sabbath setting
- Baking and roasting assistant
- Interior halogen light
- Triple glazed door

### Cleaning

- EcoClean Direct : ceiling, side liners, back panel
- EcoClean programme, Base Clean programme
- Full glass inner door

### Programmes/functions

- 13 heating methods: CircoTherm®, CircoTherm® Gentle, Top/bottom heat, Conventional heat Gentle, Hot air grilling, Full surface grill, Centre surface grill, CircoTherm® intensive, Bread baking, Bottom heat, Low temperature cooking, Defrost, Dough proving
- Rapid heat
- Cooling fan

### Accessories

- 1-level flexible telescopic rail, full extension, Stop function
- 2 x combination grid, 1 x universal pan

### Performance/technical information

- Energy efficiency rating (acc. EU Nr. 65/2014): A  
Energy consumption per cycle in conventional mode: 0.9 kwh  
Energy consumption per cycle in fan-forced convection mode: 0.74 kwh  
Number of cavities: Main cavity  
Heat source: electrical  
Cavity volume: 71 litre
- Total connected load electric: 3.45 KW
- Temperature range 40 °C - 275 °C
- Length of mains cable: 120 cm
- Nominal voltage: 220 - 240 V
- Appliance dimension (h x w x d): 595 mm x 596 mm x 548 mm
- Niche dimension (h x w x d): 585 mm - 595 mm x 560 mm - 568 mm x 550 mm
- Please refer to the dimensions provided in the installation manual

N 90  
B47CS34N0B  
SINGLE OVEN

Dimensioned drawings

Installation with a hob.

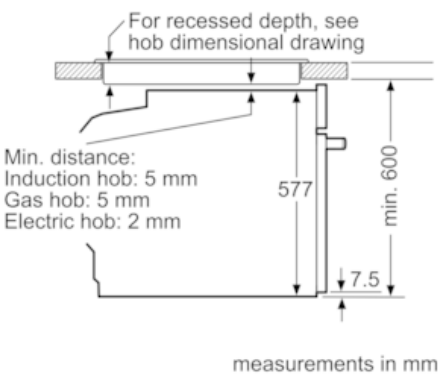

If the appliance will be installed underneath  
a hob, the following worktop thicknesses  
(including substructure if necessary)  
must be taken into account.

Hob type	min. worktop thickness	
	fitted	flush
Induction hob	37 mm	38 mm
Full surface Induction hob	47 mm	48 mm
Gas hob	30 mm	38 mm
Electric hob	27 mm	30 mm

