



WIRED

For: PS3™ | Xbox 360® | PC
Mac® | Mobile

EARFORCE® **PX22**

AMPLIFIED UNIVERSAL GAMING HEADSET

User Guide

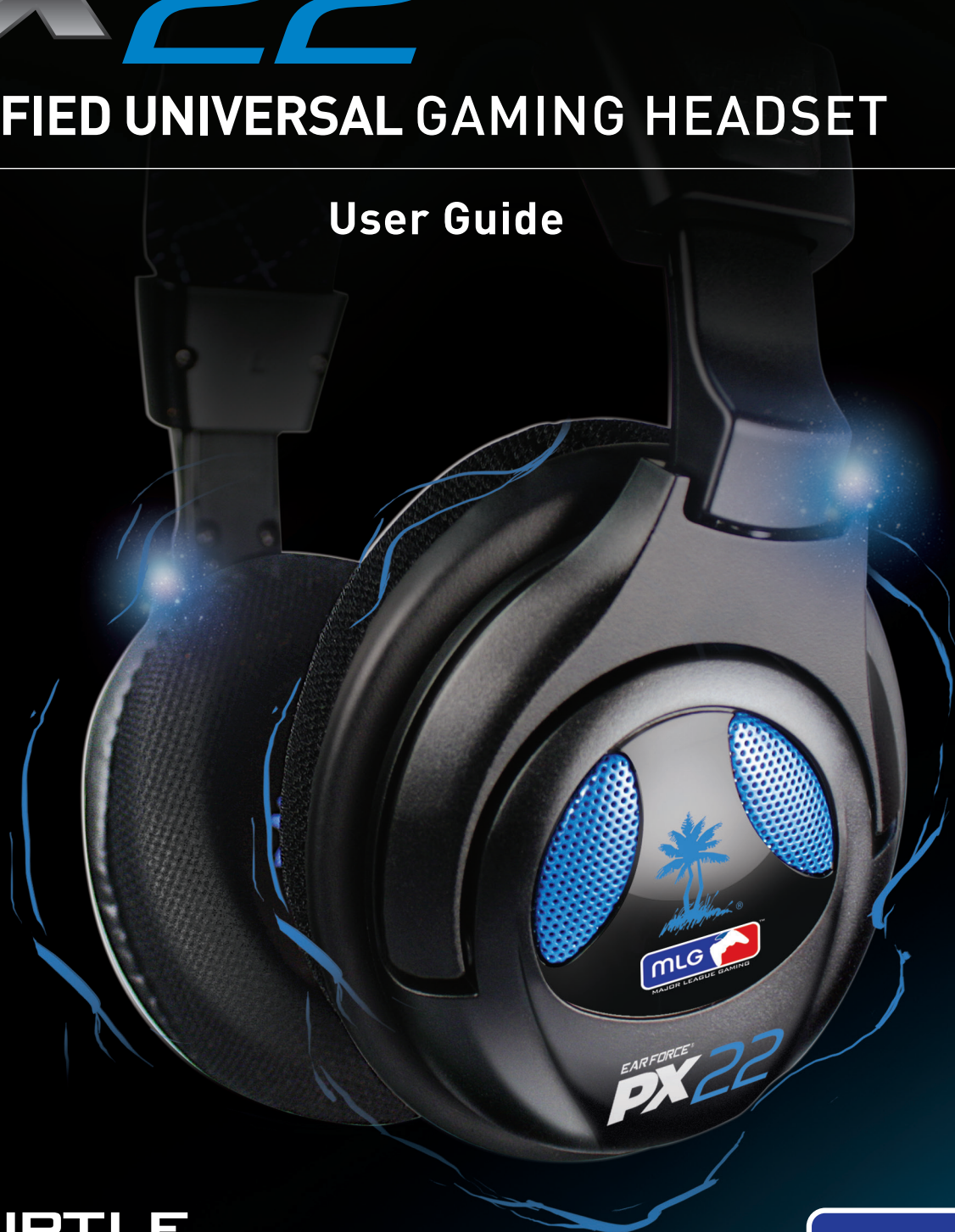

#1 IN GAMING AUDIO



#1 for Competitive Gaming



Congratulations on your purchase of the Ear Force PX22 headset from Turtle Beach. The PX22 works with your consoles, PC or Mac and all of your favorite mobile devices. Welcome to the Turtle Beach Audio Advantage! For our Knowledgebase and Technical Support Contact info please visit: <http://www.turtlebeach.com/support>



Table of Contents

| | |
|---------------------------------------|-----|
| Package Contents | P4 |
| Features | P5 |
| Amplifier Function Map / Use | P6 |
| PS3™ Hardware Setup (HDMI / RCA) | P7 |
| Using your PX22 Headset on PS3™ | P11 |
| Xbox 360® Hardware Setup (HDMI / RCA) | P12 |
| Using your PX22 Headset on Xbox 360® | P17 |
| PC / Mac® Hardware Setup | P18 |
| PC Setup | P19 |
| Mobile Setup | P21 |
| Specifications | P23 |
| Compliance / Conformity | P24 |
| Warranty | P26 |

Package Contents



EarForce PX22 Headset

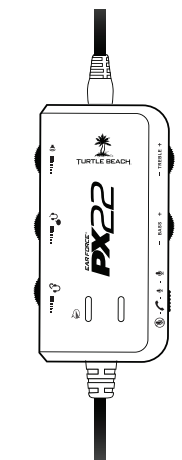

Inline Amplifier

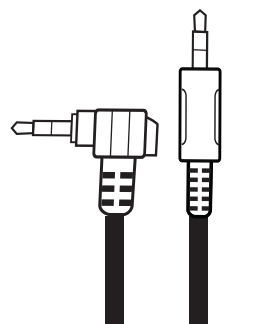

Xbox 360 Talkback Cable

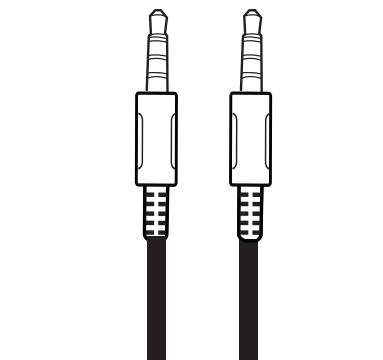

3.5mm, 4-Pole Auxiliary Cable

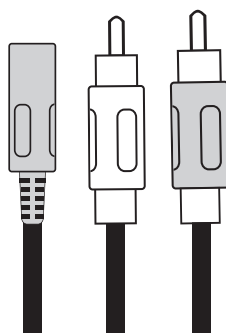

RCA Splitter Cable



Turtle Beach Stickers

Features

Features

- **Adjustable Bass & Treble Levels:** Tune bass and treble levels to add depth and realism.
- **Dynamic Chat Boost:** Automatically adjusts the volume of chat based on game volume changes.
- **Independent Volume Controls:** Separate game and chat volume controls plus mic mute on the inline amp.
- **Variable Mic Monitor:** Adjust the volume of your voice in the headset while speaking. To mute Mic Monitor, turn wheel all the way down.
- **Mobile Compatibility:** The headset can disconnect from the inline amp and plug into all of your tablet and phone devices for mobile gaming and entertainment.
- **Phone/Music Input:** Connect a mobile phone or digital music player to answer calls or enjoy your favorite music while gaming. **Note:** Requires the included 3.5mm, 4-Pole Auxiliary Cable.
- **USB Powered:** No AC adapters or batteries required.



Amplifier Function Map / Use

Inline Amplifier

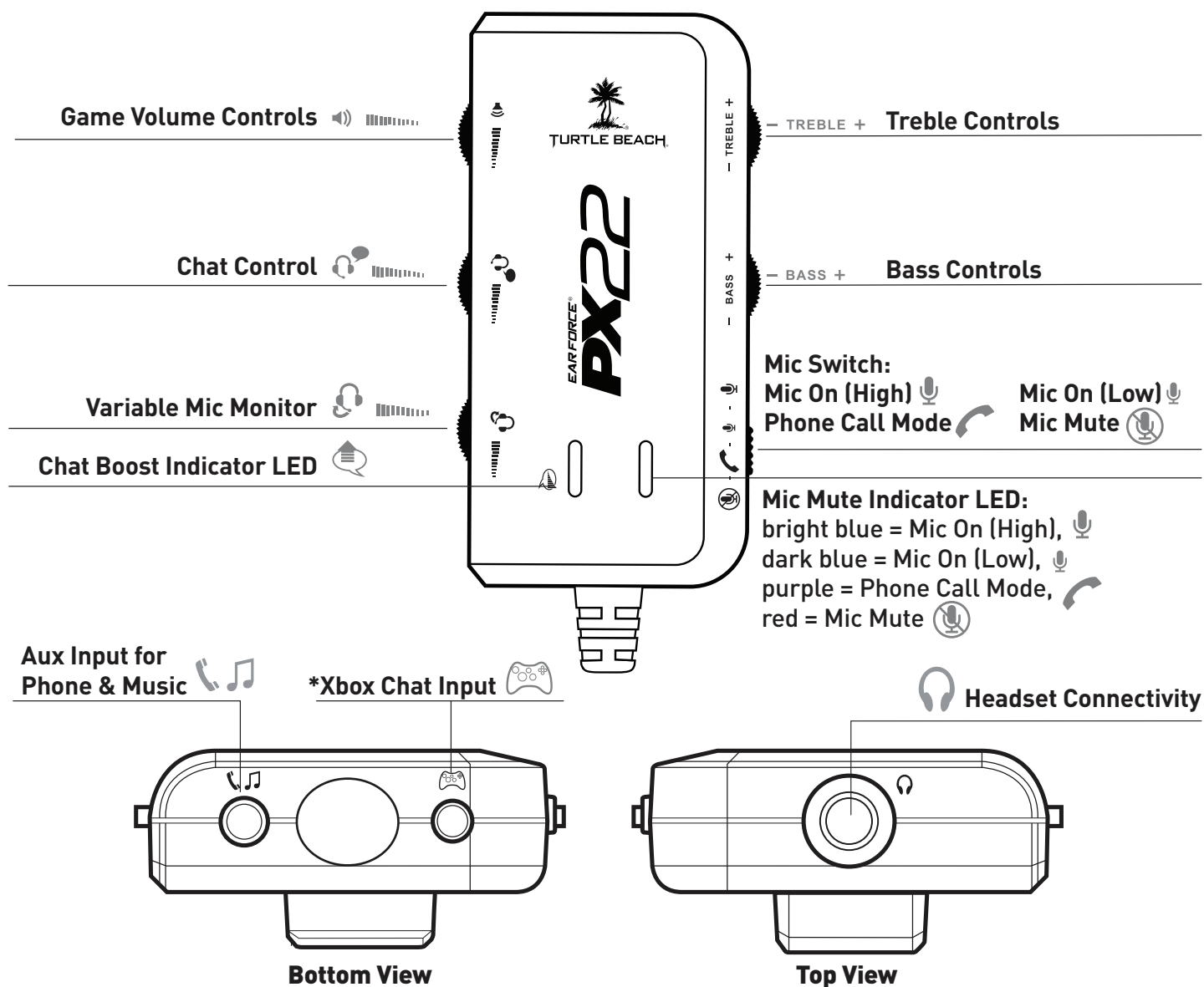

PS3™ Hardware Setup HDMI / RCA

PS3™ Setup (HDMI)

1

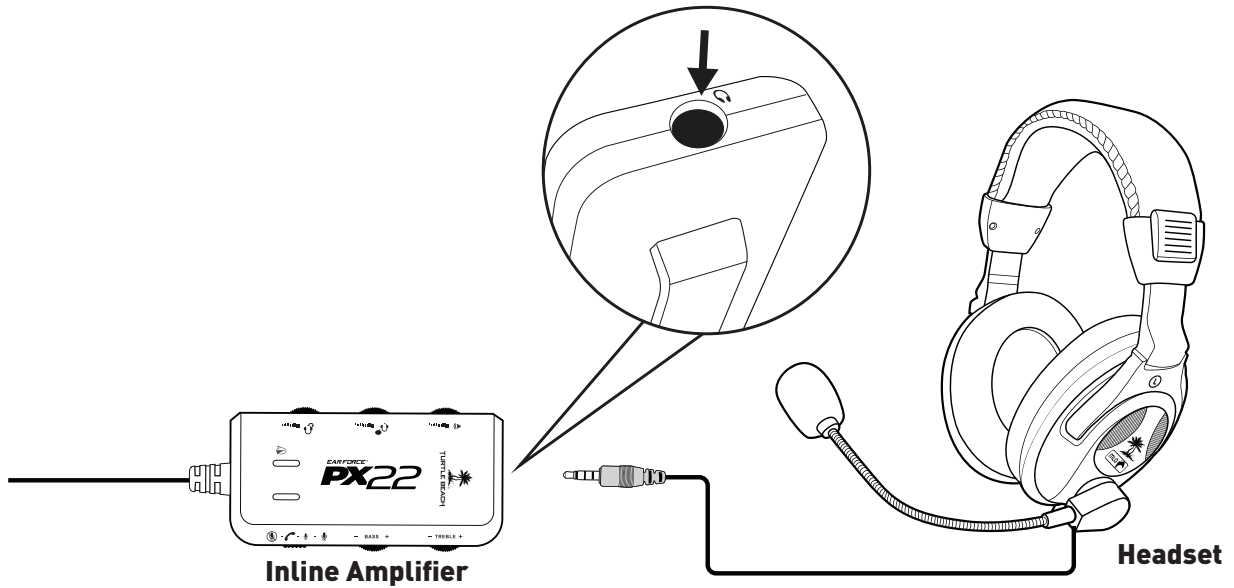

2

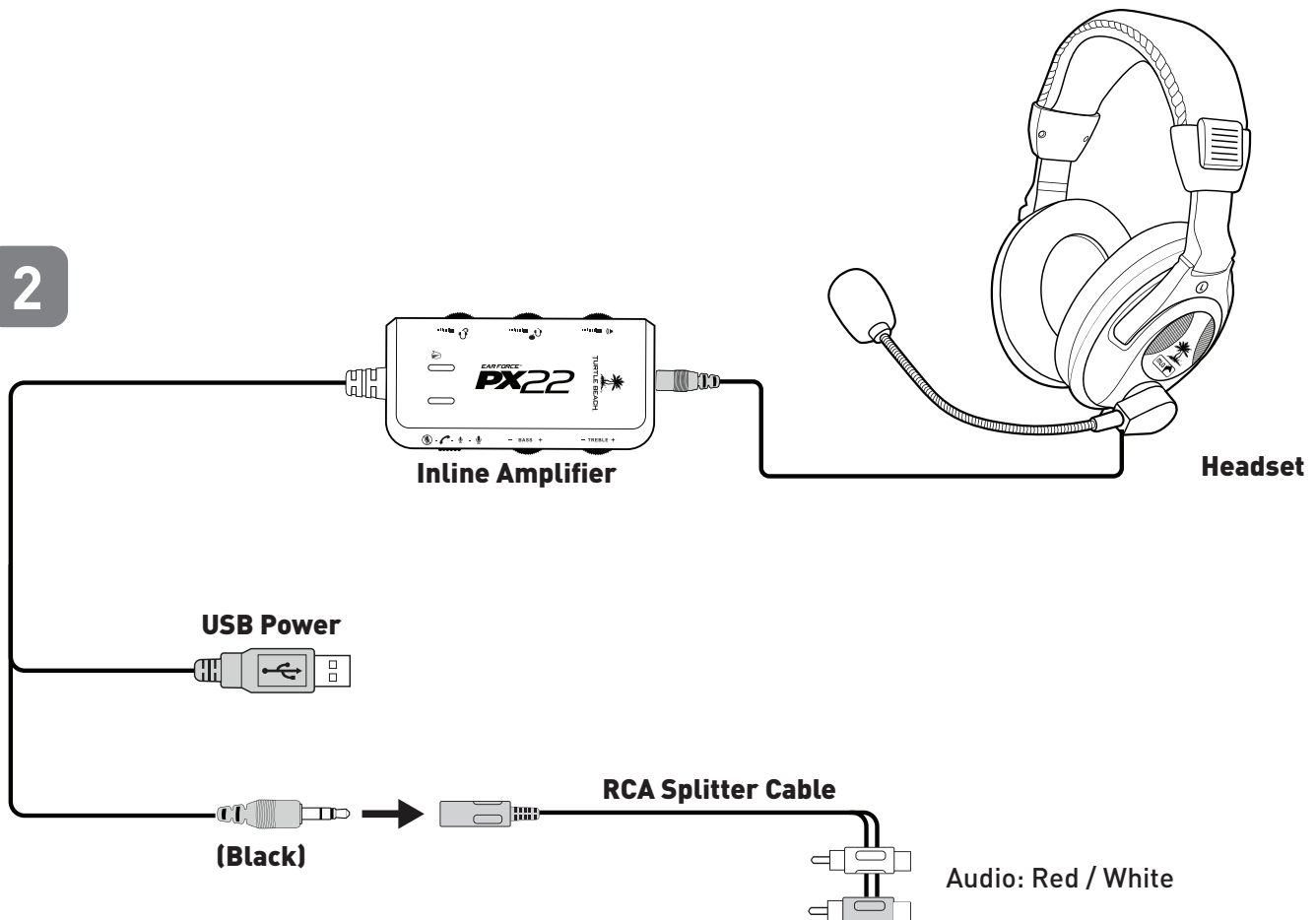

PS3™ Hardware Setup HDMI / RCA

PS3™ Setup (HDMI)

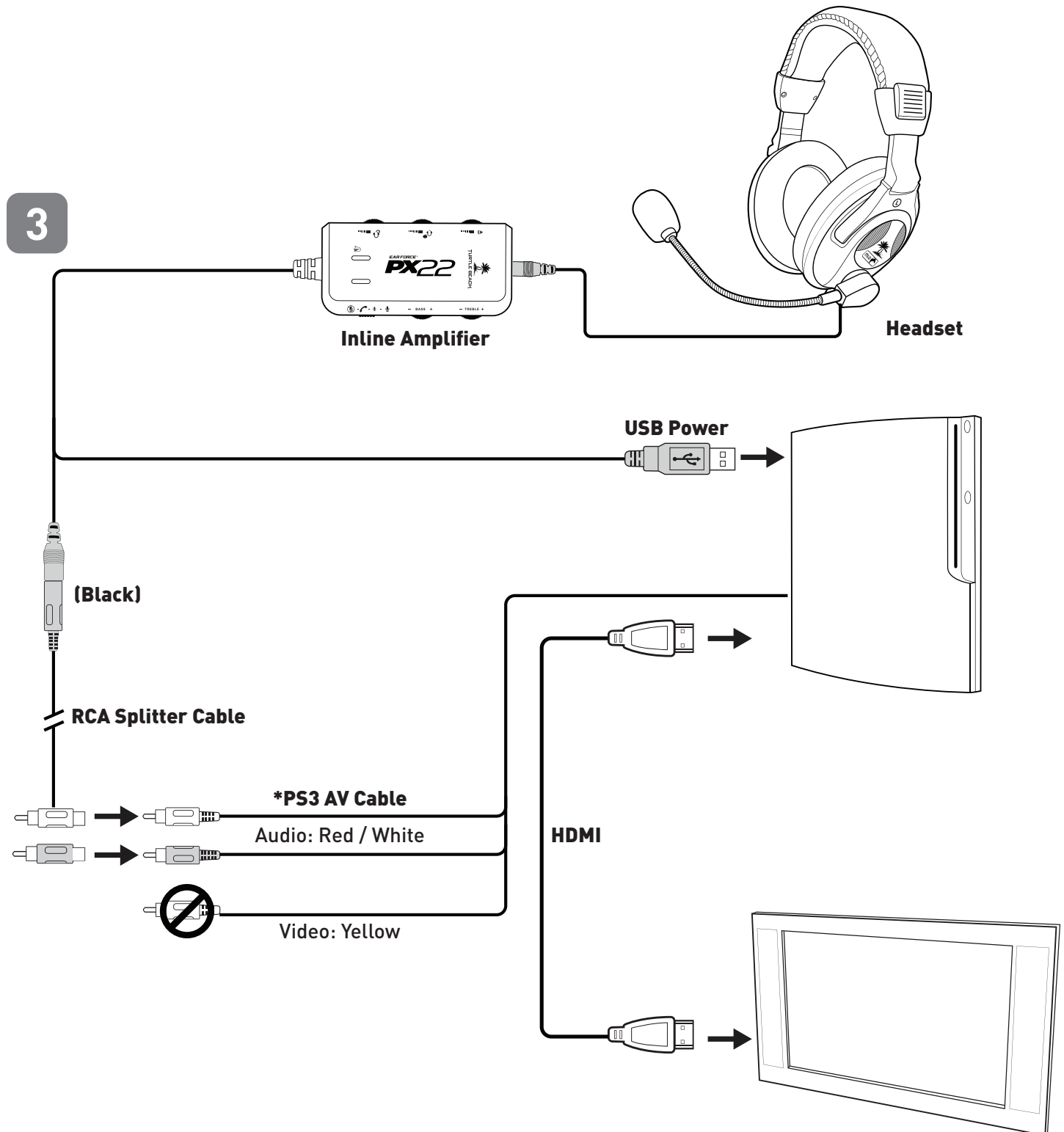

*PS3 AV cable is included with your console.

PS3™ Hardware Setup HDMI / RCA

PS3™ Setup (RCA)

1

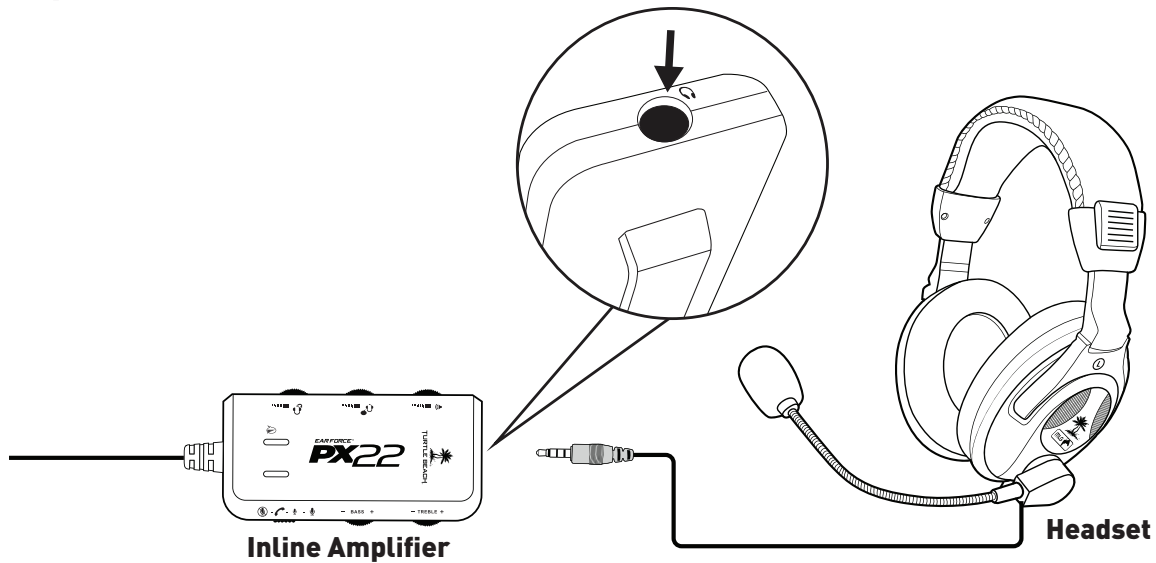

2

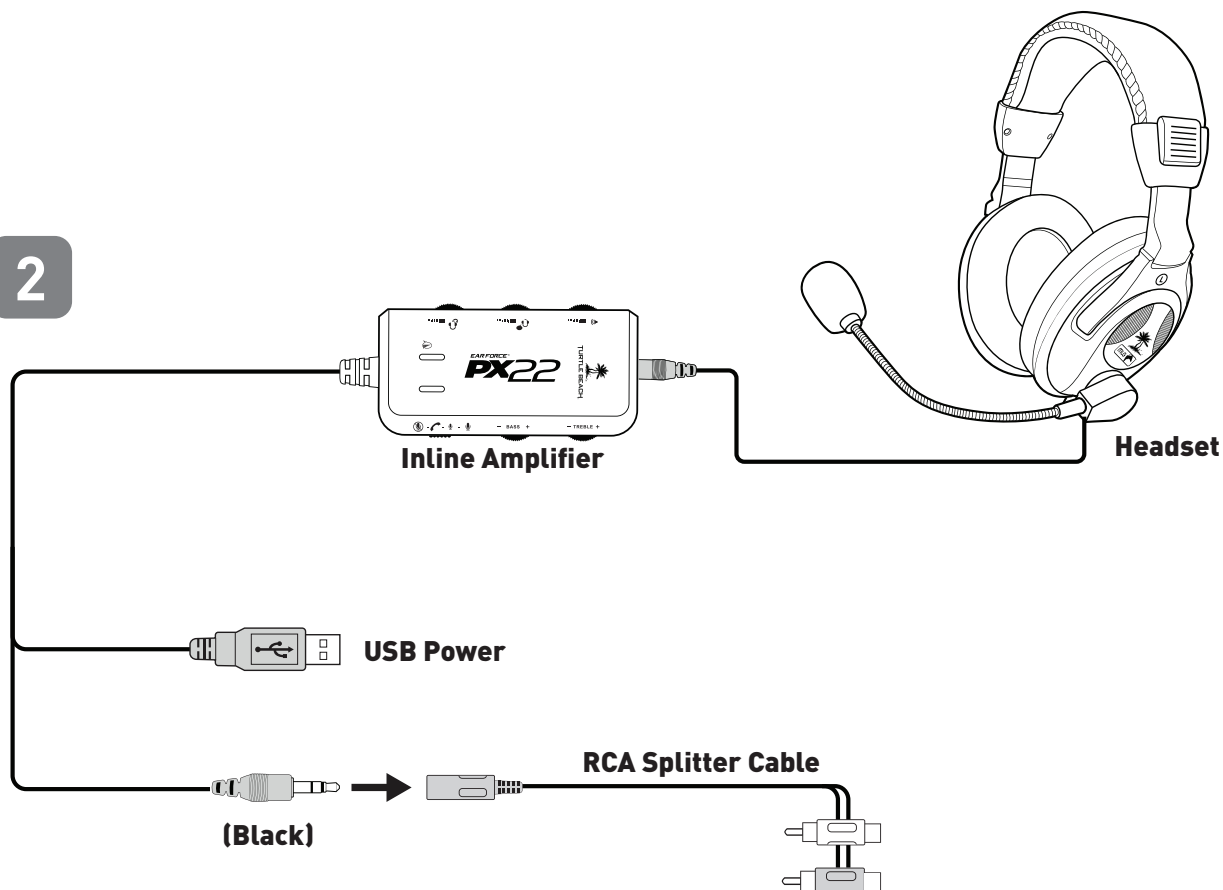

*PS3 AV cable is included with your console.

PS3™ Hardware Setup HDMI / RCA

PS3™ Setup (RCA)

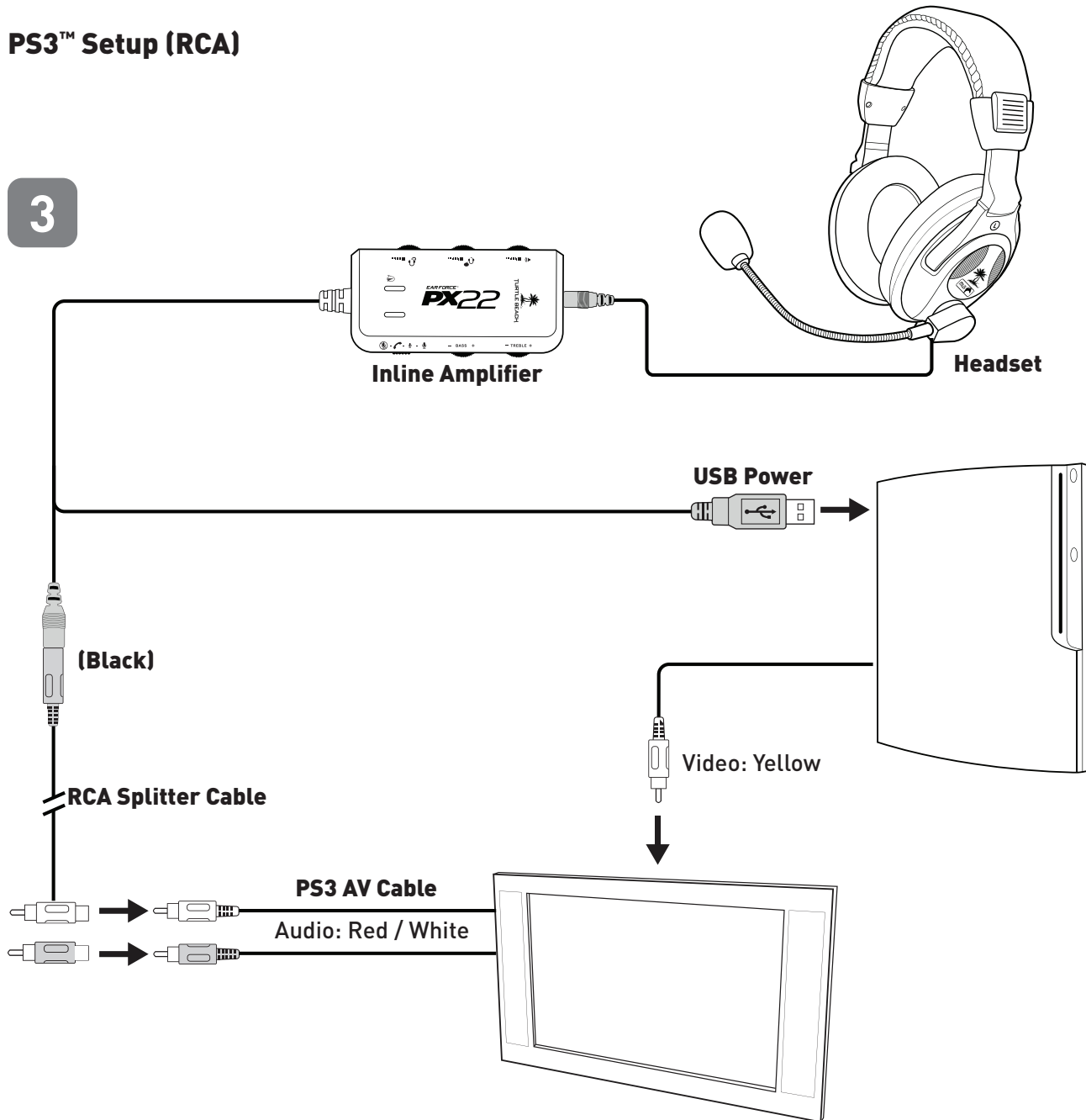

*PS3 AV cable is included with your console.

Using your PX22 Headset on PS3™

HDMI or digital (optical)

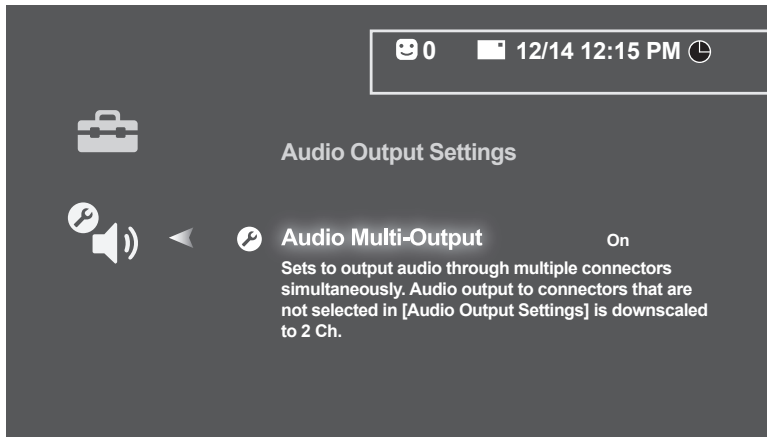

1. Go to Settings
 - Choose **“Sound Settings”**
 - Choose **“Audio Multi-Output”** and set to **“On”**

Chat Setup

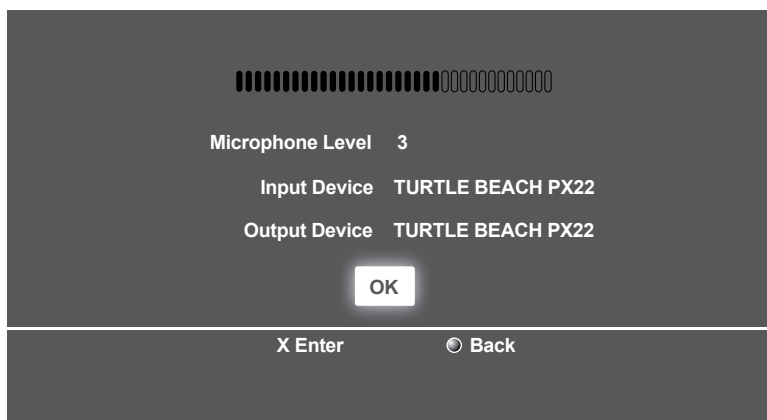

1. Go to PS3 Settings
 - Choose **“Accessory Settings”**
 - Choose **“Audio Device Settings”**
 - Set **“Input Device”** to **“TURTLE BEACH PX22”**
 - Set **“Output Device”** to **“TURTLE BEACH PX22”**
 - Select **“OK”**
2. Set Microphone Level to 3 or 4

Xbox 360® Hardware Setup HDMI / RCA

Xbox 360® Setup (HDMI)

1

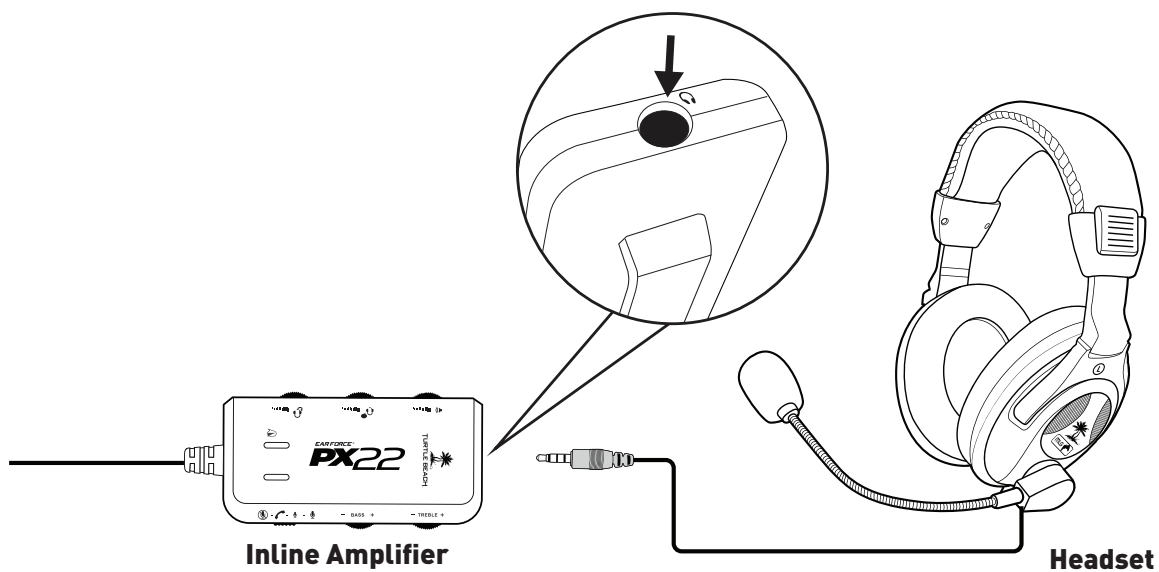

2

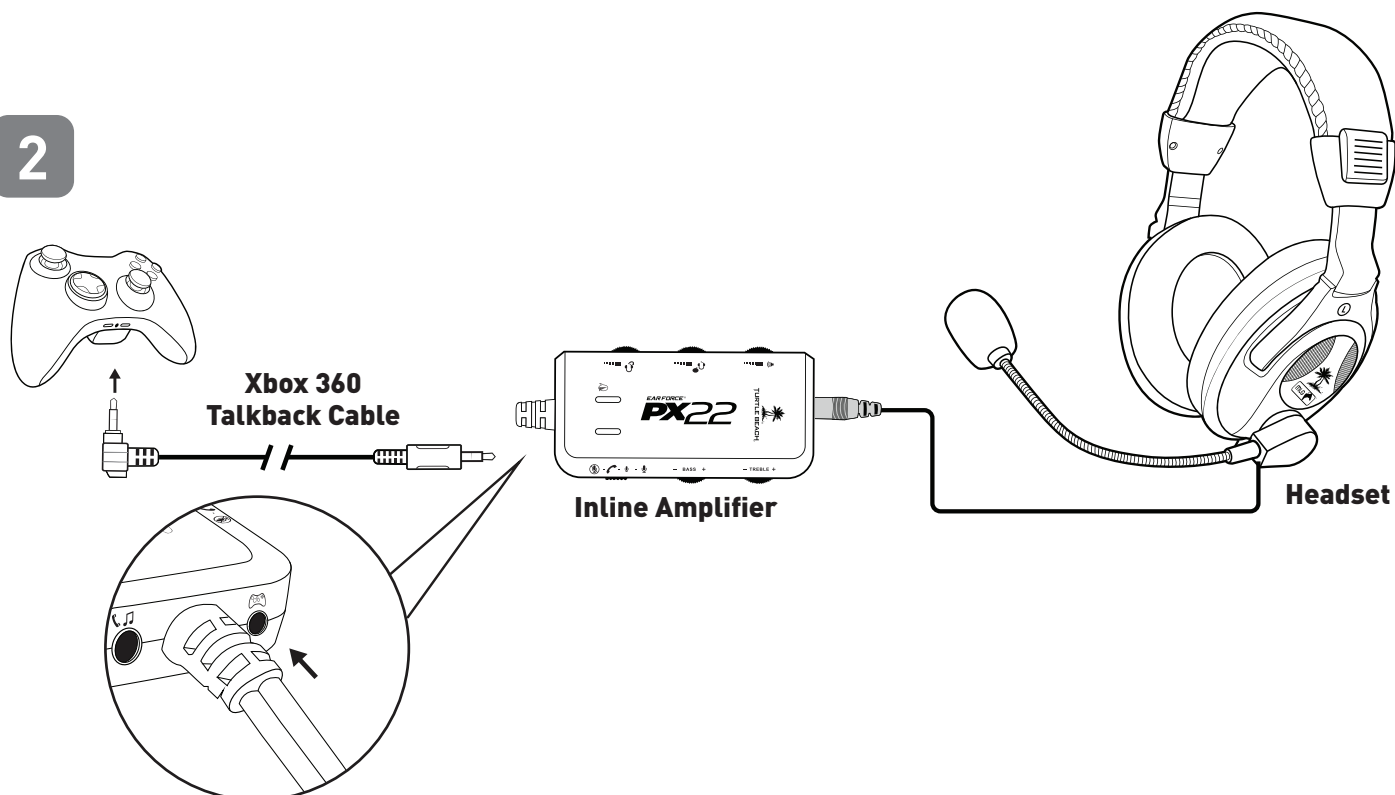

Xbox 360® Hardware Setup HDMI / RCA

Xbox 360® Setup (HDMI)

3

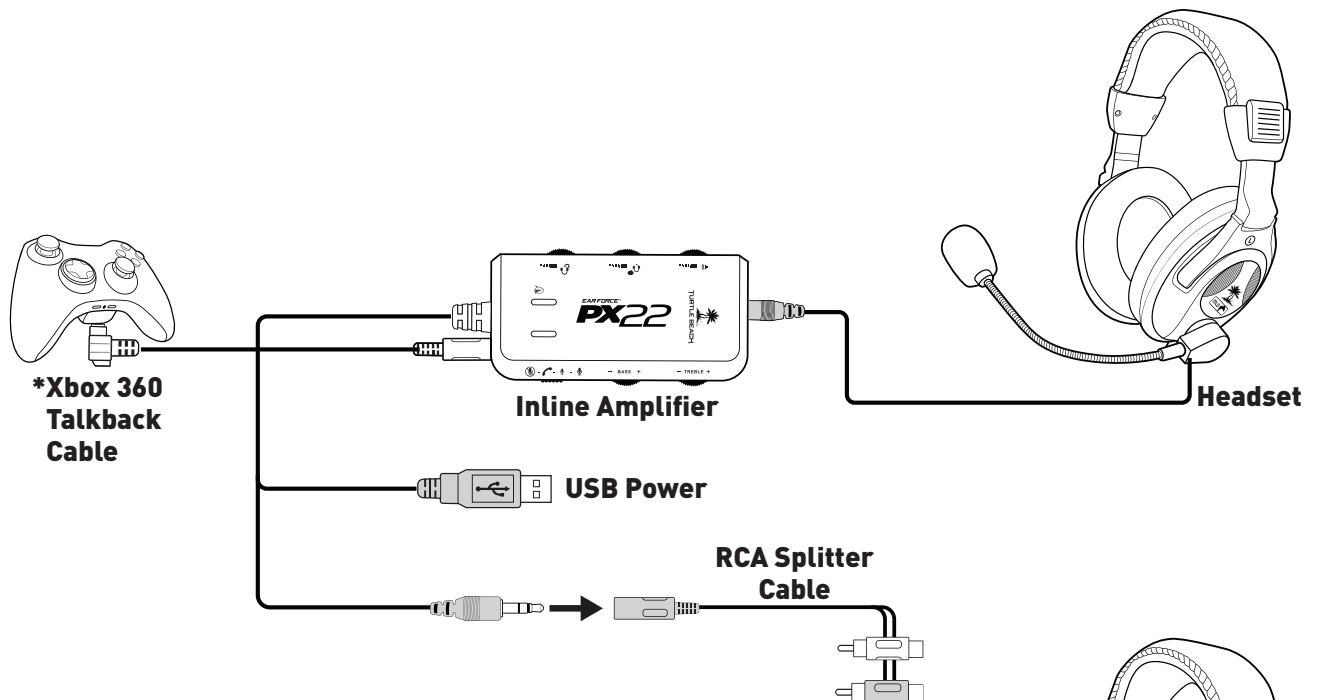

4

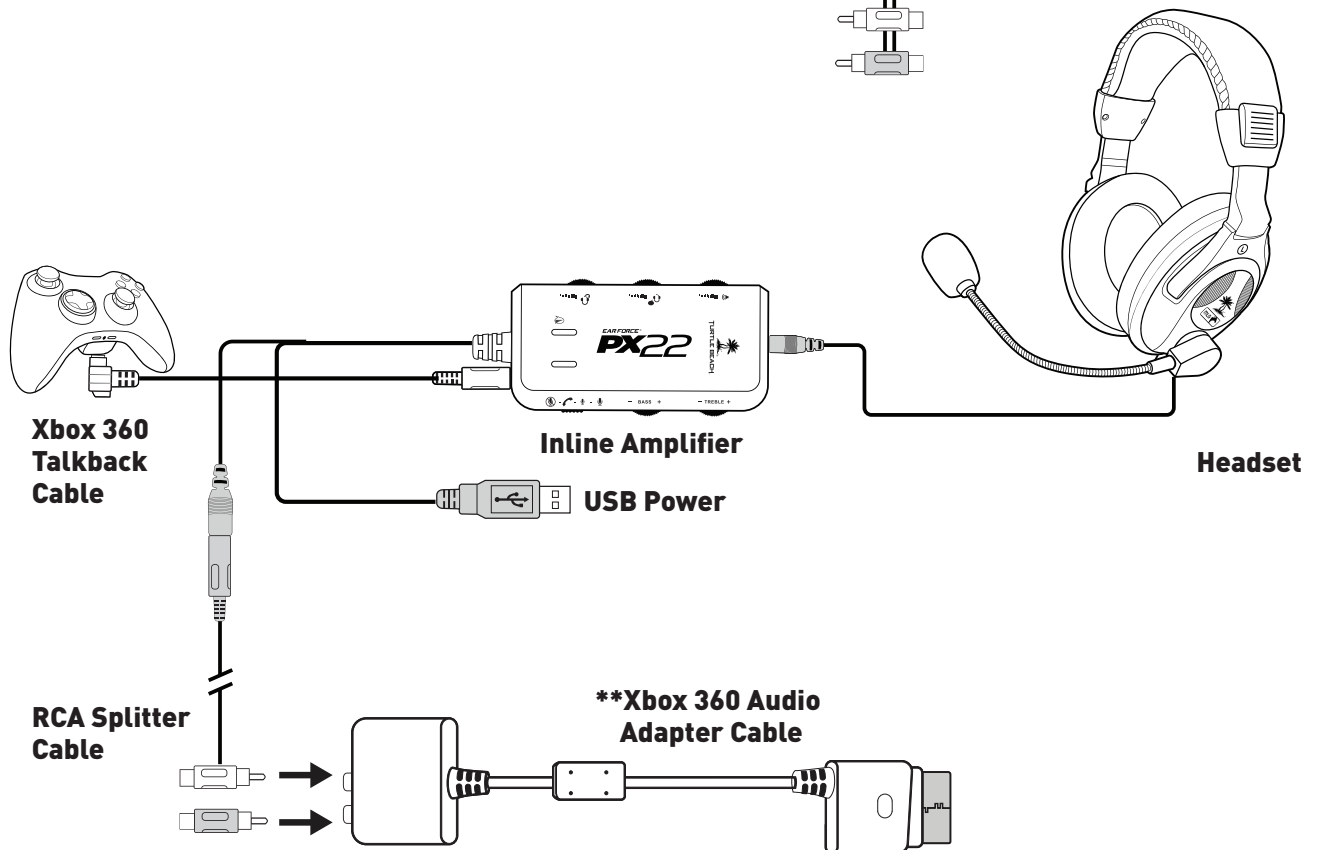

* For best Xbox chat performance, use with official Microsoft Xbox 360 products. **All Xbox 360 models require an Xbox 360 Audio Adapter Cable for audio output when used with an HDMI connection (Adapter available from turtlebeach.com). **NOTE:** If your HDMI TV has red and white AUDIO OUT RCA jacks, you can use it to feed the sound from your TV to your PX22 headset. (AUDIO IN jacks will not send sound to your headset. AUDIO OUT is required).

Xbox 360® Hardware Setup HDMI / RCA

Xbox 360® Setup (HDMI)

5

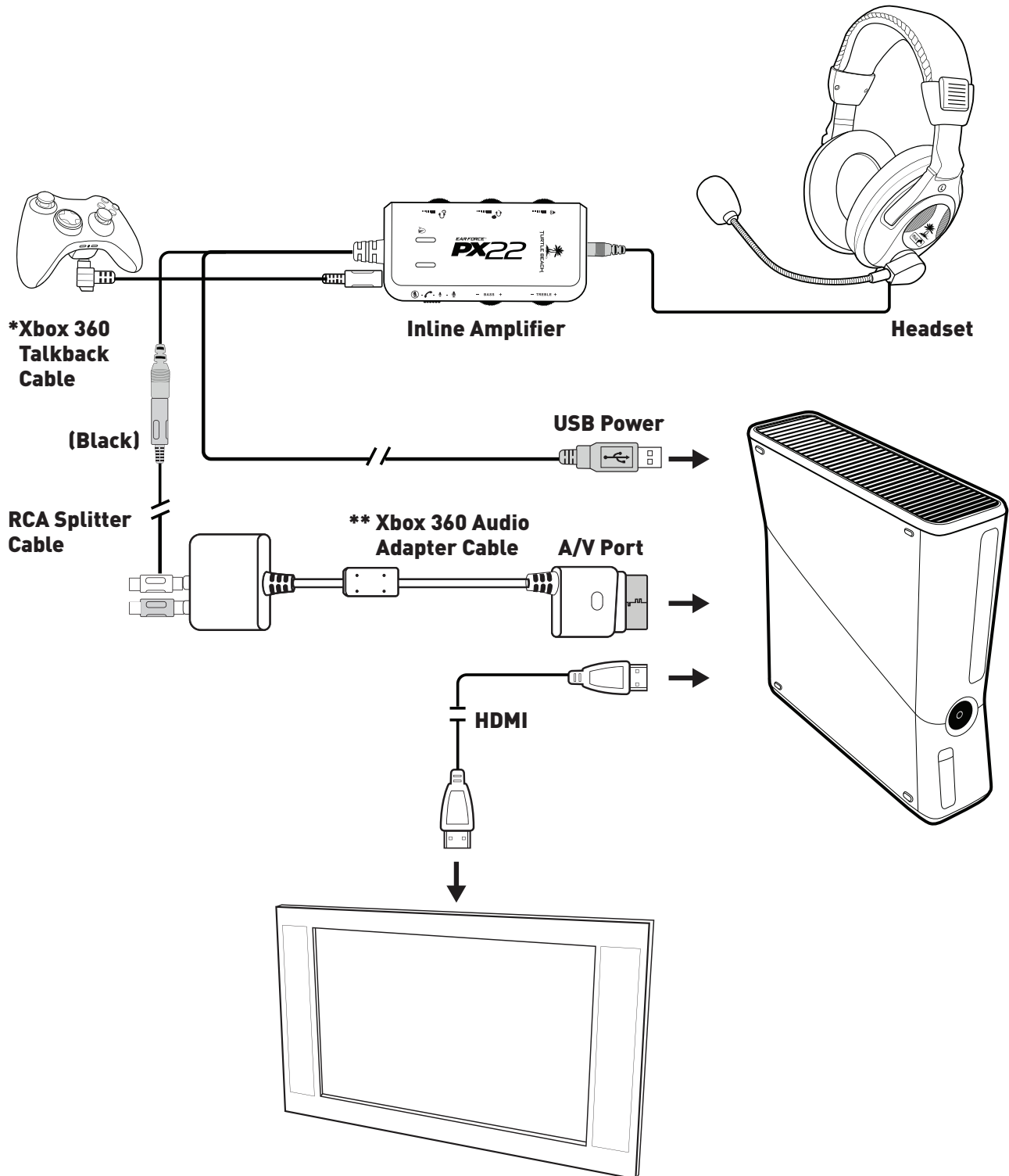

* For best Xbox chat performance, use with official Microsoft Xbox 360 products. **All Xbox 360 models require an Xbox 360 Audio Adapter Cable for audio output when used with an HDMI connection (Adapter available from turtlebeach.com). **NOTE:** If your HDMI TV has red and white AUDIO OUT RCA jacks, you can use it to feed the sound from your TV to your PX22 headset. (AUDIO IN jacks will not send sound to your headset. AUDIO OUT is required).

Xbox 360® Hardware Setup HDMI / RCA

Xbox 360® Setup (RCA)

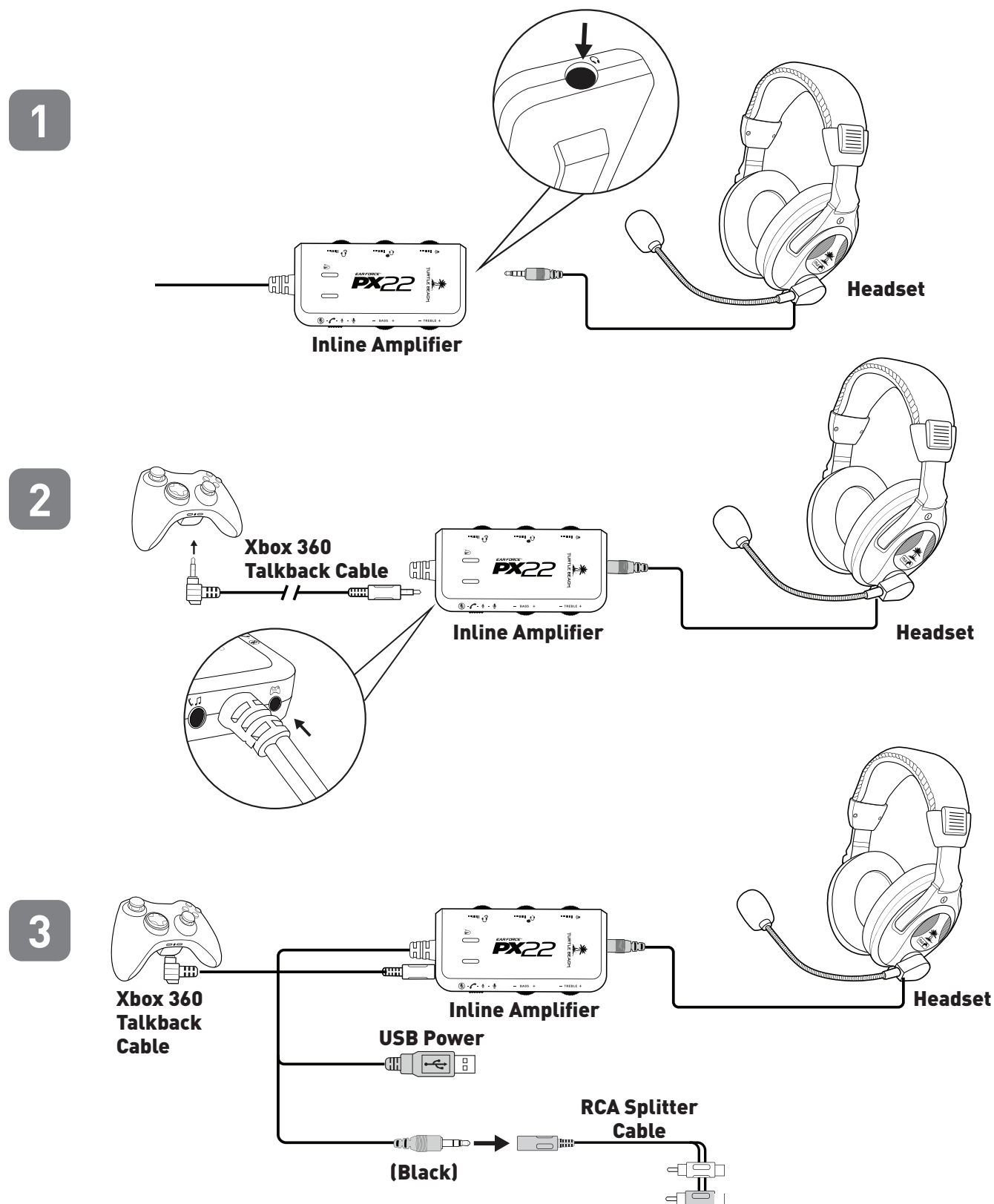

Xbox 360® Hardware Setup HDMI / RCA

Xbox 360® Setup (RCA)

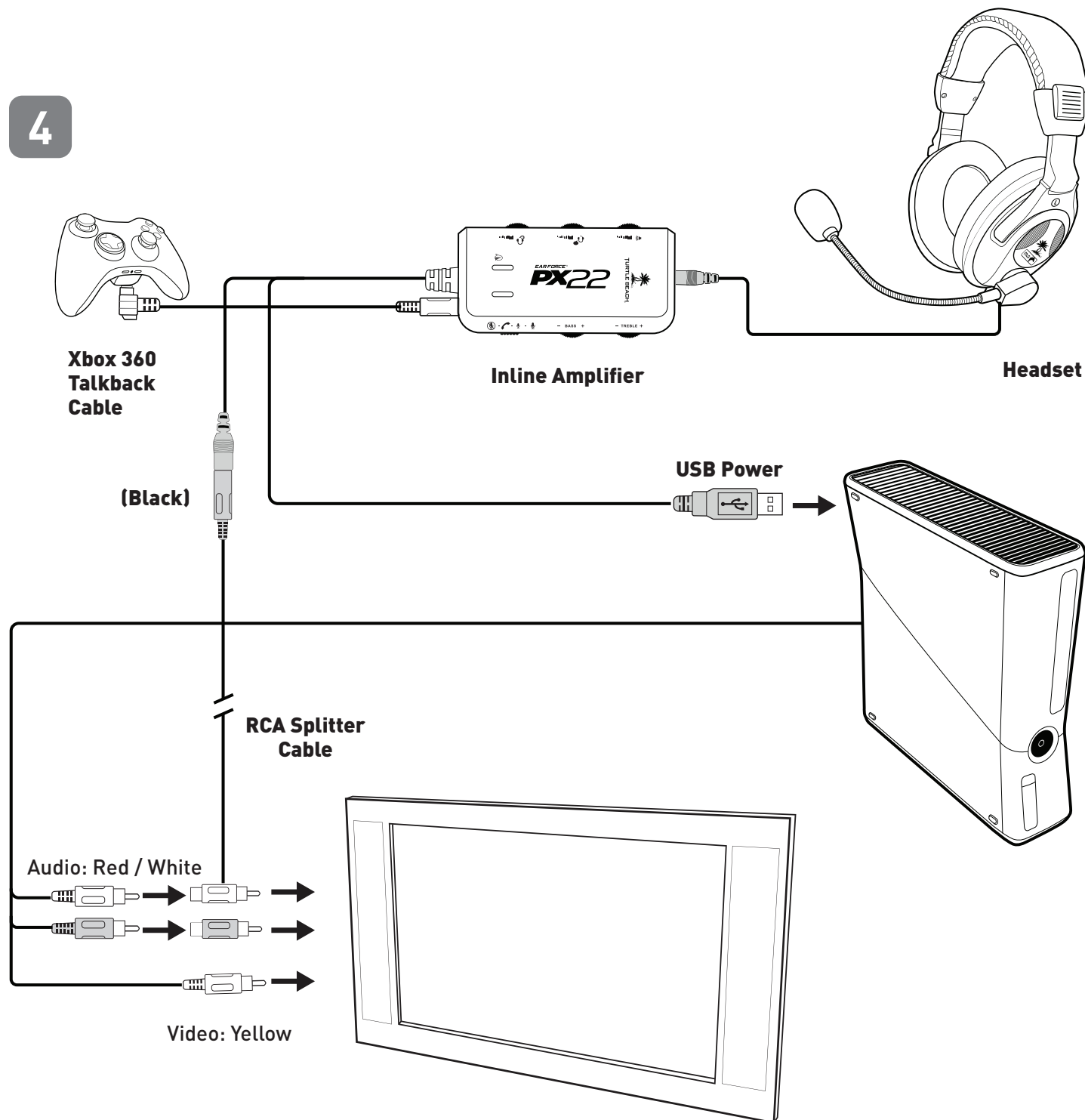

NOTE: The white/red RCA plugs need to be connected to the TV's AUDIO IN jacks if you want to hear game audio in your TV in addition to your headset

Using your PX22 Headset on Xbox 360®

Xbox 360® Configuration

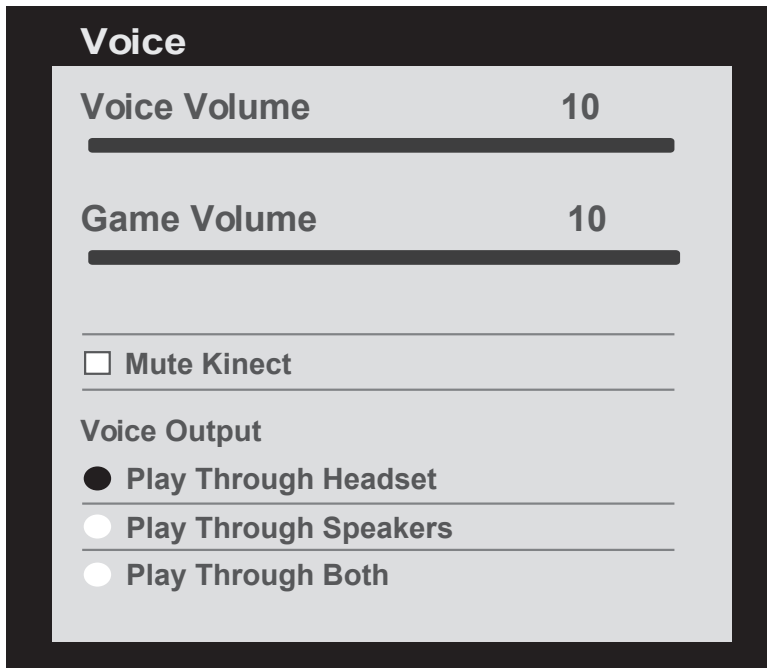

1. Go back to Xbox Settings
 - Choose **"Preferences"**
 - Choose **"Voice"**
 - Set both Voice Volume and Game Volume to **"10"**
 - Set **"Voice Output"** to **"Play Through Headset"**

PC / Mac Hardware Setup

PC / Mac Setup

When used as a PC/Mac gaming headset, the PX22 functions as an Amplified USB Stereo Headset. When connected to a PC or Mac, the PX22 appears in Windows and Mac operating systems as **“TURTLE BEACH PX22.”** This allows the PX22 microphone to be assigned for chat use in game software as a USB audio device.

The green 3.5mm plug is used for sending the stereo game signal from the computer sound card to the PX22 amplifier, allowing game sounds, music and other sounds to be heard from the computer.

Note: Both plugs must be connected. Set system volume to maximum and then adjust system volume via the game volume wheel.

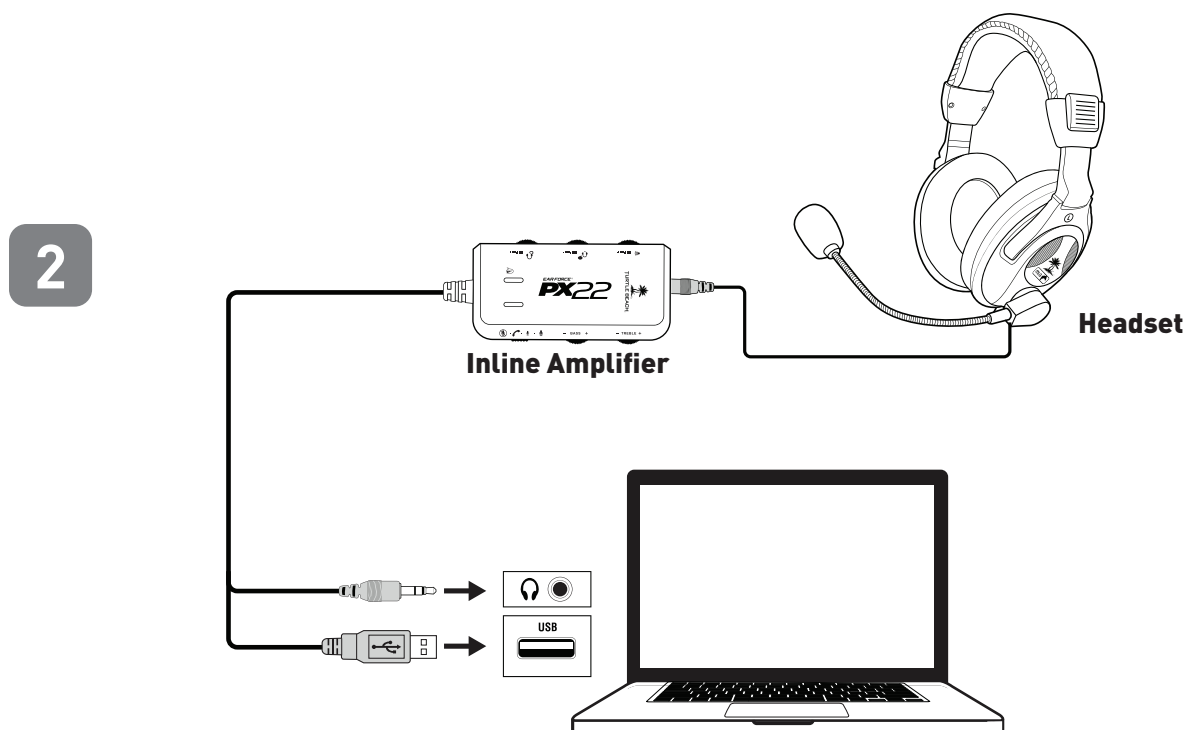
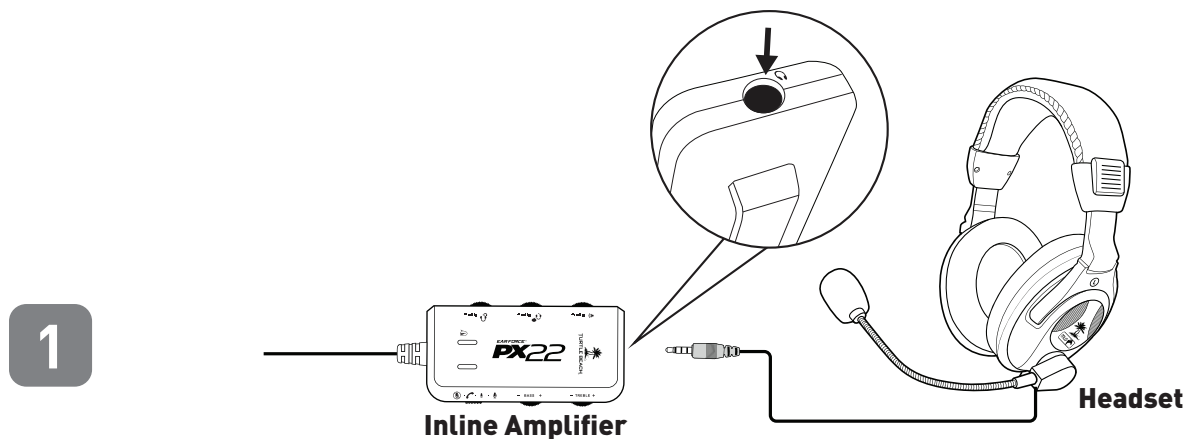

PC Setup

PLEASE NOTE: Depending on your OS Version, the screens may differ but the steps will remain the same.

1. Right-click the speaker icon in your task bar and select **“Playback Devices”**

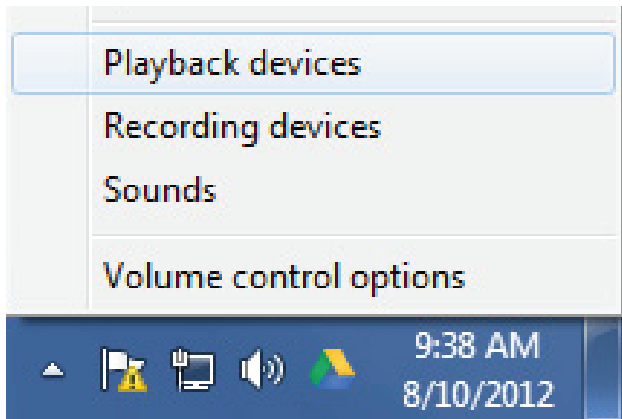

2. Right-click on **“Speakers”** and select **“Set as Default Device”**. Next, right-click on **“TURTLE BEACH PX22 CHAT”** and select **“Set as Default Communication Device”**.

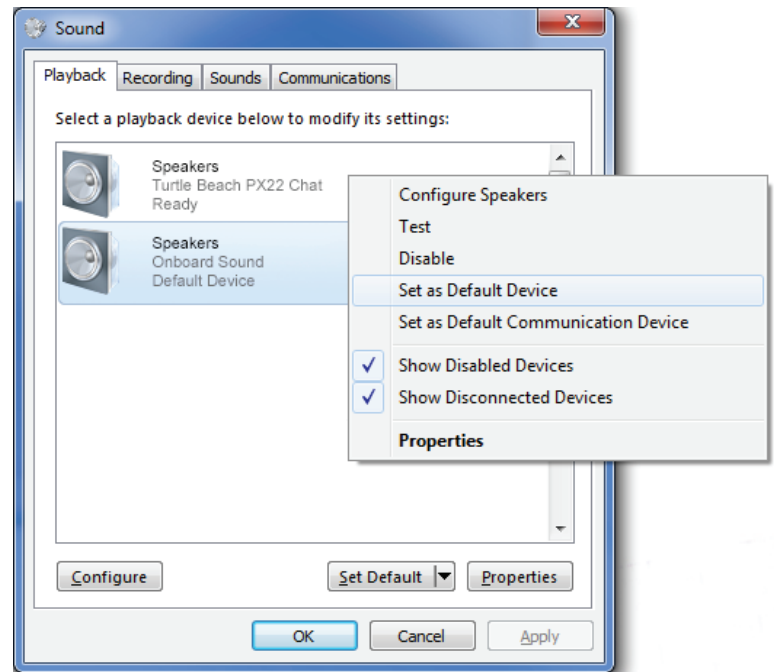

3. Click on the **“Recording Tab”**, then right-click **“TURTLE BEACH PX22 CHAT”** and select **“Set as Default Device.”** If you speak into the mic you should see green bars on the right move.

4. Click on the **“OK”** button at the bottom of the window to exit

NOTE: In order to maintain independent volume controls for chat and game, please make sure to set **“TURTLE BEACH PX22 CHAT”** as both the recording and playback device in the audio setting for your voice chat application.

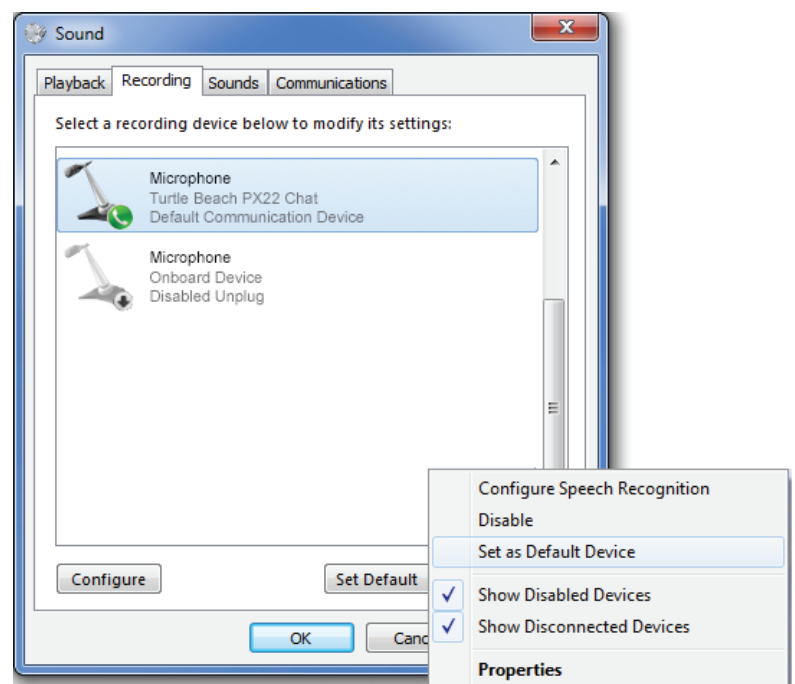

Mac Setup

PLEASE NOTE: Depending on your OS Version, the screens may differ but the steps will remain the same.

1. Click on the Apple Menu and select System Preferences » Sounds.
2. On Output tab, select **“Headphones”**.



3. On Input tab, select **“TURTLE BEACH PX22 CHAT”**.

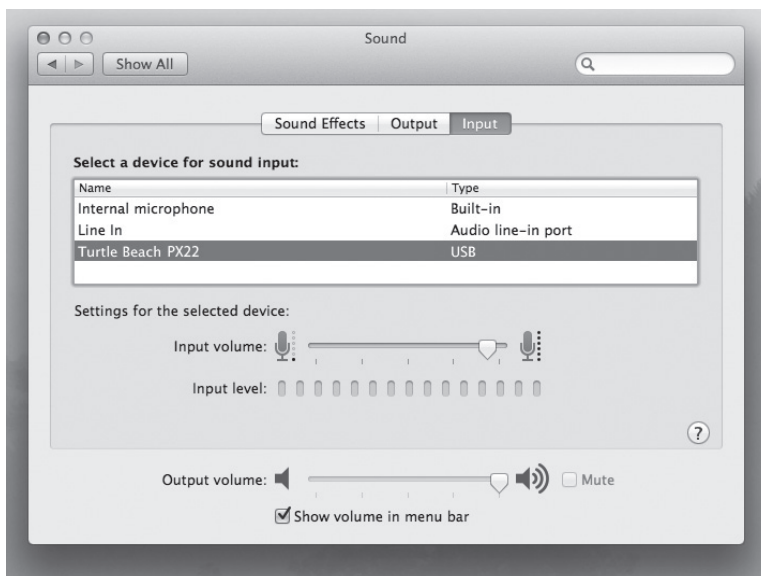

NOTE: In order to maintain independent volume controls for chat and game, please make sure to set **“TURTLE BEACH PX22”** as both the recording and playback device in the audio setting for your voice chat application.

Mobile Setup

Direct Connection

Connect the 3.5mm plug to a mobile device to listen to music or movies, play games or take phone calls.

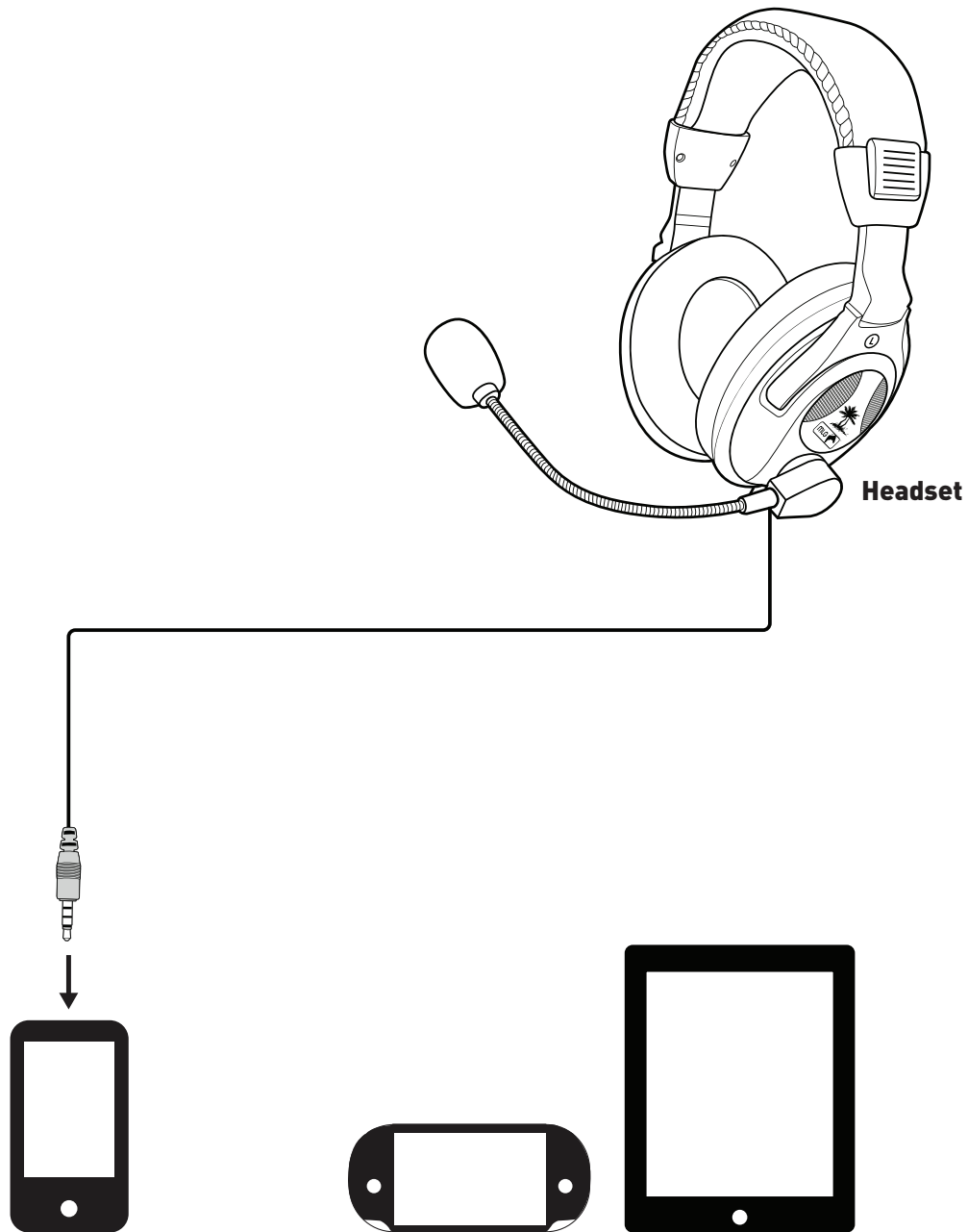

Works with many mobile devices

Mobile Setup

Using the Inline Amplifier

PLEASE NOTE: Inline amp must be in phone call mode or your voice will be routed over your PC/Console's chat channel. You will hear the caller no matter where the switch is set but if not in the phone call mode, your caller will not hear you and others will.

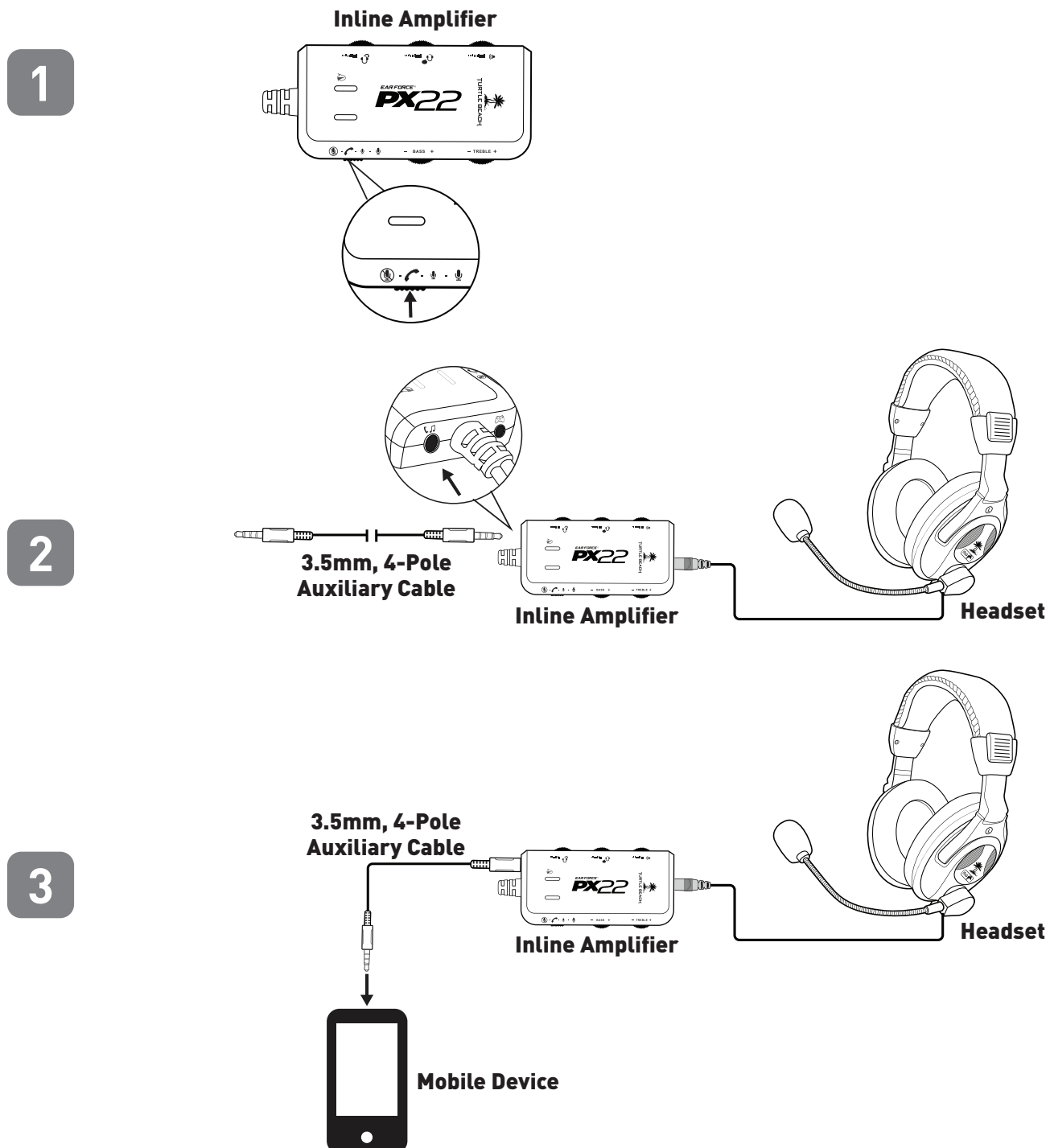

Specifications

- **Console Audio Connection:** RCA (analog)
- **PC/Mac Audio Connection:** USB and stereo 3.5mm
- **PC/PS3 Mic Connection:** USB
- **Xbox 360 Mic Connection:** 2.5mm talkback cable
- **Power:** USB

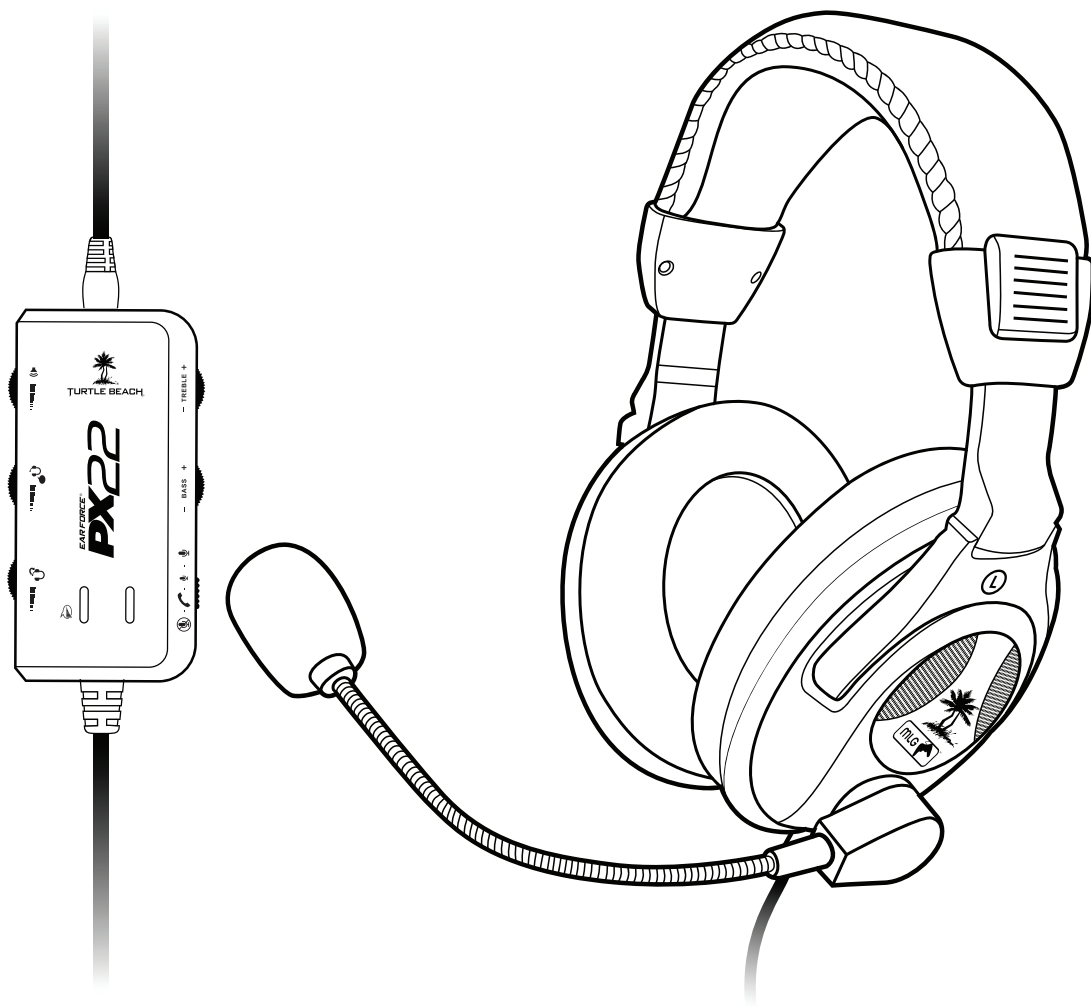

Regulatory Compliance Statements for the PX22 Models

Federal Communications Commission (FCC) Compliance Notices

Class B Interference Statement

This equipment has been tested and found to comply with the limits for a Class B digital device, pursuant to Part 15, Subpart B of the FCC Rules. These limits are designed to provide reasonable protection against harmful interference in a residential installation. This equipment generates, uses, and can radiate radio frequency energy and, if not installed and used in accordance with the instructions, may cause harmful interference to radio communications. However, there is no guarantee that interference will not occur in a particular installation. If this equipment does cause harmful interference to radio or television reception, which can be determined by turning the equipment off and on, the user is encouraged to try to correct the interference by one or more of the following measures:

- Reorient or relocate the receiving antenna.
- Increase the separation between the equipment and receiver.
- Connect the equipment into an outlet on a circuit different from that to which the receiver is connected.
- Consult the dealer or an experienced radio/TV technician for help.

FCC Caution:

This device complies with Part 15 of the FCC Rules. Operation is subject to the following two conditions: (1) This device may not cause harmful interference, and (2) this device must accept any interference received, including interference that may cause undesired operation.

Canadian ICES Statements

Canadian Department of Communications Radio Interference Regulations

This digital apparatus does not exceed the Class B limits for radio-noise emissions from a digital apparatus as set out in the Radio Interference Regulations of the Canadian Department of Communications. This Class B digital apparatus complies with Canadian ICES-003.

Règlement sur le brouillage radioélectrique du ministère des Communications

Cet appareil numérique respecte les limites de bruits radioélectriques visant les appareils numériques de classe A prescrites dans le Règlement sur le brouillage radioélectrique du ministère des Communications du Canada. Cet appareil numérique de la Classe B est conforme à la norme NMB-003 du Canada.

European Union and European Free Trade Association (EFTA) Regulatory Compliance

This equipment may be operated in the countries that comprise the member countries of the European Union and the European Free Trade Association. These countries, listed below, are referred to as The European Community throughout this document:

AUSTRIA, BELGIUM, BULGARIA, CYPRUS, CZECH REPUBLIC, DENMARK, ESTONIA, FINLAND, FRANCE, GERMANY, GREECE, HUNGARY, ICELAND, IRELAND, ITALY, LATVIA, LICHTEINSTEIN, LITHUANIA, LUXEMBOURG, MALTA, NETHERLANDS, NORWAY, POLAND, PORTUGAL, ROMANIA, SLOVAKIA, SLOVENIA, SPAIN, SWEDEN, SWITZERLAND, UNITED KINGDOM

Declaration of Conformity

Marking by this symbol: 

indicates compliance with the Essential Requirements of the EMC Directive of the European Union (2004/108/EC). This equipment meets the following conformance standards:

Safety: EN 60950-1: 2006 + A11 + A1 + A12 (T-Mark License)
Also Licensed for Standards:
EC 60950-1: 2005 + A1: 2009, (CB Scheme Report/Certificate),
UL60950-1 (NRTL License), CSA22.2, 60950-1 (SCC License)
Additional licenses issued for specific countries available on request

Emissions: EN 55022: 2010, EN 50332-1: 2000, EN50332-2: 2003
EN61000-3-2: 2006 +A1: 2009 +A2: 2009, EN61000-3-3: 2008
CISPR 22: 2010

Immunity: EN 55024: 2010, EN61000-4-2: 2008, EN61000-4-3: 2010,
EN61000-4-4: 2011, EN 61000-4-5: 2005, EN 610004-6: 2008,
EN61000-4-11: 2004

The products are licensed, as required, for additional country specific standards for the International Marketplace. Additional issued licenses available upon request.

Environmental: Low Voltage Directive 2006/95/EC,
RoHS 2002/95/EC
REACH 1907/2006/EC
WEEE 2002/96/EC

Warning!

This is a Class B product. In a domestic environment, this product may cause radio interference, in which case, the user may be required to take appropriate measures.

Achtung!

Dieses ist ein Gerät der Funkstörgrenzwertklasse B. In Wohnbereichen können bei Betrieb dieses Gerätes Rundfunkstörungen auftreten, in welchen Fällen der Benutzer für entsprechende Gegenmaßnahmen verantwortlich ist.

Attention!

Ceci est un produit de Classe B. Dans un environnement domestique, ce produit risque de créer des interférences radioélectriques, il appartiendra alors à l'utilisateur de prendre les mesures spécifiques appropriées.

LIMITED ONE YEAR WARRANTY FOR TURTLE BEACH PRODUCTS:

Voyetra Turtle Beach, Inc. ("VTB") warrants to the original end-user purchaser ("Purchaser") that the retail Turtle Beach hardware product herein ("Product") will be free of defects in materials and workmanship for a period of one year from the date of purchase by the Purchaser ("Warranty Period"). Any Extended Warranty or Service Plans purchased through a Retail store are not honored by VTB. The Warranty refers to the repair/replace-ment of a defective product during this period and not a refund.

This limited warranty is extended only to the original Purchaser of a new product, which was not sold "AS IS". It is not transferable or assignable to any subsequent purchaser. This limited warranty is applicable only in the country or territory where the Product was purchased from an authorized VTB retailer and does not apply to a Product that has been purchased as used or refurbished or was included as part of a non-VTB product.

WARRANTY SERVICE:

In the USA and CANADA Warranty Service is provided by our Turtle Beach USA offices and in all other Countries it is provided by our local International Distributors when available. Refurbished/Recertified products are sold on an AS IS basis with a 90-day Warranty or less in accordance with each ven-dor's policy.

VTB does not warrant uninterrupted or error-free operation of the Product and is under no obligation to support the Product for all computer operating systems or future versions of such operating systems.

If a defect should occur during the Warranty Period, Purchaser must contact VTB to obtain a Return Merchandise Authorization ("RMA") number on the basis of the dated purchase receipt. Purchaser will be responsible for shipping costs incurred in returning the defective Product to an authorized VTB service center, or to the repair facility located at VTB's corporate headquarters. VTB will not be responsible for other products or accessories included with the defective Product sent to VTB. The RMA number must be clearly indicated on the outside of the package. Packages without an RMA number will be refused by VTB or its representatives and returned to sender at the sender's expense.

In the event of a defect, Purchaser's sole and exclusive remedy, and VTB's sole liability, is expressly limited to the correction of the defect by adjust-ment, repair, or replacement of the Product at VTB's sole option and expense. VTB owns all Products it has replaced and all parts removed from repaired Products. VTB uses new and reconditioned parts made by various manufacturers in performing warranty repairs and building replacement products. If VTB repairs or replaces a product, the original Warranty Period is not extended, however, VTB warrants that repaired or replacement parts will be free from defects in material and workmanship for a period of thirty (30) days from the date of repair or replacement, or for the remainder of the Warranty Period, whichever is greater.

This warranty does not apply to any Product that has had its serial number altered, removed or defaced, or any Product damage caused by shipping, improper storage, accident, problems with electrical power, abuse, misuse, neglect, ordinary wear, acts of God (e.g. flood), failure to follow directions, improper maintenance, use not in accordance with product instructions, unauthorized modification or service of the Product or damage resulting from the use of the Product with hardware, software or other products not provided by or specifically recommended by VTB.

NOTES:

- Replacement Parts and accessories that are subject to "wear and tear" such as earpads, mic foam covers, talkback cables, etc. have a three (3) month Warranty.
- Replacement Parts for Discontinued Products are sold on an AS IS basis, they are not supported and come with a 30 day Warranty.

THIS LIMITED WARRANTY IS PURCHASER'S SOLE AND EXCLUSIVE REMEDY AND IS IN LIEU OF ALL OTHER WARRANTIES, EXPRESS OR IMPLIED. TO THE EXTENT PERMITTED BY APPLICABLE LAW, VTB HEREBY DISCLAIMS THE APPLICABILITY OF ANY IMPLIED WARRANTY OF MERCHANTABILITY, FITNESS FOR A PARTICULAR PURPOSE OR USE FOR THE PRODUCT. IF SUCH A DISCLAIMER IS PROHIBITED BY APPLICABLE LAW, THE IMPLIED WARRANTY IS LIMITED TO THE DURATION OF THE FOREGOING LIMITED WRITTEN WARRANTY.

IN NO EVENT SHALL VTB BE LIABLE FOR ANY INDIRECT, INCIDENTAL, SPECIAL, PUNITIVE OR CONSEQUENTIAL DAMAGES, OR DAMAGES, INCLUDING BUT NOT LIMITED TO ANY LOST PROFITS, DATA, OR LOSS OF USE, ANY THIRD PARTY CLAIMS, AND ANY INJURY TO PROPERTY OR BODILY INJURY (INCLUD-ING DEATH) TO ANY PERSON, ARISING FROM OR RELATING TO THE USE OF THIS PRODUCT OR ARISING FROM BREACH OF THE WARRANTY, BREACH OF CONTRACT, NEGLIGENCE, TORT, OR STRICT LIABILITY, EVEN IF VTB HAS BEEN ADVISED OF THE POSSIBILITY OF SUCH DAMAGES.

This warranty supersedes all prior agreements or understandings, oral or written, relating to the Product, and no representation, promise or condi-tion not contained herein will modify these terms. Some states do not allow the exclusion or limitation of incidental or consequential damages, so the above exclusion or limitation may not apply to you. This warranty gives you specific legal rights. You may also have other rights, which vary from state to state. Any action or lawsuit for breach of warranty must be commenced within eighteen (18) months following the purchase of the Product.

This Limited Warranty shall not apply and VTB has no liability under this Limited Warranty if the Turtle Beach Product:

- is used for commercial purposes such as "LAN, Call Centers" (including rental or lease);
- is modified or tampered with;
- is damaged by Acts of God, power surge, misuse, abuse, negligence, accident, wear and tear, mishandling, misapplication, or other causes unrelated to defective materials or workmanship;
- serial number is defaced, altered or removed;
- is not used in accordance with the documentation and use instructions; or
- is repaired, modified or altered by other than authorized repair centers.
- is no longer available because it was discarded.



**For: PS3™ | Xbox 360® | PC
Mac® | Mobile**



Watch Turtle Beach product training videos at:

youtube.com/TurtleBeachVideos



Product support and warranty information:

TurtleBeach.com/support

Copyright © 2013 Voyetra Turtle Beach, Inc. (VTB, Inc.) All rights reserved. Turtle Beach, the Turtle Beach Logo, Voyetra, and Ear Force are either trademarks or registered trademarks of VTB, Inc. Xbox, Xbox 360, and Xbox LIVE are registered trademarks of Microsoft Corporation. PlayStation is a registered trademark and PS3 is a trademark of Sony Computer Entertainment, Inc. Mac is a registered trademark of Apple, Inc. All other trademarks are properties of their respective companies and are hereby acknowledged. Actual product appearance may differ from package imagery. Made in China.

This product is compliant with the Consumer Product Safety Improvement Act of 2008, Public Law 110-314 (CPSIA)