

PRO-ELEC

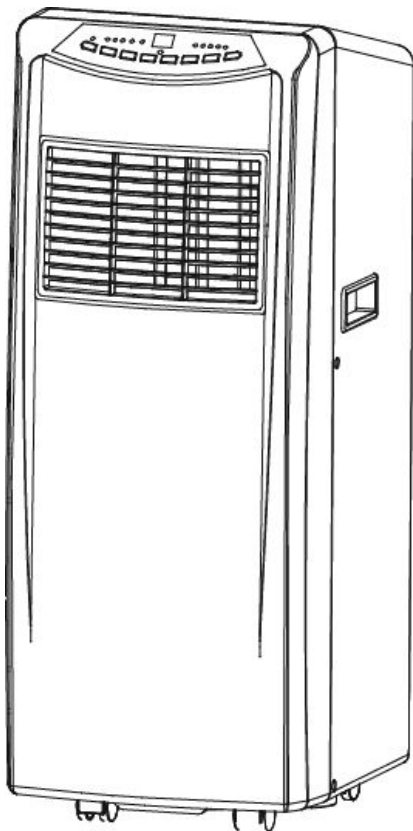

PORTABLE AIR CONDITIONER

Model: PEL00461

CONTENTS

Page No.	Details
3	Important Safety Information
4	Introduction
4	Positioning
4	Installation
5	Control Panel
6	Remote Control
6	Operation Modes
7	Water Drainage
7	Maintenance
8	Troubleshooting
8	Cleaning

IMPORTANT SAFETY INFORMATION

Please read these instructions carefully before use and retain for future reference.

- When using electrical appliances basic safety precautions should always be followed.
- Check that the voltage indicated on the rating plate corresponds with that of the local network before connecting the appliance to the mains power supply.
- This appliance is intended for domestic use only. It should not be used for commercial purposes.
- This appliance is designed for indoor use only.
- This appliance can be used by children from aged 8 years and above and persons with reduced physical, sensory, or mental capabilities or a lack of experience and knowledge if they have been given supervision or instruction concerning use of the appliance in a safe way and understand the hazards involved.
- Children shall not play with the appliance.
- Cleaning and maintenance shall not be made by children without supervision.
- There are no user-serviceable parts in this product. Refer servicing to qualified personnel.
- Do not operate this appliance with a damaged plug or cord, after a malfunction or after being dropped or damaged in any way.
- If the supply cord is damaged, it must be replaced by the manufacturer, its service agent or similarly qualified persons in order to avoid a hazard
- Do not insert anything through the air outlet grille when the air conditioner is connected to the supply.
- Make sure that the air conditioner is on a stable surface when operating.
- Disconnect from the supply when not in use, or during maintenance or cleaning.
- For the remote control, only use the batteries recommended (2 x AAA, *not provided*).
- Ensure that the batteries are inserted correctly, observing the plus and minus marks on both the batteries and the compartment.
- Fit a full set of batteries at one time.
- Remove dead batteries from the remote control, or if it is not going to be used for a long period of time.
- Never mix old and new batteries together, or different types of batteries.
- Never dispose of batteries in a fire, or attempt to recharge ordinary batteries.

INTRODUCTION

Front	
1	Control panel
2	Air-outlet
3	Power button
4	Handle
5	Castor

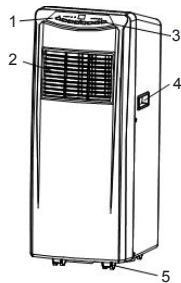

Back	
6	Filter frame upper
7	Exhaust connector
8	Filter frame lower
9	Rubber plug
10	Plug cap
11	Power cord

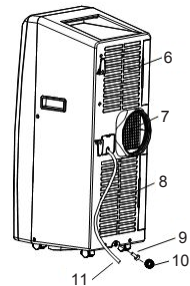

Accessories	
12	Exhaust hose
13	Adjustable window guide
14	Exhaust hose adapter
15	Remote control

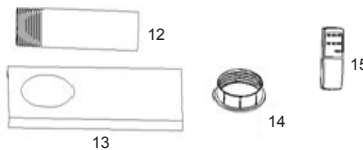

POSITIONING

- The air conditioner must stand upright on a flat surface.
- Do not position near a bath, shower, sink or other permanently damp or wet areas.
- Place the air conditioner at least 50cm away from any wall, curtains or heat sources to ensure adequate air circulation (Fig.1).
- Ensure that the mains socket outlet remains accessible when the air conditioner is in use.
- Ensure that there is free access to the air-inlet and air-outlet vents.

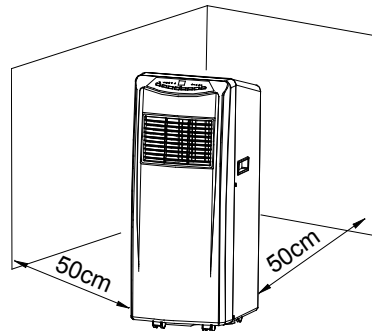

Fig.1

INSTALLATION

- Screw the exhaust hose onto the exhaust hose adapter, turning the hose anti-clockwise.
- Screw the exhaust hose onto the exhaust connector on the rear of the air conditioner, turning anti-clockwise (Fig.2).
- Adjust the length of the window guide to fit the width of your window. The length of the guide is adjustable. If it is too long it can be cut to size.
- Fit the exhaust hose adapter into the window guide.
- Close the window onto the window guide so that is securely held in place.

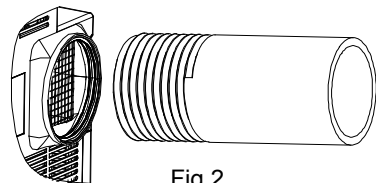

Fig.2

Installation Errors

- In order to operate efficiently, the air must be able to flow freely in the exhaust pipe.
- Avoid any sharp bends in the exhaust pipe (Fig.3).
- Keep it as level as possible.
- Keep its length as short as possible. The maximum extension length of the exhaust pipe is 1.5m. Do not try to lengthen it.

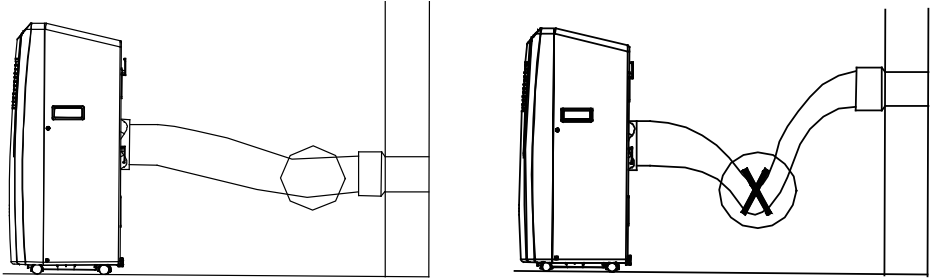
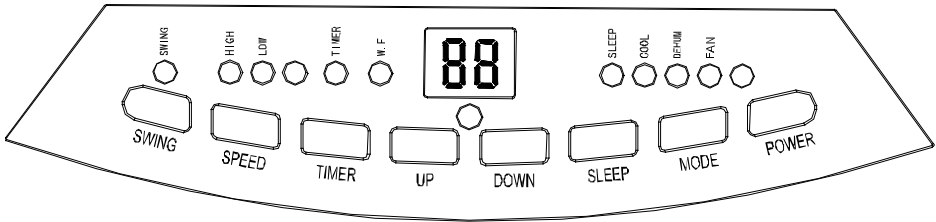

Fig. 3

CONTROL PANEL



POWER	Press to turn the air conditioner on or off. When it turns on, it will do so in the default mode of cooling with low fan speed.
MODE	Press to select cooling, dehumidifying and fan mode.
SPEED	Press to select fan speed (high or low).
DOWN	In cooling mode, press to reduce the temperature. <i>Note: Temperature range is 16°C to 31°C.</i>
UP	In cooling mode, press to increase temperature. <i>Note: Temperature range is 16°C to 31°C.</i>
SLEEP	In cooling mode, press to turn on/off the sleep mode function.
TIMER	In power-on or standby mode, press to set up on/off delay time from 1 to 24 hours.
SWING	Press once and the louvre will swing continuously left and right. Press the button again and the louvre will stop moving.

REMOTE CONTROL

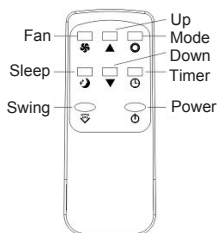

OPERATION MODES

Cooling Mode

- After the air conditioner turns on, the default setting is cooling mode with a temperature of 22°C and low fan speed.
- Press **MODE** to select cooling mode and the cooling mode indicator turns on.
- Press **UP** or **DOWN** to adjust temperature from 16°C to 31°C.
- Press **FAN** to select high or low fan speed.

Fan Mode

- Press **MODE** to select fan mode and the fan mode indicator turns on.
 - Press **FAN** to select high speed or low speed.
- Note: When in fan mode, the temperature and sleep function cannot be set.

Timer Mode

- In standby mode, press **TIMER** to set the number of hours to when the unit turns on. The timer mode indicator turns on. The length of time is adjustable from 1 to 24 hours.
- In power-on mode, press **TIMER** to set the number of hours to when the unit goes into standby mode. The timer mode indicator turns on. The length of time is adjustable from 1 to 24 hours.

Dehumidifying Mode

- Press **MODE** to select dehumidifying mode and the dehumidifying indicator turns on.
- Note: In dehumidifying mode, the sleep function cannot be set up and the fan speed is low.

Sleep Mode

- Press **SLEEP** to enter into sleep mode; the default value of the fan speed is low.
 - When sleep mode turns on, in cooling mode, after the first hour the temperature setting will increase by 1°C. After the second hour, the temperature will go up a further 1°C and then remain the same.
- Note: Sleep mode is not available in dehumidifying and fan mode.

Compressor Protection

After powering on, or a restart, there is a three minute delay before the compressor starts to operate. This helps to prolong the life of the compressor.

WATER DRAINAGE

The air conditioner has an internal water tank to collect water that condenses during the cooling process. This tank will need to be emptied periodically.

When the internal water tank is full, the WATER FULL indicator will flash on the screen and a buzzer will sound.

The air conditioner will go into standby mode, the compressor will stop and all the key functions will be disabled.

The water tank will need to be emptied before normal operation can be resumed:

- Unplug the air conditioner from the mains supply.
- Under the drainage plug on the rear of the unit, place a shallow container to collect the water. Use this only for temporary drainage of the unit. Do not allow the water to drop continuously into the container, as it will overflow.
- Remove the plug cap and the drainage plug to empty the tank.
- When the tank is empty, refit the drainage plug and cap.
- Reconnect the air conditioner to the mains supply and press the **POWER** button, on either the front panel or remote control. The air conditioner will restart and operate normally.

MAINTENANCE

IMPORTANT: In order to avoid an electric shock, power-off the air conditioner and disconnect the mains plug before performing any cleaning or maintenance.

Cleaning

- Unplug from the mains supply before cleaning.
- Do not splash water into the air conditioner.
- Clean the outside of the air conditioner with a damp cloth, then dry it thoroughly before using.
- Do not use any chemicals, abrasives or solvents that could damage the air conditioner.

Filters

- Clean the filters every two weeks. If the filters become blocked with dust, the efficiency of the air conditioner will be reduced.
- Remove the air filters on the rear of the unit.
- Run a vacuum cleaner lightly over the surface of the filters to remove any dust. If the filters are exceptionally dirty, wash them in warm water and a mild detergent and allow to dry thoroughly before refitting.

Note: Do not operate the air conditioner without filters.

Seasonal Cleaning

If the air conditioner is not going to be used for a long time, follow the below steps:

- Unplug the air conditioner from the mains.
- Remove the drainage plug and empty the internal water tank.
- Plug the air conditioner into the mains and turn the power on. Select 'fan' mode and run for two hours to allow the air conditioner to dry out.
- Turn off and unplug from the mains.
- Clean and dry the filters and reinstall them.
- Put the air conditioner back in the original carton and store in a dry, cool place.

TROUBLESHOOTING

Trouble	Cause	Solution
Machine does not work.	<ul style="list-style-type: none"> • Power off. • Water-full indicator is on. • Timer function is active. 	<ul style="list-style-type: none"> • Power on. • Drain internal water tank. • Deactivate TIMER function.
Machine auto-restarts frequently.	<ul style="list-style-type: none"> • The unit is in direct sunlight. • Doors and windows are open, or other heat sources are in the room. • Filters are too dirty. • Air-inlet/air-outlet is blocked. 	<ul style="list-style-type: none"> • Reposition the air conditioner. • Close the door and windows and remove other heat sources. • Clean or replace filters. • Remove blockage.
Too noisy.	<ul style="list-style-type: none"> • Machine is not on a level surface. 	<ul style="list-style-type: none"> • Place it on a flat, solid floor to avoid vibration.
Compressor does not work.	<ul style="list-style-type: none"> • Compressor time-delay protection is on. 	<ul style="list-style-type: none"> • Wait for 3 minutes, then restart the air conditioner.
Remote control does not work.	<ul style="list-style-type: none"> • Distance too great. • Remote control signal not detected by control panel. • The batteries are drained. 	<ul style="list-style-type: none"> • Make sure that the remote control is correctly aimed at the control panel. • Replace the batteries.

SPECIFICATIONS

Main voltage	220-240V~50Hz	Global warming potential	1975 kgCO ₂ eq.
Rated input power	1340W	Efficiency ratio (EER)	2.62
Power in standby	1.0W	Efficiency class	A
Cooling capacity	3.53kW (12,000BTU/h)	Fan speeds	2
Dehumidifying capacity	50L/24hr	Thermostat	16-31°C
Air flow	380m ³ /hr	Max. extension length of exhaust hose	1.5m
Sound power level	65dB (A)	Recommended floor area	16-22m ²
Charge	R410A/520g	Dimensions (WxHxD) Weight	325x830x370mm 27kg



INFORMATION ON WASTE DISPOSAL FOR CONSUMERS OF ELECTRICAL & ELECTRONIC EQUIPMENT.

When this product has reached the end of its life it must be treated as Waste Electrical & Electronic Equipment (WEEE). Any WEEE marked products must not be mixed with general household waste, but kept separate for the treatment, recovery and recycling of the materials used. Contact your local authority for details of recycling schemes in your area.

