

N 50
B6ACH7HN0B
SINGLE OVEN



COOKING PASSION SINCE 1877



A

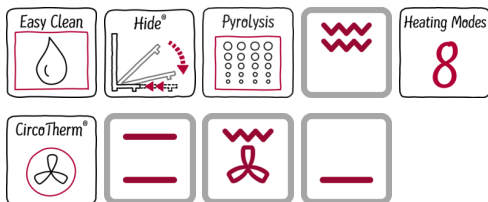

Built-in oven with CircoTherm® - The award-winning hot air system from Neff

- ✓ Slide&Hide® the fully retracting oven door, unrestricted access with fixed handle.
- ✓ CircoTherm® - the unique hot air-system for simultaneous baking and roasting on up to 3 levels
- ✓ Dual cleaning options:
- ✓ Pyrolytic following heavy use - just let the oven interior clean itself.
- ✓ EasyClean® - the quick and easy option for day to day maintenance.
- ✓ Clip-on Rail - easily removed and installed telescopic rails for flexible use on all shelf levels

Features

Technical Data

Color / Material Front : Stainless steel
Construction type : Built-in
Integrated Cleaning system : Hydrolytic, Pyrolytic
Required niche size for installation (HxWxD) : 585-595 x 560-568 x 550
Dimensions of the product (mm) : 595 x 594 x 548
Dimensions of the packed product (HxWxD) (mm) : 670 x 700 x 660
Control Panel Material : Glass
Door Material : Glass
Net weight (kg) : 39.8
Usable volume of cavity (l) : 71
Cooking method : Bottom heat, Bread Baking Setting, Conventional heat, Full width grill, Heißluft sanft, Hot Air, Hot air grilling, Pizza setting
First cavity material : Other
Temperature control : No control of the temperature
Number of interior lights : 1
Approval certificates : CE, VDE
Length of electrical supply cord (cm) : 120
EAN code : 4242004225256
Number of cavities (2010/30/EC) : 1
Energy efficiency class (2010/30/EC) : A
Energy consumption per cycle conventional (2010/30/EC) : 1.04
Energy consumption per cycle forced air convection (2010/30/EC) : 0.81
Energy efficiency index (2010/30/EC) : 95.3
Electrical connection rating (W) : 2990
Current (A) : 13
Voltage (V) : 220-240
Frequency (Hz) : 60; 50
Plug type : no plug

Included accessories

2 x combination grid, 1 x universal pan

Optional accessories

Z11TI15X0 Cliprails



4 242004 225256

N 50
B6ACH7HN0B
SINGLE OVEN

Features

Design

- LCD-Display Control (white)
- Retractable control dials, Bevelled oval controls
- Cavity inner surface: Enamel grey
- Slide&Hide® with fixed handle
- Bar handle

Features

- Door lock during pyrolytic cleaning
Control panel lock
Automatic safety switch off
Residual heat indicator
- Temperature proposal
Actual temperature display
Heating up indicator
Sabbath setting
- Interior halogen light
- Quadruple glazed door

Cleaning

- Pyrolytic cleaning
- EasyClean
- Full glass inner door

Programmes/functions

- 8 heating methods: CircoTherm®, Top/bottom heat, Hot air grilling, Full surface grill, CircoTherm® intensive, Bread baking, Bottom heat, CircoTherm® gentle
- Rapid heat
- Cooling fan

Accessories

- 1 Clip rail, Stop function
- 2 x combination grid, 1 x universal pan

Performance/technical information

- Energy efficiency rating (acc. EU Nr. 65/2014): A
Energy consumption per cycle in conventional mode: 1.04 kWh
Energy consumption per cycle in fan-forced convection mode: 0.81 kWh
Number of cavities: Main cavity
Heat source: electrical
Cavity volume: 71 litre
- Total connected load electric: 2.99 KW
- Temperature range 30 °C - 275 °C
- Length of mains cable: 120 cm
- Nominal voltage: 220 - 240 V
- Appliance dimension (h x w x d): 595 mm x 594 mm x 548 mm
- Niche dimension (h x w x d): 585 mm - 595 mm x 560 mm - 568 mm x 550 mm
- Please refer to the dimensions provided in the installation manual

N 50
B6ACH7HN0B
SINGLE OVEN

Dimensioned drawings

If the appliance will be installed underneath a hob, the following worktop thicknesses (including substructure if necessary) must be taken into account.

Hob type	min. worktop thickness	
	fitted	flush
Induction hob	37 mm	38 mm
Full surface Induction hob	47 mm	48 mm
Gas hob	30 mm	38 mm
Electric hob	27 mm	30 mm

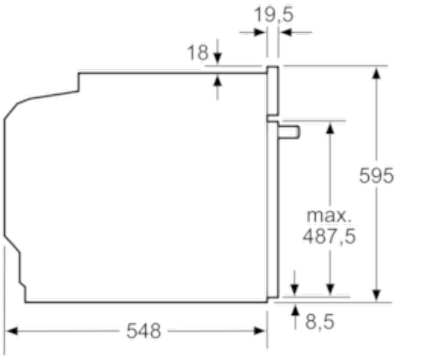

measurements in mm

Installation with a hob.

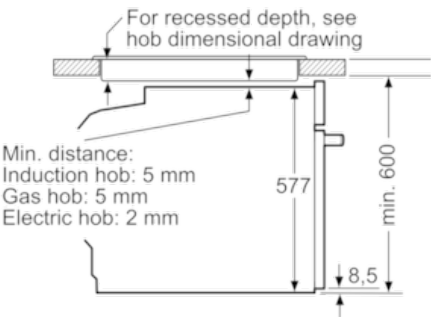

measurements in mm

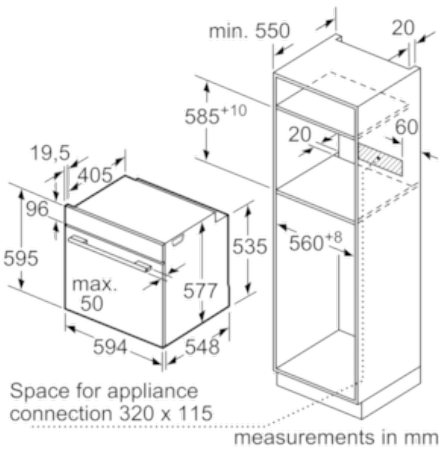

measurements in mm

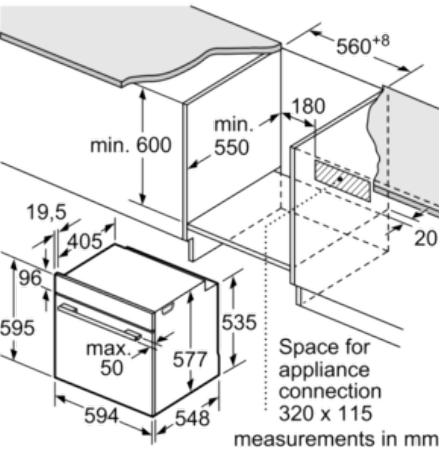

measurements in mm