



OWNER'S MANUAL

REFRIGERATOR- FREEZER

Please read this owner's manual thoroughly before operating and keep it handy for reference at all times.



MFL67783530

www.lg.com

Electrical Connections (In the UK Only)

Important

The wires in this mains lead are coloured in accordance with the following code:

GREEN AND YELLOW: EARTH
BLUE: NEUTRAL
BROWN: LIVE

This appliance must be earthed

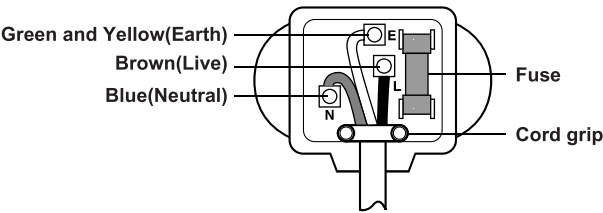

As the colours of the wires in the mains lead of this apparatus may not correspond with the coloured markings identifying the terminals in your plug, proceed as follows:

The wire which is coloured Green and Yellow must be connected to the terminal in the plug which is marked with the letter E or by the earth symbol(\equiv) or coloured Green or Green and Yellow.

The wire which is coloured Blue must be connected to the terminal which is marked with the letter N or coloured Black.

The wire which is coloured Brown must be connected to the terminal which is marked with the letter L or coloured Red.

If a 13 amp(BS 1363) plug is used, fit a 13 amp BS 1362 fuse.

Registration

The model and serial number are found on the rear of this unit. This number is unique to this unit and not available to others. You should record requested information here and retain this guide as a permanent record of your purchase. Staple your receipt here.

Date of Purchase : _____

Dealer Purchased From : _____

Dealer Address : _____

Dealer Phone No. : _____

Model No. : _____

Serial No. : _____

Table of Contents

Introduction	Important Safety Instruction	4
	Installation	8
	Identification of Parts	9
Operation	Starting	10
	Temperature Control	11
	Express Freeze	12
	Eco Friendly	13
	Self Test	13
	Door Alarm	13
	Lock	13
	On/Off	13
	Ice Making	14
	Defrosting	14
	Water Dispenser (Optional)	14
	Freezer Compartment	15
	Sliding Shelf (Optional)	15
	Pull Out Tray (Optional)	16
	Lamp Replacement	17
Suggestion On Food storage	Storing Food	18
	Suggestion For Energy Saving	18
Care and Maintenance	General Information	19
	Cleaning	20
	Smart Diagnosis™	21
	Trouble Shooting	22
	It is normal...	24

Important Safety Instructions

Basic Safety Precautions

This guide contains many important safety messages. Always read and obey all safety messages.

This is the safety alert symbol. It alerts you to safety messages that inform you of hazards that can kill or hurt you or others or cause damage to the product. All safety messages will be preceded by the safety alert symbol and the hazard signal word **DANGER**, **WARNING**, or **CAUTION**. These words mean:



You will be killed or seriously injured if you don't follow instructions.



You can be killed or seriously injured if you don't follow instructions.



Indicates an imminently hazardous situation which, if not avoided, may result in minor or moderate injury, or product damage only.

All safety messages will identify the hazard, tell you how to reduce the chance of injury, and tell you what can happen if the instructions are not followed.

WARNING

Before it is used, this refrigerator must be properly installed and located in accordance with the installation instructions in this document. This Refrigerator is intended for Domestic indoor use only.

Never unplug your refrigerator by pulling on the power cord. Always grip plug firmly and pull it straight out from the outlet.

When moving your appliance away from the wall, be careful not to roll over the power cord or to damage it in any way.

After your refrigerator is in operation, do not touch the cold surfaces in the freezer compartment, particularly when your hands are damp or wet. Skin could adhere to these extremely cold surfaces.

Unplug the power cord from the power outlet for cleaning or other maintenance. Never touch the appliance with wet hands as you may receive an electric shock or injure yourself.

Never damage, press, severely bend, pull or twist the power cord as damage to the cord may cause a fire or electric shock. Never touch the cord if you are uncertain if the appliance is correctly earthed.

The fuse on the refrigerator must be changed by a qualified technician or service company.

- Failing to do so may result in electric shock or personal injury.

Never place glass items in the freezer as they may break due to expansion of their contents on freezing.

Never put your hands into the storage bin of the automatic ice maker as you could be injured during its operation.

Never allow anyone to climb, sit, stand or hang on the refreshment centre door. These actions may damage the refrigerator and even tip it over, causing severe personal injury.

It is advised that this appliance should be connected through an independent power socket to prevent it and other appliances from overloading the circuit and causing a power outage.

The appliance should be positioned so that the supply plug is easily accessible for quick disconnection should an accident occur. If the supply cord is damaged, it must be replaced by the manufacturer or its service agent or a similarly qualified person in order to avoid a hazard.

WARNING

Do not modify or extend the Power Cord length. It may cause electric shock or fire.

Connect the power plug in proper position with the cord hanging down.

- If you connect the power plug upside down, wire can get cut off and cause fire or electric shock.

Make sure that the power plug is not squashed or damaged by the back of the refrigerator.

DANGER : Risk of child entrapment.

Before you dispose of your old refrigerator please remove doors but leave the shelves in place so that children cannot climb inside.

This appliance can be used by children aged from 8 years and above and persons with reduced physical, sensory or mental capabilities or lack of experience and knowledge if they have been given supervision or instruction concerning use of the appliance in a safe way and understand the hazards involved.

Children shall not play with the appliance.

Cleaning and user maintenance shall not be made by children without supervision.

⚠ Do not store or use gasoline or other flammable vapour and liquids in the vicinity of this or any other appliance.

⚠ In the event of an electric short circuit, grounding (earthing) reduces the risk of electric shock by providing an escape wire for the electric current.

In order to prevent possible electric shock this appliance must be earthed. Improper connection of the earthing plug can cause electric shock. Consult a qualified electrician or service engineer if the earthing instructions are not

completely understood, or if you have doubts as to whether the appliance is properly earthed.

Do not move refrigerator while the refrigerator is operating. Compressor may occur a temporary rattling noise.

(This is normal and will not impact on the performance or the life of the compressor. The rattling will stop after the refrigerator comes to a rest.)

Fill with potable water only.

If LED lamp is damaged, it should be replaced by the service center instead of your own.

Appliance Usage Range

This appliance is intended to be used in household and similar applications such as:

- staff kitchen areas in shops, offices and other working environments;
- farm houses and by clients in hotels, motels and other residential type environments;
- bed and breakfast type environments;
- catering and similar non-retail applications

⚠ WARNING

- Keep ventilation openings in the room where the appliance is installed clear of obstruction.
- Do not use mechanical devices or other means to accelerate the defrosting process, other than those recommended by the manufacturer.
- Do not damage the refrigerant circuit.
- Do not use electrical appliances inside the food storage compartments of the appliance, unless they are of the type recommended by the manufacturer.
- Disposal procedures. If disposing of this appliance, please consult with a service agent or a similarly qualified person for more details.
- Do not store explosive substances such as aerosol cans with a flammable propellant in this appliance.

⚠ WARNING

- Do not use aerosols near the refrigerator.
 - Aerosols used near the refrigerator may cause an explosion or fire.



This appliance contains a small amount of isobutane refrigerant (R600a), natural gas with high environmental compatibility, but it is also combustible. When transporting and installing the appliance, care should be taken to ensure that no parts of the refrigerating circuit are damaged. Refrigerant squirting out of the pipes could ignite or cause an eye injury. If a leak is detected, avoid any naked flames or potential sources of ignition and air the room in which the appliance is standing for several minutes.

In order to avoid the creation of a flammable gas air mixture if a leak in the refrigerating circuit occurs, the size of the room in which the appliance may be sited depends on the amount of refrigerant used. The room must be 1m² in size for every 8g of R600a refrigerant inside the appliance. The amount of refrigerant in your particular appliance is shown on the identification plate inside the appliance. Never start up an appliance showing any signs of damage. If in doubt, consult your dealer.

Installation

1. Select a good location. Place your fridge-freezer where it is easy to use.
2. Avoid placing the unit near heat sources, direct sunlight or moisture.
3. To ensure proper air circulation around the fridge-freezer, please maintain sufficient space on both the sides as well as top and maintain at least 2inches(5cm) from the rear wall.
4. To avoid vibration, the unit must be leveled. If required, adjust the leveling screws to compensate for the uneven floor. The front should be slightly higher than the rear to aid in door closing. Leveling screws can be turned easily by tipping the cabinet slightly. Turn the leveling screws counterclockwise (↺) to raise the unit, clockwise (↻) to lower it.
5. Clean your fridge-freezer thoroughly and wipe off all dust accumulated during shipping.
6. Install accessories such as ice cube box, etc., in their proper places. They are packed together to prevent possible damage during shipment.
7. Connect the power supply cord (or plug) to the outlet. Don't double up with other appliances on the same outlet.

Identification of Parts

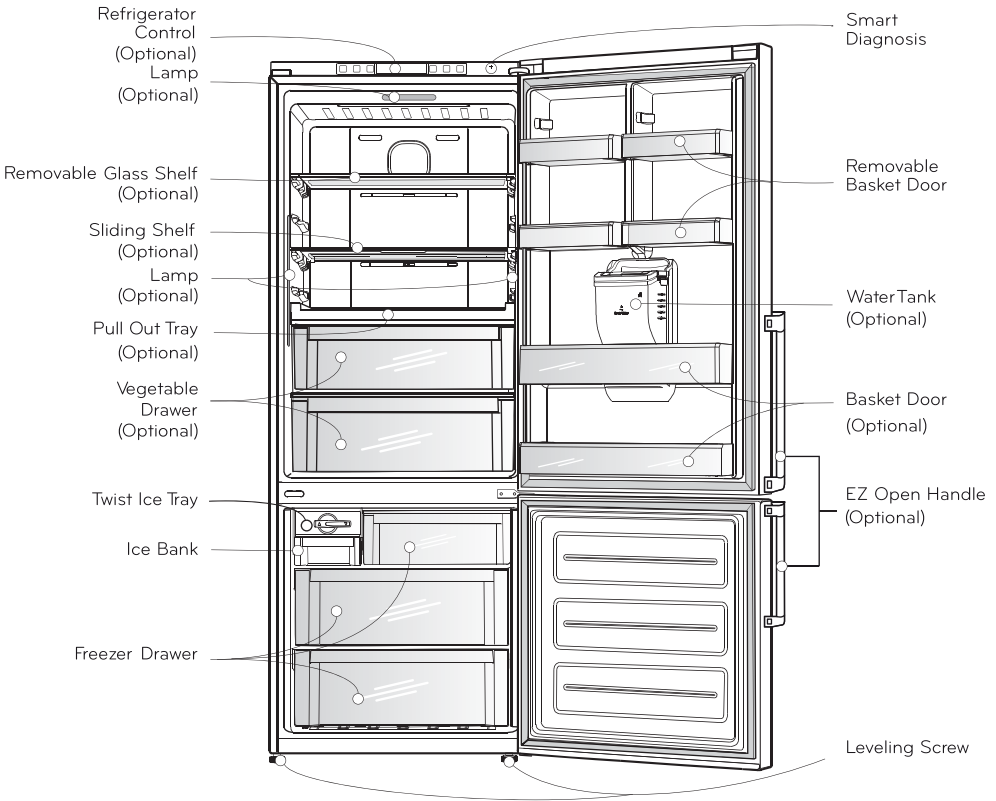

Note

If you find some parts missing from your unit, they may be parts only used in other models.

Starting

When your fridge-freezer is installed, allow it 2-3 hours to stabilize at normal operating temperature prior to filling it with fresh or frozen foods. If power plug is disconnected, allow 5 minutes delay before restarting. Your fridge-freezer is now ready for use.

Note

Do not move refrigerator while the refrigerator is operating.

Compressor may occur a temporary rattling noise. (This is normal and will not impact on the performance or the life of the compressor. The rattling will stop after the refrigerator comes to a rest.)

Climate class

The appliance is designed to operate at the limited range of ambient temperature, depending on climate zones. Do not use the appliance at the temperature out of the limit. Climate class of your appliance is indicated on the label with technical description inside the fridge compartment.

Class	Symbol	Ambient temperature range °C
Extended temperate	SN	+10 ~ +32
Temperate	N	+16 ~ +32
Subtropical	ST	+16 ~ +38
Tropical	T	+16 ~ +43

Temperature Control

Your refrigerator has controls that let you regulate the temperature in the refrigerator and freezer compartments.

Display Panel For Temperature Control

Adjusting the temperatures and functions

< Exterior Type >

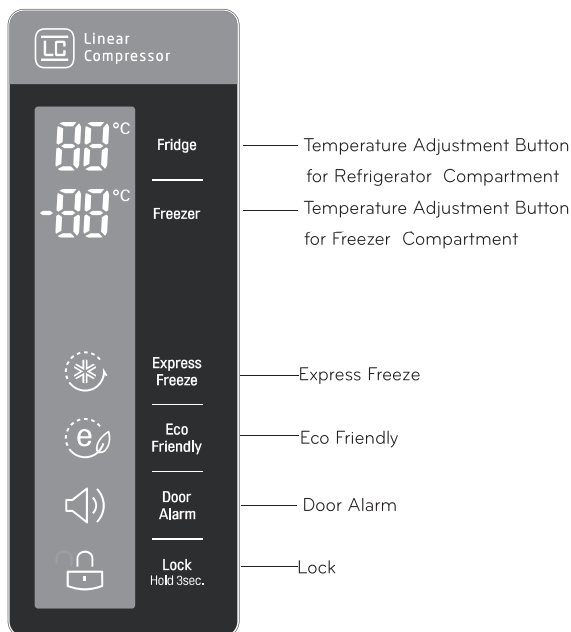

< Interior Type >

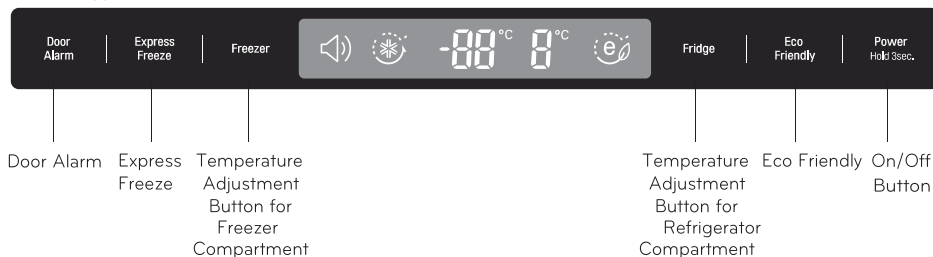

Note

See detailed button description on page 12~13

How to adjust the temperature in the refrigerator and freezer compartment

The initial target temperature of the refrigerator and freezer Compartment is 3°C and -20°C respectively.

You can now adjust the target temperature of the compartments as you wish.

< Exterior Type >



< Interior Type >



Refrigerator

When the button is pressed, the temperature of the refrigerator is 3°C ► 2°C ► 1°C ► 7°C ► 6°C ► 5°C ► 4°C ► 3°C sequentially.

Freezer

When the button is pressed, the temperature of the freezer is -20°C ► -21°C ► -22°C ► -23°C ► -15°C ► -16°C ► -17°C ► -18°C ► -19°C ► -20°C sequentially.

Note

The actual inner temperature varies depending on the food status, as the indicated setting temperature is a target temperature, not actual temperature within refrigerator. Refrigeration temperature stability may fluctuate initially. Please adjust temperature as above after using refrigerator for minimum 2~3 days.

Express Freeze

- Select this function for prompt freezing.
- This function is used when you want to freeze the foods quickly. Press the Express Freeze button once, and then the quick freeze operation starts and the Express Freezing lamp will be on.
- The Express Freeze operation takes about 24 hrs. When its operation ends, it automatically returns to the previous temperature setting. If you want to stop the quick freeze operation manually, press the Express Freeze button once more, the lamp goes out, and the Express Freeze operation stops and the refrigerator returns to the previous temperature setting.

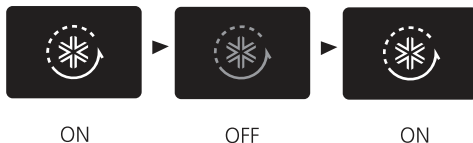

- The Express Freeze indicator remains on after the Express Freeze function is selected.

Eco Friendly

- This function makes the refrigerator work in a power saving mode which is useful for when you are away on holiday, by reducing energy consumption.
- Pressing 'ECO FRIENDLY' starts the operation and turns the lamp on and pressing it again stops the operation.

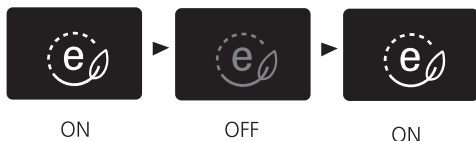

Note

When the Eco Friendly mode is "ON", the Refrigerator, Freezer temperature buttons and Express Freezing function will not operate. To cancel the Eco Friendly mode, press the Eco Friendly button off so that the other buttons work and the refrigerator returns to the previous temperature setting.

Self Test

- This function automatically detects certain malfunctions when the refrigerator is in use.
- When a malfunction occurs, the temperature display locks out and cannot be changed. Do not turn off the power. Call your nearest service provider so that they can diagnose the display indicators. If the power is turned off the error message will be reset and may be difficult to properly diagnose.

Door Alarm

- When the doors of the refrigerator are opened for longer than 1 minute, the alarm sounds repeatedly every 30 seconds until the door is closed. Please contact with the local service center if the alarm continues to sound even after closing the door.
- The door alarm can be muted by pressing the Alarm button.



Lock

< Exterior Type >

- Pressing this button stops the operation of other buttons.
- "Locking" or "Un-Locking" is repeated whenever pressing the LOCK button. (For "Locking" press the "LOCK" button for 3 secs. For "Un-Locking" press the "LOCK" button for 3 secs.)
- When 'LOCK' is activated, all other buttons will not respond. The lock function does not stop the water dispensing operation on models fitted with a water dispenser.

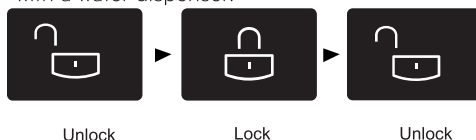

On/Off

< Interior Type >

- Pressing this button turns the refrigerator power ON or OFF. In the OFF mode, the unit will stop cooling and the interior lights will not turn on when the door is opened.
- ON or OFF is repeated whenever pressing the ON/OFF button. (For "OFF" press the "ON/OFF" button for 3~7 secs. For "ON" press the "ON/OFF" button for 3 secs.)

Note

This button does not isolate the mains power from the refrigerator.

Ice Making

- Take out the twist ice maker, fill it up and put it back to its original location.

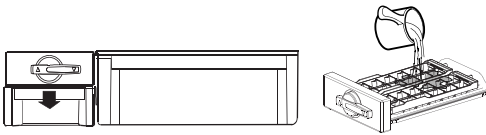

- Ice is dropped into the ice storage bin by rotating the ice separation handle on the ice making compartment.



- You can make ice or use this space as a storage space for Frozen food. Removing (1) (Twist ice maker) as shown in the picture.

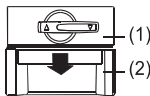

Note

- Rotating the ice separation handle before ice is fully frozen may cause the remaining water to drop into the ice storage bin and lump the ice together.
- Never pour water into the ice storage bin for the intention of freezing it as it can break the ice storage bin.
- When the ice storage bin is full, it is designed for the ice to fall to the bottom in case it is overfilled. Be careful not to overfill the storage bin.
- Gently remove the ice storage bin when accessing ice so that the slide stopper is not broken.

Water Dispenser (Optional)

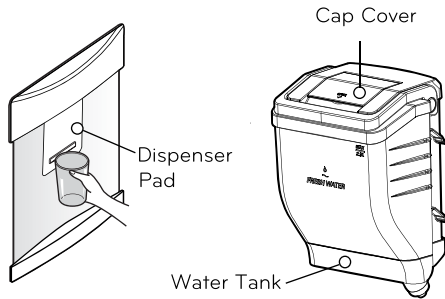

Filling of Water Tank

How to Remove the Water Tank

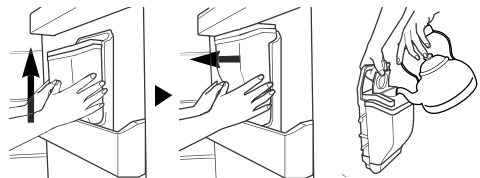

- Refitting is done in reverse to removal.
- Be careful not to press on the dispensing valve.
- When refitting the tank to the door, ensure that it is properly secured in its place.

- Pull out the water tank. Then open the cap cover.
- Up to 2.3 liters of water can be added.
- Only fill with drinkable water. Never fill with any other liquid other than water. Never pour hot water into the tank.

Defrosting

- Defrosting takes place automatically.
- The defrosting water flows down to the evaporating tray and is evaporated automatically.

Drinking

- Press the dispenser pad with a cup or glass.
- Water will be dispensed for as long as the pad is pressed.
- To minimise any spillage, slowly remove the cup or glass from the dispenser pad.
- In the event of accidental spillages, wipe up any water from the dispenser area with a soft cloth.

⚠ CAUTION

Filling the water tank with beverages other than drinking water may cause the dispenser to malfunction.

⚠ WARNING

Fill with drinkable water only.
Do not fill the water tank with any other beverages. It must be filled with drinkable water only.
Never fill with hot or warm water.

Note

When dispensing problems occur, re-install the waterbottle securely.
The dispenser pad should be firmly pressed when dispensing water.

Freezer Compartment

If a large quantity of food is to be placed in the freezer compartment,

1. The upper drawer of freezer compartment, twist ice maker kit shall be taken out of the appliance and the food shall be stacked directly on the wire shelf.
2. The middle drawer of freezer compartment shall be taken out of the appliance and food shall be stacked directly on the wire shelf.

Freezer compartment provides wire self on default to maximize food storage capacity. And also the drawer is provided to convenient usage for watery meat or half-liquid state food.

**Max Freezing capacity**

If there is already food in the compartment, please set freezer to the coldest condition (-23°C) and press on "Express freeze" button several hours before placing fresh product in the freezer compartment to get maximum capacity, As a rule 7 hours is adequate.

Sliding Shelf (Optional)

You can slide the sliding shelf in if you need to accommodate taller containers or products on the shelf underneath.

Note

Remove all items from the rear half shelf and the front sliding shelf.

1. Slightly lift up the front of the sliding shelf and slide it inward.
2. The rear half shelf will raise to allow the front to slide in under it, or it can be lifted manually toward the rear wall to allow easier sliding of the front sliding shelf.
3. You can simply pull out the sliding shelf in reverse procedure to return it to the extended position.

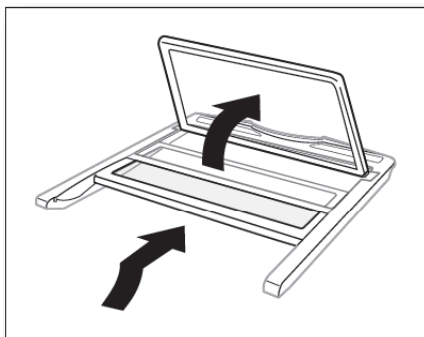
**⚠ CAUTION**

Caution should be taken when adjusting the shelf as it can fall out if not handled correctly.

⚠ CAUTION

Do not lift up the rear half shelf and keep it in the lifted position. Tall items are not to be stored at the rear of the shelf.

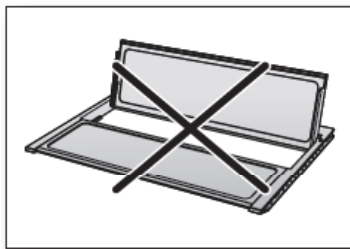

How to remove the rear half shelf.

Slide the front sliding shelf in under the rear half shelf. Then lift the rear half shelf up to remove it.

Note

Make sure the rear half shelf and the front sliding shelf are securely restored to the shelf position before placing items upon it.

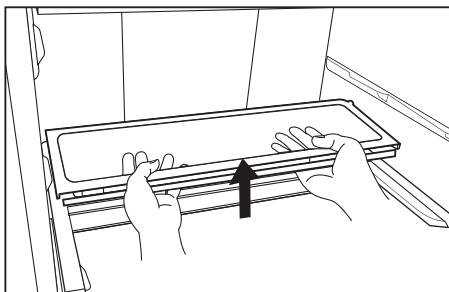
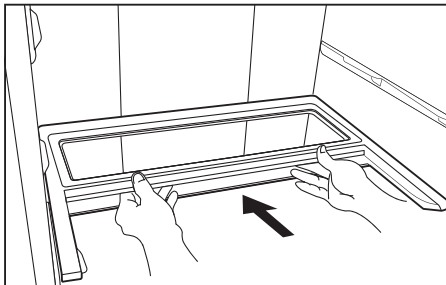

Pull Out Tray (Optional)

The pull out tray offers easy access to items stored at the rear of the tray by sliding it out closer to you.

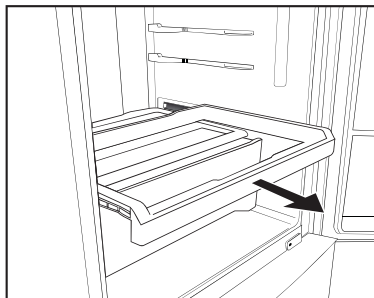

⚠ CAUTION

Please do not hold the bottom of the tray when slide the tray in, as it could catch your hand.

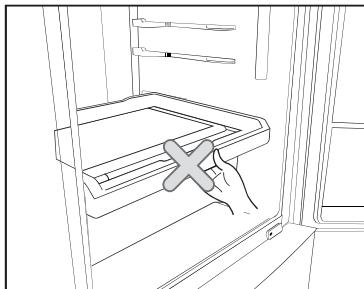
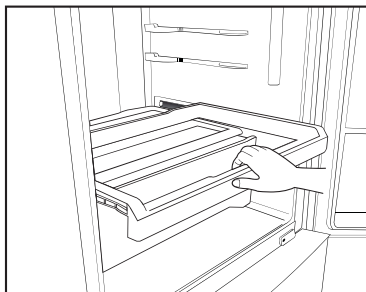

How to remove the Pull Out Tray

Fully extend the Pull-Out-Tray and lift the front then pull it out slowly.

Note

Before removing the pull out Tray, remove the second lowest door basket from the refrigerator door.

Note

Apply caution when pulling out the tray so that items do not fall off. Remove all food items from on the tray first before removing it.

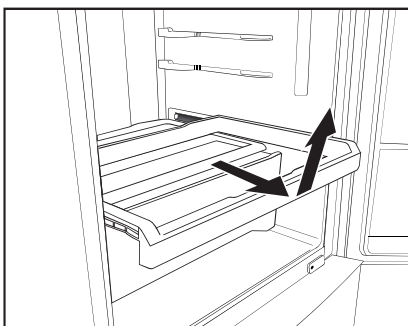

How to separate the vegetable drawer

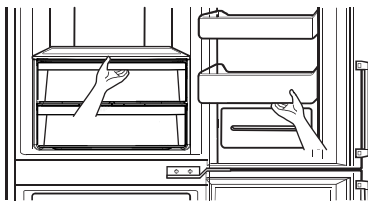

Remove the lower basket from the door by lifting it up.

Pull the drawer until it stops and while slightly lifting it up, pull it further to remove it completely.

How to remove Tray Vegetable Cover

- For the smooth operation of the tray drawer and pull-out tray, Cover T/V is fixed tightly. Beware of disassemble. Assembly is the reverse order of disassembly.

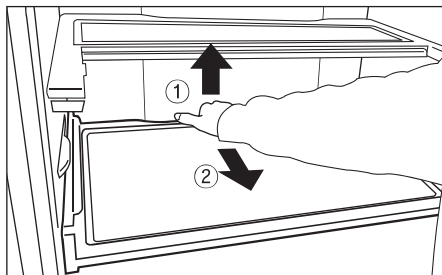

- First, disassemble Pull-out tray and Tray drawer, then
 - Put your hand into the gap in the refrigerator and the Cover T/V then lift up.
 - Remove by pulling in front while it is lifted up.

Lamp Replacement

Note

This product uses LED Lamps which can not be replaced by the user.

Please contact an authorized service center for LED lamp service or replacement.

Storing Food

▲ CAUTION

- Do not store food which spoils easily at low temperature, such as banana, and melon.
- Allow hot food to cool prior to storing. Placing hot food in the refrigerator could spoil other food, and lead to higher electricity bills.
- When storing the food, use a container with a lid. This prevents moisture from evaporating, and helps food to keep its taste and nutrients.
- Do not block air vents with food. Smooth circulation of cold air keeps refrigerator temperature even.
- Do not open the door frequently. Opening the door lets warm air enter the refrigerator, and cause temperature to rise.
- Never keep too many foods in the door baskets, as this may stop the door from fully closing.
- Do not store bottles in the freezer compartment- they may break when frozen and cause injury.
- Do not refreeze food that has been thawed. This causes loss of taste and nutrition.
- Do not store pharmaceutical products, scientific materials or other temperature sensitive products in the refrigerator.
Products that require strict temperature controls must not be stored in the refrigerator.
- If you want to quick freeze new food, place it in the middle drawer of freezer compartment, and then press the Express Freeze button.
- To ensure good air circulation in the appliance, push in the freezer drawers all the way.

Suggestion for Energy Saving

- Please do not keep the door open for a long period of time.
- Do not over load the shelves and drawers with food as this will compromise the air flow and cause the refrigerator to run for longer periods.
- Do not set the temperature of refrigerator lower than needed. Do not put the food near the temperature sensor. Keep a distance of at least 5cm from the sensors.
- Allow hot food to cool prior to storing. Placing hot food in the refrigerator could spoil other food, and lead to higher electricity bills.
- Do not block air vents with food. Smooth circulation of cold air keeps refrigerator temperatures even.
- Do not open the door frequently. Opening the door lets warm air enter the refrigerator, and cause internal temperatures to rise.
- Arrange food items so that frequently used items are placed toward the front of the shelves or drawers.

General Information

Vacation time

- During average length vacations, you will probably find it best to leave the refrigerator in operation. Place freezable items in freezer for longer life. When you plan not to use the appliance, remove all food, disconnect the power cord, clean the interior thoroughly, and leave each door OPEN to prevent odor formation.

Power Failure

- A 1 to 2 hour power failure will not significantly disrupt the internal temperature. Try to avoid opening and closing the door too frequently so that the temperatures remain as stable as possible until the power is restored.

If You Move

- Take out all food from the refrigerator and firmly fix loose items with tape.
- Turn the leveling screws until they stop before moving the refrigerator. Otherwise they may scratch the floor and cause the refrigerator not to move.

Anti Condensation Pipe

- The Anti-Condensation pipe is installed around the front side of refrigerator and freezer, as well as on the partition **Anti-Condensation Pipe** between refrigerator compartment and freezer compartment to prevent dew and condensation.
- Especially after installation or when ambient temperatures are high, the refrigerator may feel hot on the front and side surfaces, which is quite normal.

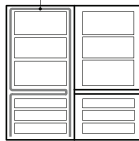

To Reverse the Doors (Optional)

- Your fridge-freezer is designed with reversible doors, so that they may open from either the left or right hand side to suit your kitchen design.

⚠ CAUTION

However, When you want to reverse the doors, you must call to service agent. Reversing the doors is not covered by the warranty.

Cleaning

Before Cleaning

Be sure to unplug the power before cleaning or vacuuming any exterior surface or covers.

Exterior

Clean the outside of the refrigerator with a soft cloth soaked with warm water or mild dishwashing detergent. If you use a detergent, be sure to wipe it with a clean wet cloth.

Interior

Same as above.

After Cleaning

Check that the power cord is not damaged, power plug has not overheated, and that the power plug is properly inserted into the outlet.

WARNING

Be sure to dry the appliance with a cloth after wiping it with water.

Do not use abrasive, petroleum, benzene, thinner, hydrochloride acid, boiling water, rough brushes or scourers, etc, as they may damage parts of the refrigerator.

Water Dispenser Drip Tray

Wipe moisture from around the door part and the drip tray using a clean cloth.

Water Dispenser

Wipe moisture from the dispenser area and on the dispenser pad using a cloth.

Separating the Water Tank lid from the water tank.

- Remove the Water Tank from the door. Lift up the release lever and release the 2 side clips on the Tank lid.
- The water tank can be washed when removed from the refrigerator by using neutral cleansing agents. Rinse thoroughly before refitting and refilling.

Cleaning the Water Tank and filling lid

The water tank lid and filling cap should be cleaned periodically after being removed from the water tank. A small brush such as a toothbrush can be used to clean the grooved part of the filling cap.

CAUTION

Ensure that the Water Tank lid is securely fitted to the Water Tank before filling it through the fill hole.

Smart Diagnosis™

(Optional)

Should you experience any problems with your refrigerator, it has the capability of transmitting data via your telephone to the LG service center. This gives you the capability of speaking directly to our trained specialists. The specialist records the data transmitted from your machine and uses it to analyze the issue, providing a fast and effective diagnosis.

If you experience problems with your refrigerator, call to the LG service center.

Only use the Smart Diagnosis feature when instructed to do so by the LG call center agent. The transmission sounds that you will hear are normal and sound similar to a fax machine.

Smart Diagnosis cannot be activated unless your refrigerator is connected to power.

If your refrigerator is unable to turn on, then troubleshooting must be done without using Smart Diagnosis.

First, call to the LG service center. Only use the Smart Diagnosis feature when instructed to do so by the LG call center agent.

1. Close the refrigerator door.
2. Set display lock (Maintain 5 min protect logic) button for 3 seconds.

-In case of unlock condition.

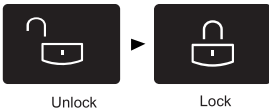

-In case of lock condition.



3. Press and hold the 'Freezer' button for more than 3 seconds.

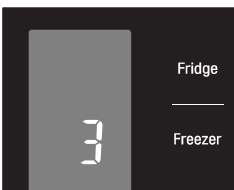

It will display "3", other LED will turn OFF

Note

After 5 minutes closing door, this option turn off and display will return to normal condition.

4. Open the refrigerator door.
5. Following the instructions of the operator, hold the phone's microphone close to the icon «SmartDiagnosis».

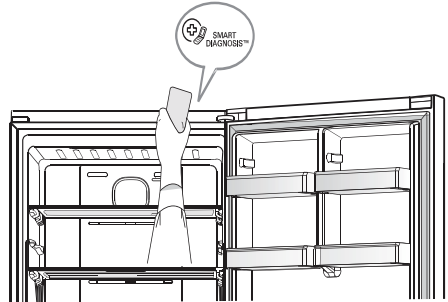

6. Hold the phone in the position until the end of the sound data transfer.
7. Keep the phone in place until the tone transmission has finished. This takes about 3 to 6 seconds
Resume your conversation with the consultant, who will then be able to assist you in using the information transmitted for analysis.

Note

- For best results, do not move the phone while the tones are being transmitted.
- If the call center agent is not able to get an accurate recording of the data, you may be asked to try again.
- Call quality differences by region may affect the function.
- Use the home telephone land line for better communication strength and signal clarity.
- Poor signal quality may result in poor data transmission from your phone to the machine, which could cause Smart Diagnosis to not work properly.

Trouble Shooting

Before calling for service, check this list. It may save you both time and expense.

This list includes common occurrences that are not the result of defective workmanship or materials in this appliance.

Problem	Possible Causes
Refrigerator does not operate	<ul style="list-style-type: none"> • Power plug may be unplugged from the power outlet. Plug it in securely. • House fuse has blown or circuit breaker has tripped. Check and/or replace fuse and reset circuit breaker. • Power cut. Check house lights and other appliances.
Refrigerator or Freezer Compartment Temperature too warm	<ul style="list-style-type: none"> • Temperature control not set on proper position. Refer to Temperature Control section. • Appliance is placed close to a heat source. • Warm weather-frequent door openings. • Door left open for a long time. • Package holding door open or blocking air duct in freezer compartment.
Vibration or Rattling or Abnormal Noise	<ul style="list-style-type: none"> • The floor on which the refrigerator is installed may be uneven or the refrigerator may be unstable. Make it even by rotating the leveling feet. • Unnecessary objects placed in the back side of the refrigerator.
Frost or Ice Crystals on frozen Food	<ul style="list-style-type: none"> • Door may have been left ajar or package holding door open. • Too frequent or too long door openings. • Frost within food packaging can be normal.
Moisture forms on Cabinet Surface	<ul style="list-style-type: none"> • This phenomenon is likely to occur in a wet or humid environment. Wipe it with a dry towel.
Moisture collects inside	<ul style="list-style-type: none"> • Too frequent or too long door openings. • In humid weather, air carries moisture into refrigerator when doors are opened.
Refrigerator has odor	<ul style="list-style-type: none"> • Foods with strong odors should be tightly covered or wrapped. • Check for spoiled food. • Interior needs cleaning. Refer to CLEANING section.

Door not closing properly

- Food package is keeping door open.
Move packages that keep door from closing.
- Refrigerator is not level.
Adjust the leveling feet.
- The floor on which the refrigerator is installed may be uneven or the refrigerator may be unstable.
Slightly raise the front side of the refrigerator by turning the leveling feet clockwise.

Interior light does not work

- No power at outlet.
- If the LED lamp does not function, you must contact an authorised service provider or the manufacturer.

No water dispensing

- Water level is too low in Water Tank.
Fill the Water Tank with water. (Approx. 2.3 Lt capacity)

**DISPOSAL OF YOUR OLD APPLIANCE**

- 1 This crossed-out wheeled bin symbol indicates that waste electrical and electronic products (WEEE) should be disposed of separately from the municipal waste stream.
- 2 Old electrical products can contain hazardous substances so correct disposal of your old appliance will help prevent potential negative consequences for the environment and human health.
Your old appliance may contain reusable parts that could be used to repair other products, and other valuable materials that can be recycled to conserve limited resources.

- 3 You can take your appliance either to the shop where you purchased the product, or contact your local government waste office for details of your nearest authorised WEEE collection point.
For the most up to date information for your country please see www.lg.com/global/recycling

It is normal...

The following occurrences are normal.

	Occurrence	Solution
Noise	When you hear "Tak" or "Took" sound	This is the sound of various parts expanding/contracting or various control devices operating depending on the temperature change within the refrigerator.
	When you hear "Deureureuk~", "Dulkuk" or "Woong" sound	This is the compressor or fan operating when the operation of the refrigerator is starting or ending. This is the same phenomenon of the sound generated when starting or turning off the engine of a car.
	When you hear "Kureureuk" sound of water flowing	This is the sound of refrigerant changing the condition in the freezer/refrigerator. When the liquid changes to gas, you will hear the sound of water flowing and when gas changes to liquid, you will hear the "Kureureuk" sound.
	When you hear the sound of wind such as "Shoo~" or "Shik" right after you close the door	This is the sound generated when the internal pressure is temporarily lowered when the warm air entered through the refrigerator or freezer is rapidly cooled.
	When you hear a vibrating sound	If the refrigerator is installed on wooden floor or wooden wall, or if the refrigerator is not leveled properly, the sound can be loud from the vibration.
	When you hear a loud sound after installing the product for the first time	When you operate the refrigerator for the first time, the refrigerator will operate at high speed to cool fast and the sound can seem louder. When the internal temperature falls below a certain level, the noise will subside.
Door open	When the door is slightly opened after closing the door	Depending on the force or speed of closing the refrigerator or freezer door, the door can open slightly and then close again. Be careful not to close the door too hard.
Icing/ Dew drops	When there is icing or dew drops formed on the inner or outer side of the refrigerator	When warm external air flows into the cool inner surface of the refrigerator, icing/dew drops can be formed. Especially, this will happen more easily when you open and close the refrigerator door more frequently. Also if the humidity of the installed location is high or during the rainy season or on a rainy day, condensation can form on the outer side of the refrigerator. This is a natural phenomenon that occurs during the humid weather. Wipe the condensation with a dry cloth.
Temperature	When the front side of the refrigerator is warm	Heat pipes are installed around the front part of the refrigerator and on the divider of the freezer and refrigerator to prevent condensation from forming. The refrigerator may feel warmer after the installation or during summer, this is not a malfunction and is a normal occurrence.

