

Serie | 4

# HBS573BS0B

## Single Oven

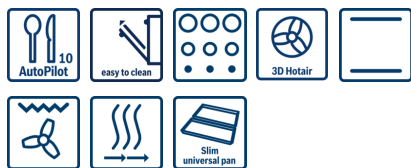

### Included accessories

2 x combination grid  
1 x universal pan  
2 x Universal pan  
slim size

### Optional accessories

HEZ538000 : 1fold telescopic rail, level independent

## The built-in oven with AutoPilot: automatically prepares perfect dishes.

- **3D Hotair:** perfect results thanks to optimal distribution of heat on up to 3 levels simultaneously.
- **AutoPilot 10:** every dish is a perfect success thanks to 10 pre-set automatic programmes.
- **LED display control, red:** easy-to-use thanks to the time functions.
- **Pyrolytic self-cleaning:** no cleaning effort thanks to automatic self-cleaning.
- Easy to clean grey enamel interior
- **Slim Universal Pans:** 2 universal pans, slim size; optimised for smaller dishes

### Technical Data

|   |                               |
|---|-------------------------------|
| Color / Material Front :  | Stainless steel               |
| Construction type :   | Built-in                      |
| Integrated Cleaning system :                                      | Pyrolytic                     |
| Required niche size for installation (HxWxD) :                    | 585-595 x 560-568 x 550       |
| Dimensions of the product (mm) :                                  | 595 x 594 x 548               |
| Dimensions of the packed product (HxWxD) (mm) :                   | 675 x 690 x 660               |
| Control Panel Material :  | Stainless steel               |
| Door Material :   | Glass                         |
| Net weight (kg) :   | 41.8                          |
| Usable volume of cavity (l) :                                     | 71                            |
| Cooking method :  | Conventional                  |
| heat, Full width grill, Heißluft sanft, Hot Air, Hot air grilling |                               |
| First cavity material :   | Other                         |
| Temperature control :   | No control of the temperature |
| Number of interior lights :                                       | 1                             |
| Approval certificates :   | CE, VDE                       |
| Length of electrical supply cord (cm) :                           | 120                           |
| EAN code :  | 4242005034161                 |
| Number of cavities (2010/30/EC) :                                 | 1                             |
| Energy efficiency class (2010/30/EC) :                            | A                             |
| Energy consumption per cycle conventional (2010/30/EC) :          | 0.99                          |
| Energy consumption per cycle forced air convection (2010/30/EC) : | 0.81                          |
| Energy efficiency index (2010/30/EC) :                            | 95.3                          |
| Electrical connection rating (W) :                                | 2990                          |
| Current (A) :   | 13                            |
| Voltage (V) :   | 220-240                       |
| Frequency (Hz) :  | 50; 60                        |
| Plug type :   | no plug                       |



## Serie | 4 Ovens

### HBS573BS0B

#### Single Oven

**The built-in oven with AutoPilot:  
automatically prepares perfect dishes.**

#### Design

- LED-display control (red)
- Drop down door
- Retractable control dials, Rotary dial
- Straight bar handle
- Cavity inner surface: Enamel grey

#### Features

- Automatic start  
Heating-up indicator  
AutoPilot
- Electronic door lock  
Control panel lock  
Automatic safety switch off
- AutoPilot10
- Electronic clock timer
- Halogen interior light
- 5 shelf positions

#### Cleaning

- Pyrolytic self-cleaning function
- Full glass inner door

#### Programmes/functions

- Oven with 5 heating methods: 3D hot air, conventional top and bottom heat, Hotair grilling, full width variable grill, Hotair gentle
- Fast pre-heating function

#### Standard accessories

- 2 x combination grid, 1 x universal pan, 2 x Universal pan, slim size

#### Performance/technical information

- Energy efficiency rating (acc. EU Nr. 65/2014): A  
Energy consumption per cycle in conventional mode: 95.3  
Energy consumption per cycle in fan-forced convection mode: 0.81 kwh  
Number of cavities: 1  
Cavity volume: 71 litre capacity
- Temperature range 50 °C - 275 °C
- Integral cooling fan
- Length of mains cable: 120 cm
- Total connected load electric: 2.99 KW
- Nominal voltage: 220 - 240 V
- Appliance dimension (hxwx d): 595 mm x 594 mm x 548 mm
- Niche dimension (hxwx d): 585 mm - 595 mm x 560 mm - 568 mm x 550 mm
- Please refer to the dimensions provided in the installation manual

## Serie | 4 Ovens

**HBS573BS0B**

**Single Oven**

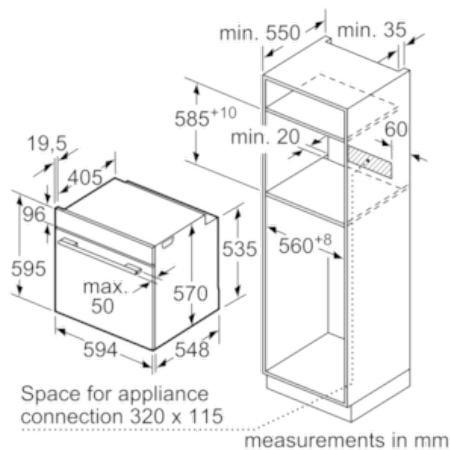
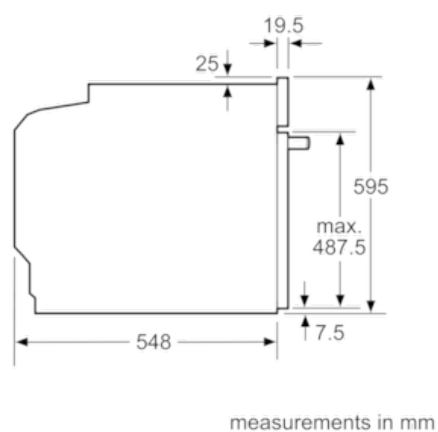
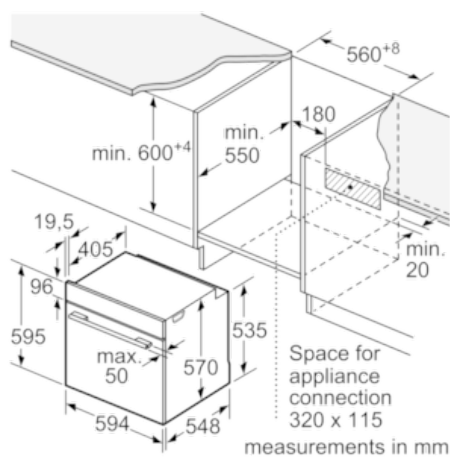

Installation with a hob.

