

Serie | 6, Built-in oven with added steam function, Stainless steel
HRS578BS6B

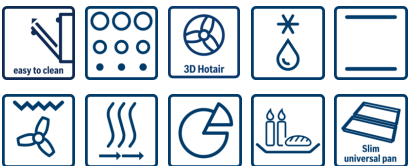

Included accessories

2 x combination grid
1 x universal pan
2 x Universal pan
slim size

Optional accessories

HEZ327000 : Pizza stone
HEZ530000 : Half tray
HEZ531000 : Baking tray, grey enamelled
HEZ531010 : Baking tray, non-stick ceramic coated
HEZ538000 : 1fold telescopic rail, level independent
HEZ625071 : Grill tray, anthracite enamelled
HEZ634000 : Baking and roasting grid (standard)
HEZ636000 : Glass pan
HEZ638300 : 3 level telescopic rails, full ext
HEZ915003 : Glass roasting dish, 5,4 L

The built-in oven with AutoPilot and added steam: automatically prepares your dishes so they're crispy and juicy.

- **Added Steam cooking:** keeping food crispy on the outside and juicy on the inside
- **3D Hotair:** perfect results thanks to optimal distribution of heat on up to 3 levels simultaneously.
- **AutoPilot 30:** every dish is a perfect success thanks to 30 pre-set automatic programmes.
- **White LCD display control:** easy-to-use thanks to direct access to additional functions, temperature recommendation and temperature indication.
- **Pop-out controls:** for an easy to clean front.
- **Pyrolytic self-cleaning:** no cleaning effort thanks to pyrolytic cleaning programmes
- **Pyrolytic self-cleaning:** no cleaning effort thanks to pyrolytic cleaning programmes
- **Slim Universal Pans:** 2 universal pans, slim size; optimised for smaller dishes
- **Home Connect:** home appliances with smart connectivity for an easier everyday life.
- Home Connect takes the guesswork out of cooking new recipes
- Use your mobile device to remotely check your oven status, then control it via the Home Connect app.
- Smart support, smart solutions - at the touch of a button.
- Fast pre heating

Technical Data

Color / Material Front :	Stainless steel
Construction type :	Built-in
Integrated Cleaning system :	Pyrolytic
Required niche size for installation (HxWxD) :	585-595 x 560-568 x 550
Dimensions of the product (mm) :	595 x 594 x 548
Dimensions of the packed product (HxWxD) (mm) :	675 x 690 x 660
Control Panel Material :	Stainless steel
Door Material :	Glass
Net weight (kg) :	42.773
Usable volume of cavity (l) :	71
Cooking method :	Conventional heat, Defrost, Full width grill, Hot Air, Hot air grilling, low temperature cooking, Pizza setting
First cavity material :	Other
Oven control :	electronic
Number of interior lights :	1
Approval certificates :	CE, VDE
Length of electrical supply cord (cm) :	120
EAN code :	4242005165957
Number of cavities (2010/30/EC) :	1
Energy efficiency class (2010/30/EC) :	A
Energy consumption per cycle conventional (2010/30/EC) :	0.99
Energy consumption per cycle forced air convection (2010/30/EC) :	0.81
Energy efficiency index (2010/30/EC) :	95.3
Connection rating (W) :	3600
Current (A) :	16
Voltage (V) :	220-240
Frequency (Hz) :	50; 60
Plug type :	no plug



Serie | 6, Built-in oven with added steam function, Stainless steel HRS578BS6B

The built-in oven with AutoPilot and added steam: automatically prepares your dishes so they're crispy and juicy.

Design

- LCD-display control (white)
- Retractable control dials, round
- Straight bar handle

Features

- Home Connect ready
- Electronic door lock Control panel lock Automatic safety switch off Residual heat indicator Door contact switch
- Digital temperature display with proposal Heating-up indicator Sabbath setting AutoPilot Automatic start
- AutoPilot, 30
- Electronic clock timer
- Interior halogen light
- Integral cooling fan
- 5 shelf positions

Cleaning

- Pyrolytic self-cleaning function
- Full glass inner door
- Automatic programmes

Programmes/functions

- Oven with 9 heating methods: 3D Hotair, conventional top and bottom heat, Hotair grilling, full width variable grill, pizza function, low temperature cooking, defrost, Hotair gentle, reheating
- Additional functions: Descaling programme
- Heating modes in combination with steam function: Hot air, Hot air grilling, Top/bottom heat
- Fast pre-heating function

Accessories

- 2 x combination grid, 1 x universal pan, 2 x Universal pan, slim size

Performance/technical information

- Energy efficiency rating (acc. EU Nr. 65/2014): A Energy consumption per cycle in conventional mode: 0.99 kWh Energy consumption per cycle in fan-forced convection

mode: 0.81 kWh Number of cavities: Main cavity Heat source: electrical Cavity volume: 71 litre capacity

- Water tank with a volume of 220ml
- Location of water tank: Outside cavity
- 120 cm Cable length
- Temperature range 30 °C - 275 °C
- Total connected load electric: 3.6 KW
- Nominal voltage: 220 - 240 V
- Appliance dimension (hwxwd): 595 mm x 594 mm x 548 mm
- Niche dimension (hwxwd): 585 mm - 595 mm x 560 mm - 568 mm x 550 mm
- Please refer to the dimensions provided in the installation manual

**Serie | 6, Built-in oven with added steam
function, Stainless steel
HRS578BS6B**

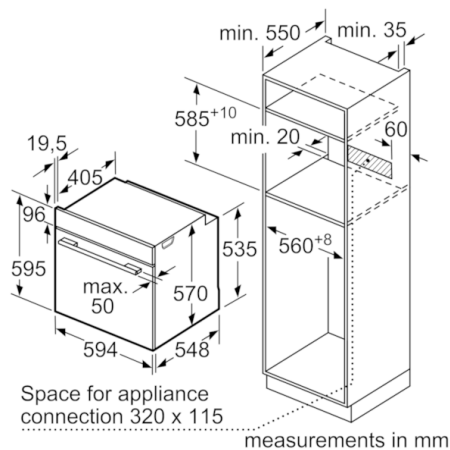
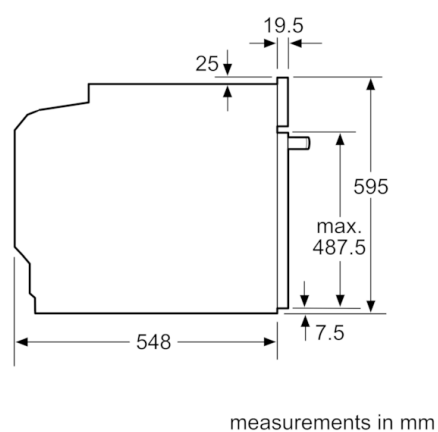
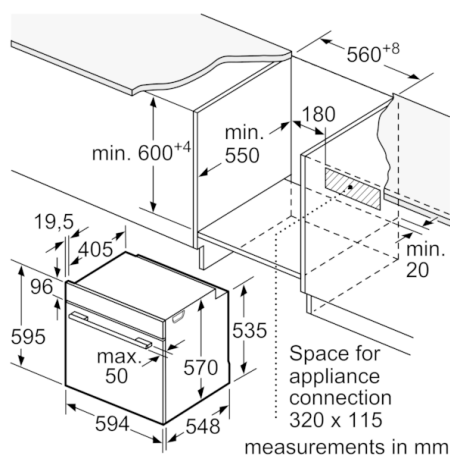

Installation with a hob.

