

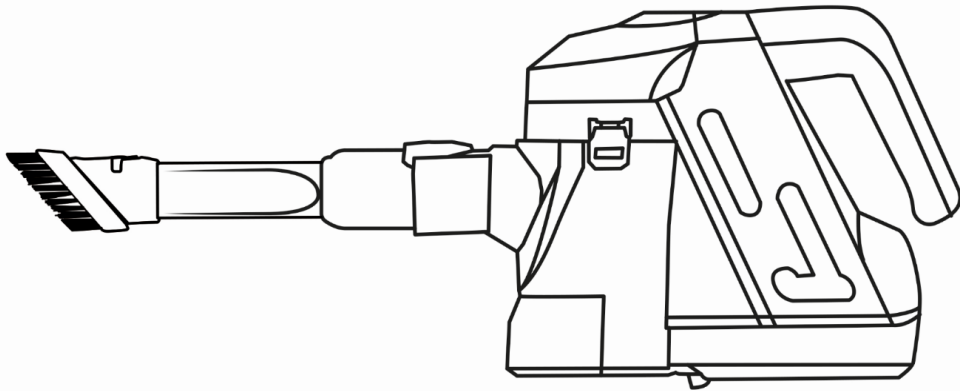

Russell Hobbs

22.2V Turbo Lite Ultra Cordless Handheld Vacuum



Model Number: RHHS2202

For Customer Services & Spare Parts please call **0345 209 7461**
Opening times: Monday - Friday 8am – 8pm & Saturday 9am – 1pm
Or visit us at **www.productcare.co.uk**

PLEASE RETAIN
FOR FUTURE REFERENCE

CONTENTS

	Page(s)
Safety instructions	3-6
Turbo Lite Ultra feature diagram	7
Turbo Lite Ultra assembly	8-10
Charging your Turbo Lite Ultra	11
Using your Turbo Lite Ultra	12
Cleaning and care	13-15
Problem solving	16
Guarantee and customer services	17
Spare parts	18
Notes	19
Disposal information	20

Thank you for purchasing your 22.2V Turbo Lite Ultra 4 in 1 Cordless Cleaner.

To get the best from your new cleaner, take a few moments to read these instructions and keep them in a safe place for future reference.

Should you require any further assistance, our friendly Product Care team will be happy to help.

For Customer Services & Spare Parts please call **0345 209 7461**
Opening times: Monday - Friday 8am – 8pm & Saturday 9am – 1pm
Or visit us at **www.productcare.co.uk**

SAFETY INSTRUCTIONS

IMPORTANT SAFETY INSTRUCTIONS READ CAREFULLY AND KEEP FOR FUTURE REFERENCE

WARNING:

- It is hazardous for anyone other than a competent person to carry out any service or repair operation that involves the removal of a cover which gives protection against exposure to electrical parts.
- This product is intended for household use only. Do not use outdoors.
- This appliance can be used by children aged from 8 years and above and persons with reduced physical, sensory or mental capabilities or lack of experience and knowledge if they have been given supervision or instruction concerning use of the appliance in a safe way and understand the hazards involved. Children shall not play with the appliance. Cleaning and user maintenance shall not be made by children unless they are older than 8 and supervised. Keep the appliance and its cord out of reach of children less than 8 years.
- Only use the charger provided with the product. Using another charger may damage the product and battery.
- Do not immerse in water or other liquids for cleaning.
- Do not store or charge the unit outdoors
- Do not use outdoors or on wet surfaces
- Use only as described in this manual

SAFETY INSTRUCTIONS

IMPORTANT SAFETY INSTRUCTIONS READ CAREFULLY AND KEEP FOR FUTURE REFERENCE

WARNING:

- **Do not attempt to use the charger with any other product nor attempt to charge this product with another charger**
- **Do not abuse the charger cord; never carry the charger or base by the cord or pull cord to disconnect from an outlet; grasp the charger and pull to disconnect from an outlet.**
- **Keep hair, clothing, fingers, and all parts of the body clear of moving parts.**
- **Do not pick up anything that is flammable, burning or smoking.**
- **Use extra care when cleaning on the stairs.**
- **Never remove parts from the appliance such as the feet, screws and so on.**
- **Only use the accessories supplied by the manufacturer.**
- **Do not operate this appliance for anything other than its intended use.**
- **Never put any objects into the openings on the outer case.**
- **This appliance is authorized for household/residential use only**
- **Do not allow to be used as a toy. Close attention is necessary when used by or near children.**

SAFETY INSTRUCTIONS

IMPORTANT SAFETY INSTRUCTIONS READ CAREFULLY AND KEEP FOR FUTURE REFERENCE

WARNING:

- **Use only as described and for the uses described in this manual**
- **Do not use the charger if power cord or plug has been damaged.**
- **Do not use cordless vacuum cleaner or charger if it has been dropped, damaged, left outdoors, or dropped in water. Contact customer services for advice.**
- **Do not run over charger cord with vacuum cleaner. Always unplug charger from vacuum cleaner before use.**
- **Keep charger cord away from heated surfaces(e.g., cooking surfaces).**
- **Do not handle charger cord or vacuum cleaner with wet hands or while barefoot.**
- **Do not put any objects into openings. Do not use with any opening blocked, keep free of dust, lint, hair and anything that may reduce particle flow into the dust container.**
- **Do not use the vacuum cleaner without dust container in place.**

SAFETY INSTRUCTIONS

IMPORTANT SAFETY INSTRUCTIONS READ CAREFULLY AND KEEP FOR FUTURE REFERENCE

- **Do not attempt to empty dust container while unit is running, always turn off the appliance and unplug before emptying/replacing the dust container.**
- **Turn off vacuum cleaner before clearing debris from tools**

For Customer Services & Spare Parts please call **0345 209 7461**
Opening times: Monday - Friday 8am – 8pm & Saturday 9am – 1pm
Or visit us at **www.productcare.co.uk**

TURBO LITE ULTRA FEATURE DIAGRAM

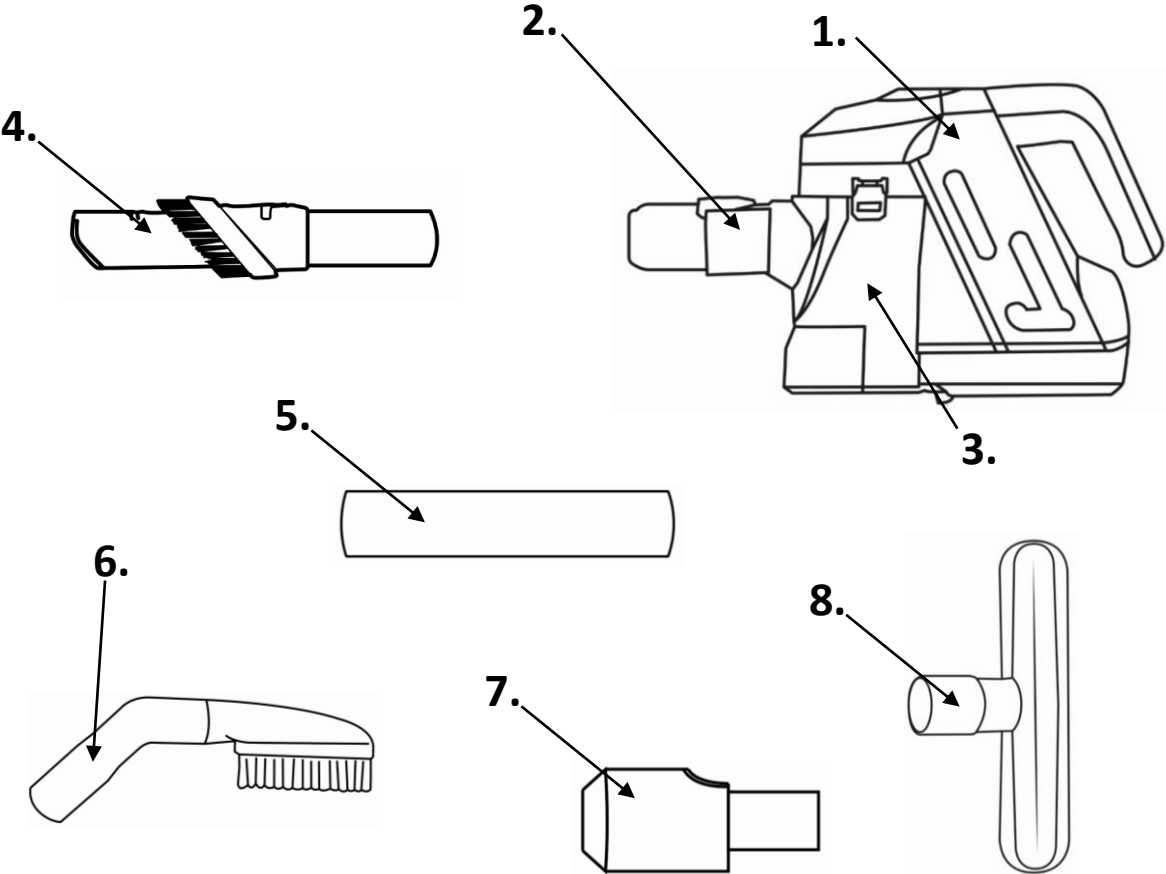

- | | | | |
|---|---------------------------|---|----------------------|
| 1 | Handheld Unit | 5 | Short Extension Tube |
| 2 | Nozzle | 6 | Large Brush Tool |
| 3 | Dust Container | 7 | Connecting Joint |
| 4 | 2 in 1 Crevice/Brush Tool | 8 | Mattress Tool |

For Customer Services & Spare Parts please call **0345 209 7461**
Opening times: Monday - Friday 8am – 8pm & Saturday 9am – 1pm
Or visit us at www.productcare.co.uk

TURBO LITE ULTRA ASSEMBLY

Before using your cleaner

Remove all packaging and lay out the separate components.

Check the unit after unpacking for any visual damage such as:

- Misaligned or damaged parts
- Damage to the main body and separate components
- Damage to the plug or cable.

If you can see any damage do not use the cleaner and contact customer services.

Charge your Turbo Lite Ultra before first use.

For Customer Services & Spare Parts please call **0345 209 7461**
Opening times: Monday - Friday 8am – 8pm & Saturday 9am – 1pm
Or visit us at **www.productcare.co.uk**

TURBO LITE ULTRA ASSEMBLY

Attaching the tools

1. The connecting joint must be attached to use all tools. Line up the connecting joint ensuring that the pins are aligned and push into the nozzle of the hand held unit until it clicks into place.
2. Then, push the desired tool into the connecting joint.

2 in 1 Crevice/Brush Tool

The crevice tool is for narrow gaps and hard to reach places and the brush tool can be used for dusting and cleaning delicate surfaces. To use the 2 in 1 Crevice/Brush tool, first attach the connecting joint to the handheld unit. Then, push the 2 in 1 attachment into the connecting joint (as shown below).

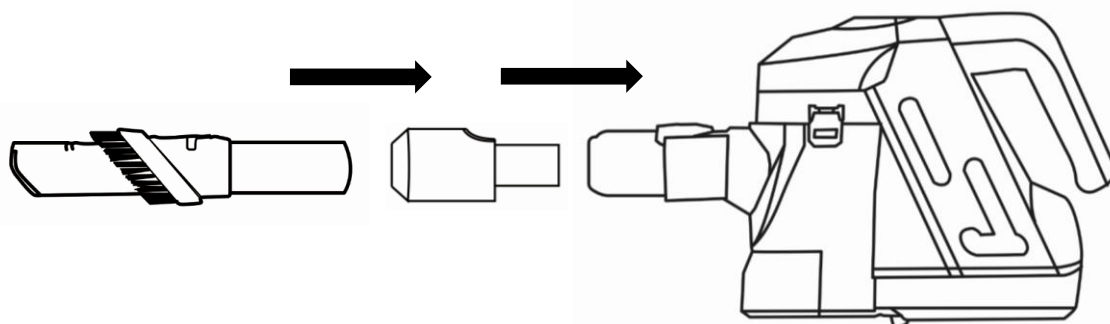

To use the brush tool, slide the brush to the end of the tool until it clicks into place.

To use the crevice tool, push the button on the end of the brush tool and slide the brush back to expose the crevice tool until the brush clicks in to place.

TURBO LITE ULTRA ASSEMBLY

Attaching the tools

Mattress Tool

The mattress tool is to help clean mattresses, bedding and other upholstery.

To use the mattress tool, attach the connecting joint to the nozzle of the main unit then push the mattress tool into the connecting joint.

Large Brush Tool

The large brush tool can be used for high reach cleaning such as shelving and furniture tops.

To use the large brush tool, attach the connecting joint to the nozzle of the main unit then push the large brush tool into the connecting joint.

Short Extension Tube

The short extension tube can be used along with any of the cleaning tools to increase cleaning distance.

To use the short extension tool, attach the connecting joint to the nozzle of the main unit. Then, add the desired cleaning tool to the end of the short extension tube and push the other end into the connecting joint.

To remove the tools, simply pull out of the connecting joint. To remove the connecting joint from the handheld unit, press the release button on the top and pull away from the unit.

CHARGING YOUR TURBO LITE ULTRA

Before using for the first time you will need to charge the cleaner.

- 1.** Before charging ensure the cleaner is switched off.
- 2.** Plug the charging cable into the adaptor socket on the side of the handheld unit. Insert the plug into a suitable 13 Amp mains socket, pressing the switch on.
- 3.** The charging indicator light on the vacuum cleaner will illuminate red, flashing in 2 second intervals to show that the unit is charging.

A full first time charge should be given 5 hours.

Once charged, the indicator light will illuminate solid red.

Note:

- The body may become warm during charging and this is completely normal.
- Make sure the battery is charged when the product will not be used for prolonged periods of time.

USING YOUR TURBO LITE ULTRA

Once assembled and charged:

1. Unplug the charger and place the desired cleaning tool on the area that you would like to clean.
2. Slide the power switch on the top of the unit (circled below) to start the power.
3. Move the cleaning tool in a forwards and backwards motion over the areas you would like to clean.

Note: Large items can get trapped in the cleaning tool which could cause the unit to overheat. Make sure you pick up larger items that could get trapped before vacuuming.

4. To turn off the power, slide the power switch on the top of the unit.

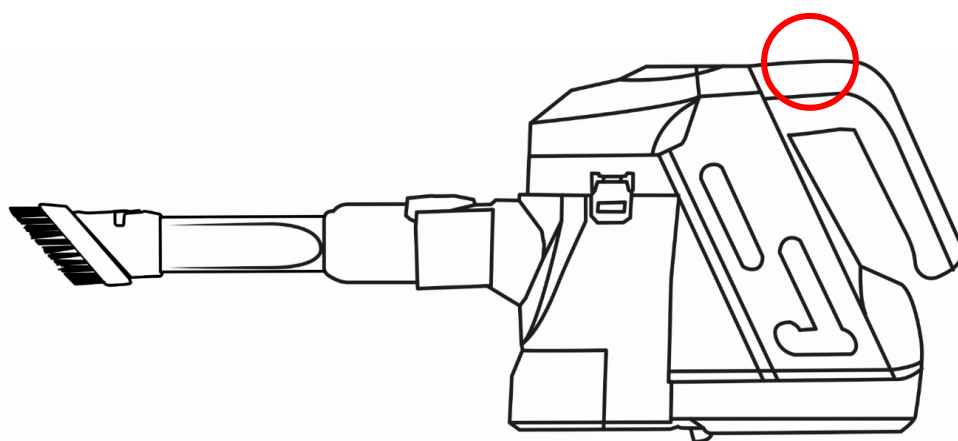

CLEANING AND CARE:

EMPTYING THE DUST CONTAINER

Make sure to empty the dust container before the 'MAX' fill line is reached. Press the release button on the top of the vacuum cleaner (1), and lift the dust container clear of the base.

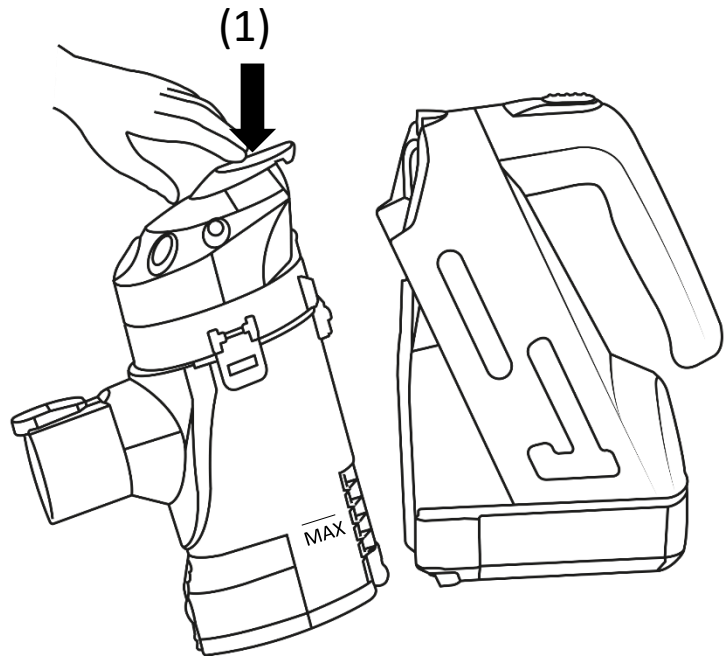

Whilst holding over a bin or inside a bin bag, press down the button on the dust container below the nozzle to open the bottom and release the dust (2).

Important: You may wish to empty the dust container outdoors as emptying may create a dust cloud.

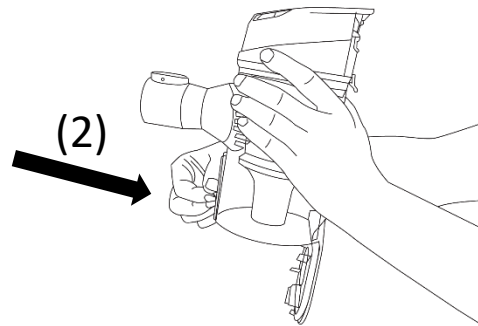

Once empty, close the bottom of the dust container then clip the dust container back into the vacuum cleaner unit, ensuring the bottom of the dust container is correctly located before the release button clicks back into place.

CLEANING AND CARE:

CLEANING THE FILTER

Turn off and unplug the cleaner. Remove the dust container as per instructions on page 13.

Remove the filter assembly by unclipping the filter release clips on both sides of the dust container. (1)

Twist the lid of the dust container assembly to the UNLOCK position and remove (2).

Remove the sponge and HEPA filters (3). To clean, remove excess dust from the filter using a soft brush. Wash in warm water and allow to dry for 24 hours.

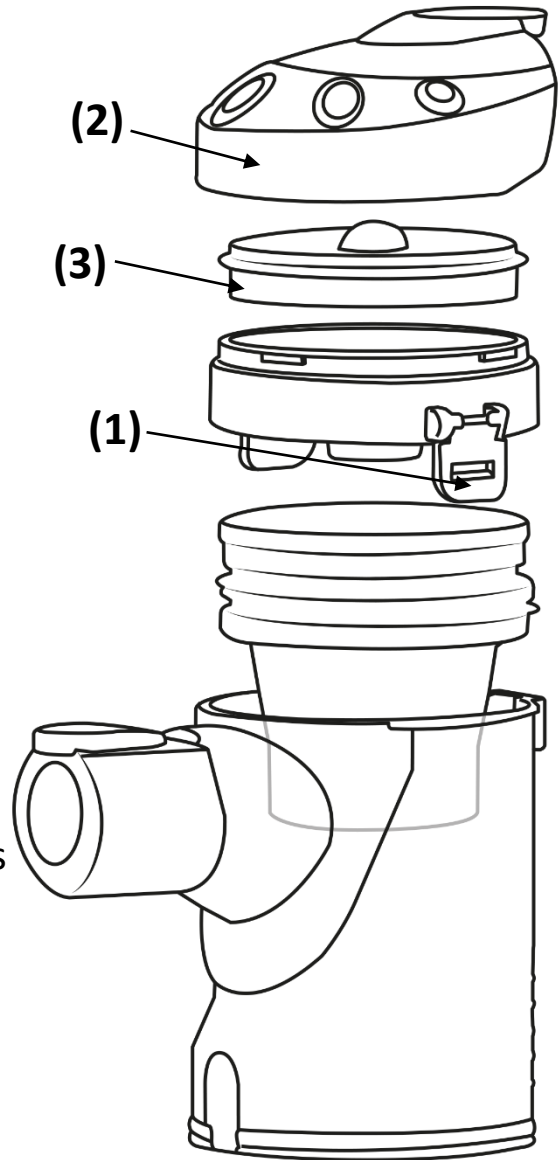

Replace the filters, then twist the lid of the dust container to the LOCK position. Refit the dust container as per the instructions on page 13.

CLEANING AND CARE

Before you clean the appliance, make sure the power is switched off and that the unit is not on the charging stand.

To clean the exterior of the device, use a damp, soft cloth and mild detergent.

NEVER IMMERSE THE CLEANER IN WATER.

Wash non-electrical removable accessories in warm soapy water and allow to dry thoroughly before next use.

If the cleaner is damaged, contact the customer service helpline using the details at the bottom of this page.

Storage

Store in a clean and dry environment.

For Customer Services & Spare Parts please call **0345 209 7461**
Opening times: Monday - Friday 8am – 8pm & Saturday 9am – 1pm
Or visit us at **www.productcare.co.uk**

PROBLEM SOLVING

<u>PROBLEM</u>	<u>POSSIBLE PROBLEM</u>	<u>POSSIBLE SOLUTION</u>
<i>The cleaner won't turn on</i>	The cleaner hasn't had enough charge	Make sure you have plugged in the cleaner to charge for 5 hours. The light will flash when charging.
	Charging cable is damaged	Make sure there is no signs of damage to the charging cable. If there is damage, do not use. Contact Customer Services.
	The power button has not been pressed	Make sure you have turned on the power using the switch on the main unit.
<i>The suction is decreasing and the cleaner is not picking up dirt</i>	Dust container	Check if the dust container is full, if so, empty it.
	Filters are dirty	Clean the filters. After around 6 months of regular use the filters may need replacing. Contact Customer Services using the details at the bottom of this page.
	Handheld/head blockages	Check that there are no blockages in the handheld suction inlet or tubes. If so, clear these blockages.
<i>Cleaner is over heating</i>	Filters are dirty	Check that the filters are not blocked, if so, clean them following the instructions in this booklet.
<i>Dust is coming out of the vacuum cleaner</i>	Dust container fitting	The dust container has not been fitted correctly. Refit the container following the instructions in this booklet.
<i>The air coming out of the vacuum cleaner smells</i>	Filters are dirty	Clean the filters and dust container.
	Filters are not dry	Ensure the filters have been left to dry for 24 hours before refitting back into the vacuum cleaner and using.

We're here should you need us.

For Customer Services & Spare Parts please call 0345 209 7461
 Opening times: Monday - Friday 8am – 8pm & Saturday 9am – 1pm
 Or visit us at www.productcare.co.uk

GUARANTEE AND CUSTOMER SERVICES

At Russell Hobbs, we take all our customer feedback seriously.

Feel free to contact our Product Care Team, on 0345 209 7461

**Monday – Friday: 8am-8pm & Saturday: 9am – 1pm,
who will be more than happy to assist you.**

This product is guaranteed for **12 months** from the date of the original purchase. If any defect arises due to faulty materials or workmanship, the faulty product must be returned to the place of purchase.

Refund or replacement is at the discretion of the retailer.

The following conditions apply:

- The product must be returned to the retailer with the original proof of purchase.
- The product must be installed and used in accordance with the instructions contained in this instruction guide and any other instructions for use which are supplied.
- It must be used for domestic purposes only and for its intended use.
- This warranty does not cover wear and tear, damage, misuse or consumable parts.

This does not affect your statutory rights.

For Customer Services & Spare Parts please call **0345 209 7461**
Opening times: Monday - Friday 8am – 8pm & Saturday 9am – 1pm
Or visit us at **www.productcare.co.uk**

SPARE PARTS

To check the availability of the following spare parts, simply contact our friendly Customer Services team using the details provided at the bottom of this page.

HEPA Filter

Charging cable

Short Extension tube

Crevice/Brush tool

Connecting joint

Replacement battery

Large Brush Tool

Mattress tool

For Customer Services & Spare Parts please call **0345 209 7461**
Opening times: Monday - Friday 8am – 8pm & Saturday 9am – 1pm
Or visit us at **www.productcare.co.uk**

NOTES



Russell Hobbs

For Customer Services & Spare
Parts please call

0345 209 7461

Opening times: Monday - Friday
8am – 8pm & Saturday 9am – 1pm

Or visit us at

www.productcare.co.uk

Revision 1

Model: **RHHS2202**

Made by G2S Ltd under license
from Spectrum Brands (UK) Limited.
G2S Limited, Wigan, WN2 4AY.
Russell Hobbs is the registered trademark of
Spectrum Brands (UK) Ltd.



This symbol is known as the 'Crossed-out wheellie bin Symbol'. When this symbol is marked on a product/batteries, it means that the product/batteries should not be disposed of with your general household waste. Only discard electrical/electronic/battery items in separate collection schemes, which cater for the recovery and recycling of materials contained within. Your co-operation is vital to ensure the success of these schemes and for the protection of the environment. For your nearest disposal facility, visit www.recycle-more.co.uk or ask in store for details.

We reserve the right, due to possible changes to design, to alter the instruction manual without prior notice.