

Solving Minor Problems Yourself

Problem	Possible Causes	Solution
Iron does not work or is not heating up.	Temperature regulator (H) set to minimum.	Turn the temperature regulator to the desired position.
	Connection problems.	Check that the plug is inserted into the mains socket correctly.
Iron is not steaming	There is no water in the tank (J).	Fill the water tank
	The steam regulator (C) is in the “0” position.	Set the steam regulator to the corresponding position.
Water is dripping from the holes in the soleplate (I).	The temperature regulator (H) is set too low for the iron to produce steam.	Set the temperature regulator within the steam area, between “••” and “max” or turn the steam regulator (C) to “0”.
	You have pressed the shot of steam button (A) repeatedly without waiting for 5 seconds between each press.	Wait 5 seconds between each press of the jet of steam button.
	Water has been left in the tank (J) when the soleplate was cold, with the steam regulator (C) in 1 or 2 position.	Always empty the tank after ironing and set the steam regulator to “0” after ironing and when filling the tank.
Deposits come out through the holes in the soleplate.	Traces of lime scale from the steam chamber.	Carry out a cleaning cycle - see “Multiple descaling system” section of the instructions for use.

Thank you for buying the TDA23 steam iron from Bosch. This appliance is intended for domestic and not industrial use. Keep the operating instructions in a safe place! Please visit www.bosch-home.co.uk for more product information or to register your product, just follow the link to the Online guarantee registration. You can download this manual from the local homepages of Bosch.

General safety instructions

- The iron must not be left unattended while it is connected to the supply mains.
- Remove the plug from the socket before filling the appliance with water or before pouring out the remaining water after use.
- The appliance must be used and placed on a stable surface.
- When placed on its stand, make sure that the surface on which the stand is placed is stable.
- The iron should not be used if it has been dropped, if there are visible signs of damage or if it is leaking water. It must be checked by an authorized Technical Service Centre before it can be used again.
- With the aim of avoiding dangerous situations, any work or repair that the appliance may need, e.g. replacing a faulty mains cable, must only be carried out by qualified personnel from an Authorised Technical Service Centre.
- This appliance can be used by children aged from 8 years and above and persons with reduced physical, sensory or mental capabilities or lack of experience and knowledge if they have been given supervision or instruction concerning use of the appliance in a safe way and understand the hazards involved. Children shall not play with the appliance. Cleaning and user maintenance shall not be made by children without supervision.

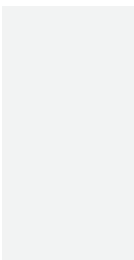

**Customer Service
Great Britain**
Bosch Customer Service
Grand Union House
Old Wolverton Road Milton Keynes
MK12 5PT

UK +44 (0)344 892 8979
IRL +353 (0)1450 2655

www.bosch-home.co.uk

006 TDA23..GB/07/15
9001052027

- Keep the iron and its cord out of reach of children less than 8 years of age when it is energized or cooling down.
- This appliance is designed only for household use up to 2000m above sea level.

Important notices

- This appliance is to be connected and used in accordance with the information stated on its characteristics plate.
- This appliance must be connected to an earthed socket. If it is absolutely necessary to use an extension cable, make sure that it is suitable for 16A and has a socket with an earth connection.
- If the safety fuse fitted in the appliance blows, the appliance will be rendered inoperative. To restore normal operation the appliance will have to be taken to an authorised Technical Service Centre.
- The appliance must never be placed directly under the tap to fill the water tank.
- Unplug the appliance from the mains supply after each use, or if a fault is suspected.
- The electrical plug must not be removed from the socket by pulling the cable.
- Never immerse the iron in water or any other fluid.
- Do not leave the appliance exposed to weather conditions (rain, sun, frost, etc.).

TIPS TO HELP YOU SAVE ENERGY

- Steam production consumes the most energy. To help minimise the energy used, follow the advice below:
- Regulate the steam according to the selected ironing temperature, following the instructions in this manual.
 - Try to Iron the fabrics while they are still damp and reduce the steam setting. Steam will be generated from the fabrics rather than the iron. If you tumble dry your fabrics before ironing them, set the tumble drier on the ‘iron dry’ programme.
 - Stand the iron upright during pauses. Resting it horizontally with the steam regulator on generates wasted steam.





Register your new Bosch now:
<http://www.bosch-home.co.uk>



TDA23..

 **BOSCH**

en Operating instructions

GUARANTEE TERMS

The terms of the guarantee for this appliance are in accordance with that stated by our representative for the country in which it is sold. Details of those conditions can be obtained from the retailer from whom the appliance was purchased. The SALES RECEIPT must be presented when making any claims against the terms of this guarantee. We reserve the right to make technical modifications.

ADVICE ON DISPOSAL



This appliance is labelled in accordance with European Directive 2012/19/EU concerning used electrical and electronic appliances (waste electrical and electronic equipment -WEEE).

The guideline determines the framework for the return and recycling of used appliances as applicable throughout the EU.

Your iron

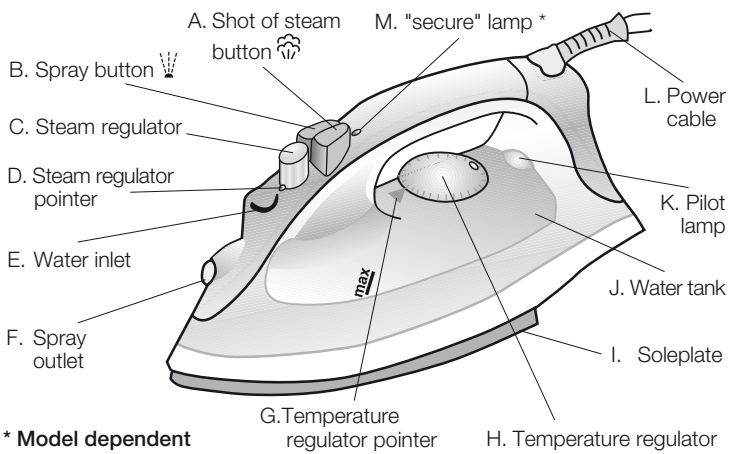

* Model dependent

Before using your appliance for the first time

Fill the water tank (J) of the iron with tap water and set the temperature regulator (H) to “max”

Plug in the appliance to the mains. When the steam iron has reached the desired temperature (pilot lamp K goes out), let the water create steam by setting the steam regulator (C) to “2” and by repeatedly pressing the button (A).

When using the steam function for the first time, do not direct the steam towards the laundry, as there could still be contaminants in the steam dispenser.

Using the appliance

The pilot lamp (K) switches on while the iron is heating up. As soon as the selected temperature has been reached, the light goes out. If the iron is already hot, you can continue ironing while the iron is heating up.

Sort laundry according to the fabric care labels and start at the lowest temperature “•”.

- Synthetics
- Silk – Wool
- Cotton – Linen

1 Filling the tank

Set the steam regulator (C) to “0” and remove the plug!

Use only clean water from the tap without mixing anything with it. The addition of other liquids, such as perfume, will damage the appliance.

Any damage caused by the use of the aforementioned products, will make the guarantee void.

Do not use condensation water from tumble dryers, air conditionings or similar. This appliance has been designed to use normal tap water.

To prolong the optimum steam function, mix tap water with distilled water 1:1. If the tap water in your district is very hard, mix tap water with distilled water 1:2.

Never fill beyond the “max” water level mark.

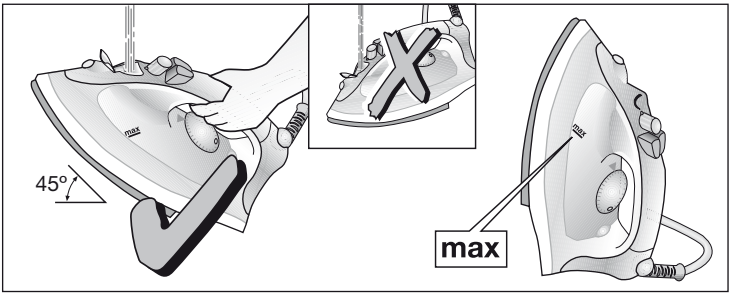

2 Ironing without steam

Set the steam regulator (C) to “0”.

Set the temperature regulator (H) to an appropriate position for the type of material being ironed.

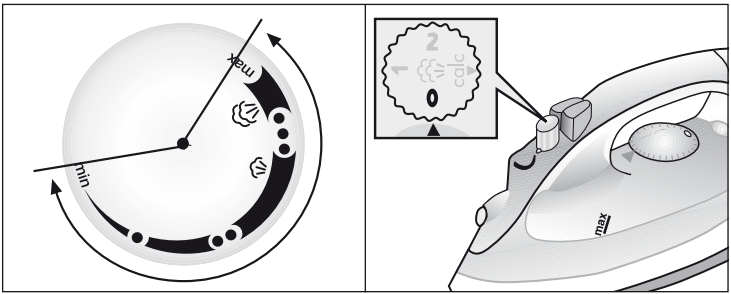

3 Ironing with steam

The steam function is only available when the temperature regulator is in the areas marked by the steam symbol between “••” and “max”.

Set the temperature regulator (H) to position “••”: steam regulator (C) to “1”.

Set the temperature regulator to position “•••” or “max”: steam regulator to “2”.

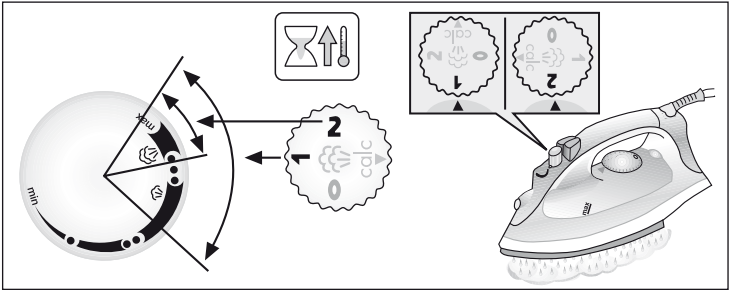

4 Extra steam

To facilitate the ironing of very creased laundry or thick materials, the volume of steam can be increased briefly.

To do this, press the steam regulator (C) for maximum 2 seconds at intervals of 5 seconds.



5 Shot of steam

Set the temperature regulator (H) to the “•••” or “max” position and the steam regulator (C) to the “2” position.

Press the shot of steam button (A) repeatedly with intervals of at least 5 seconds.

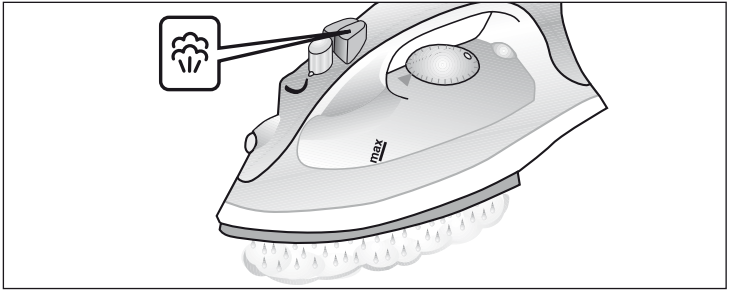

6 Vertical steam

Never direct the steam jet at garments that are being worn. Never aim the steam at people or animals.

Set the temperature regulator (H) to the “•••” or “max” position and the steam regulator (C) to the “2” position.

Hang article of clothing on a clothes hanger.

Operate the iron in a vertical position at a distance of 10 cm / 4 in. and press the shot of steam button (A) repeatedly with pauses of at least 5 seconds.

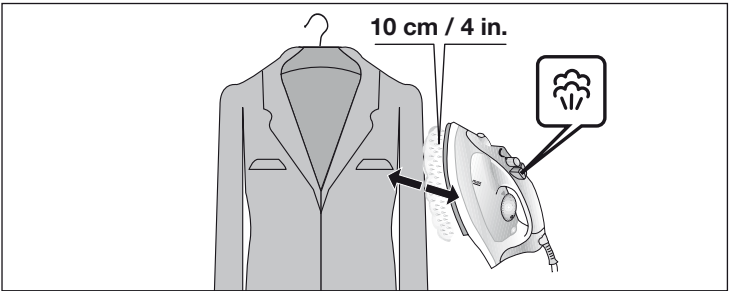

7 Spray

Do not use the spray function with silk.

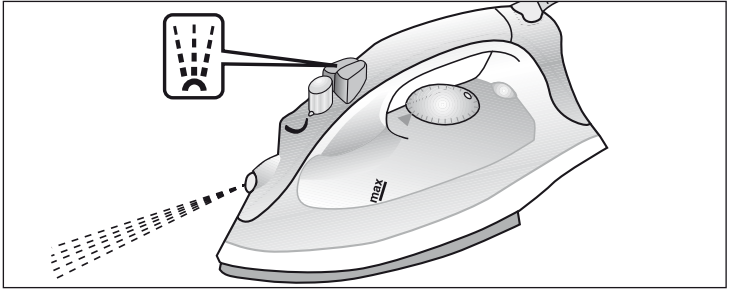

8 After each ironing

Set the steam regulator (C) to “0” and remove the plug!

Empty the tank (J). Hold the iron with the tip pointing downwards and shake gently.

Store the iron on its rear, not on the soleplate (I).

The cable can be wound up at the rear of the appliance. Do not wrap the power cord too tight!

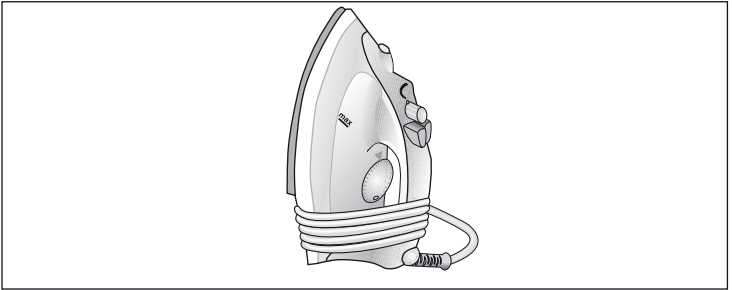

Cleaning the appliance

⚠ Caution! Risk of burns!

Always unplug the appliance from the mains supply before carrying out any cleaning or maintenance operation on it.

1. Never decalcify the water tank (J) or treat it with detergents or solvents, otherwise the iron will drip water whilst steaming!
2. If the iron is only slightly soiled, allow the soleplate (I) to cool down. Wipe the housing and the soleplate with a damp cotton cloth only.
3. If the cloth is synthetic, it may melt due to the high temperature on the soleplate. Switch off the steam and rub off any residue immediately with a thickly folded, damp cotton cloth.
4. To keep the soleplate smooth, you should avoid hard contact with metal objects. Never use a scouring pad, or chemicals to clean the soleplate.

Additional functions

9 Multiple descaling system

Depending on the model, this range is equipped with the “AntiCalc ” (component 1 + 2 + 3) descaling system.

1. **self-clean**
- Each time you use the steam regulator (C), the “self-clean” system cleans the mechanism of scale deposits.
2. **Calc’nClean**
- The “Calc’nClean” function helps to remove scale particles out of the steam chamber.
- Use this function approximately every 2 weeks if the water in your area is very hard.
1. Set the temperature regulator (H) to the “max” position and plug in the iron.
2. After the necessary warm-up period (the pilot lamp K goes out), unplug the iron.
3. Hold the iron over a sink and remove the steam regulator (C) by turning it to the “calc” position while pressing it.

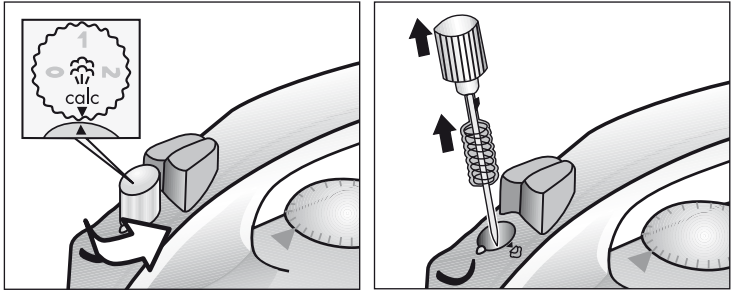

4. Slowly pour water (approximately 300 ml) into the steam regulator hole.

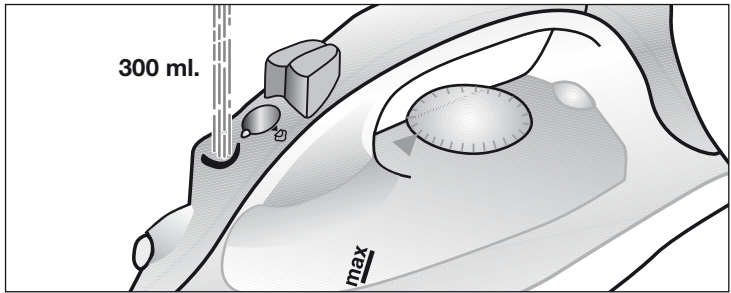

5. Gently shake the iron. Boiling water and steam will come out of the soleplate (I) carrying scale or deposits that might be there. When the iron stops dripping, reassemble the steam regulator by reinserting it, lining up the “calc” position with the pointer (D), pressing it in and turning it to the “0” position.

6. Plug in the iron. Heat up the iron again until the remaining water has evaporated.

Tip: If the steam regulator needle is soiled, remove any deposits from the tip with vinegar and rinse it off with clean water.

3. **anti-calc**

The “anti-calc” cartridge has been designed to reduce the build-up of scale produced during steam ironing, helping to extend the useful life of your iron. Nevertheless the “anti-calc” cartridge cannot remove all of the scale that is produced naturally over time.

10 “secure” auto shut-off function

(Model dependent)

The “secure” auto shut-off function switches off the iron when it is left unattended, thus increasing security and saving energy.

1. Plug in the iron.
2. Initial heating up process: this function will be inactive for the first two minutes in order to give the appliance time to reach the set temperature.
3. The safety circuit will switch the appliance off automatically and the indicator lamp (M) will start flashing in the following cases:
 - a If the iron is not moved for 30 seconds while resting on its soleplate (I) or on its side.
 - b If the iron is not moved for 8 minutes while in the upright position.
4. To reconnect the iron, just move it about gently.

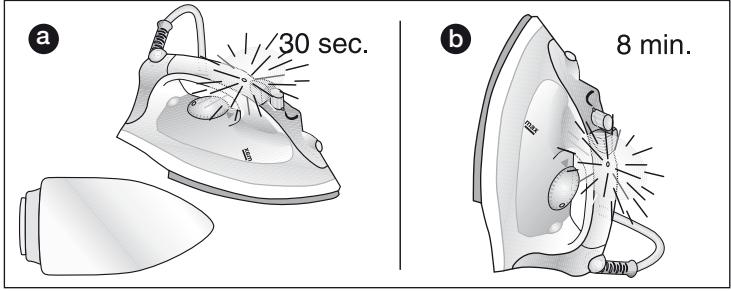

11 Large filling inlet with lid

(Model dependent)

