

**Serie | 4, Washing machine, front loader, 8 kg, 1200 rpm
WAN24109GB**



Optional accessories

WMZ2200 :
WMZ2381 : Extension for cold water inlet /Aquastop



**Automatic washing machine with
EcoSilence Drive™: quiet operation and
durability that you can rely on.**

- **EcoSilence Drive™:** extremely energy-efficient and quiet in operation with a 10-year warranty.
- **SpeedPerfect:** perfectly clean in up to 65% less time.
- **ActiveWater™:** saves water and costs thanks to a 2-step automatic load adjustment system.
- Easy-to-use LED display with touch control and many additional functions like start delay and remaining time.
- **AntiVibration™ Design:** extremely stable and especially quiet thanks to special vibration protection.

Technical Data

Construction type :	Free-standing
Height of removable worktop (mm) :	850
Dimensions of the product (mm) :	848 x 598 x 550
Net weight (kg) :	70.826
Connection rating (W) :	2300
Current (A) :	10
Voltage (V) :	220-240
Frequency (Hz) :	50
Approval certificates :	CE, VDE
Length of electrical supply cord (cm) :	210
Washing performance class :	A
Door hinge :	Left
Wheels :	No
EAN code :	4242005241972
Capacity cotton (kg) - NEW (2010/30/EC) :	8.0
Energy efficiency rating :	A+++
Energy consumption annual (kWh/annum) - NEW (2010/30/EC) :	175.00
:	0.12
:	0.50
Water consumption annual (l/annum) - NEW (2010/30/EC) :	9900
Spin drying performance class :	B
Maximum spin speed (rpm) - NEW (2010/30/EC) :	1200
Average washing time cotton 40C (partial load) - NEW (2010/30/EC) :	180
Average washing time cotton 60C (full load) (min) - NEW (2010/30/EC) :	225
Average washing time cotton 60C (partial load) - NEW (2010/30/EC) :	210
Noise level washing (dB(A) re 1 pW) :	52
Noise level spinning (dB(A) re 1 pW) :	76
Installation type :	Free-standing



Serie | 4, Washing machine, front loader, 8 kg, 1200 rpm WAN24109GB

Automatic washing machine with EcoSilence Drive™: quiet operation and durability that you can rely on.

Performance

- Energy Efficiency Class: A+++
- Capacity: 8 kg
- Maximum spin speed: 1200 rpm**
- B spin class
- Energy consumption :Weighted p.a. E-Consump. EU: 175 kWh kWh per year, based on 220 standard washing cycles
- -10% more economical (175 kWh/year) than the standard value (196 kWh/year)
- Energy consumption: standard 60 °C cotton programme 0.92 kWh full load and 0.73 kWh partial load and 40 °C cotton programme 0.63 kWh partial load
- Indication that Eco 40-60 is the standard washing programmes to which the information in the label and the fiche relates, that these programmes are suitable to clean normally soiled cotton laundry and that they are the most efficient programmes in terms of combined energy and water consumption. The actual temperature may vary with this combination from the specified program temperature. Washing times will be extended for the benefit of lower energy consumption. Washing effect A is always guaranteed in the process.
- Weighted power consumption off-mode / left-on mode: 0.12 W / 0.5 W
- Water consumption 9900 litres per year, based on 220 standard washing cycles
- Programme time: 60 °C cotton programme 225 min at full load 210 min at partial load and 40 °C cotton programme 180 min partial load
- Drum volume: 55 litres
- Noise level washing : 52dB (A) re 1pW: Noise level spinning: 76dB (A) re 1 pW

Programmes/functions

- Touch control buttons: Prewash, Ready in, Temperature selection, SpeedPerfect, start/pause with reload function, Aqua Plus, Spin speed reduction
- Special programmes: Rinse, Dark Wash, Shirts, Sportswear, Mixed Load, Allergy +, Super Quick 15/30, Quiet Wash, Wool/ Handwash, Delicate/Silk programme
- Safeguard monitoring system adjusts load distribution and programme settings to protect clothes

Key features

- Fully electronic control dial for all wash and special programmes
- SpeedPerfect: perfectly clean in up to 65% less time.
- Reload function: Be flexible in adding laundry items even after start of the wash cycle.
- EcoSilence drive with 10 year warranty
- AntiVibration Design - for more stability and quietness

Additional features

- Large display for temperature, spin speed, remaining time, 24 hours end time delay and load recommendation
- 3D AquaSpa wash system with cascade for faster water penetration
- Continuous automatic load adjustment system
- Multiple Water Protection
- Foam detection system
- Divider for Liquid Detergent
- Child lock
- Buzzer to indicate the end of cycle

Technical Information

- Slide-under installation
- Large silver-white door with 180° opening and 30 cm porthole
- Dimensions (H X W X D): 84.8 x 59.8 x 60 cm

**** Values are rounded.**

**Serie | 4, Washing machine, front loader, 8
kg, 1200 rpm
WAN24109GB**

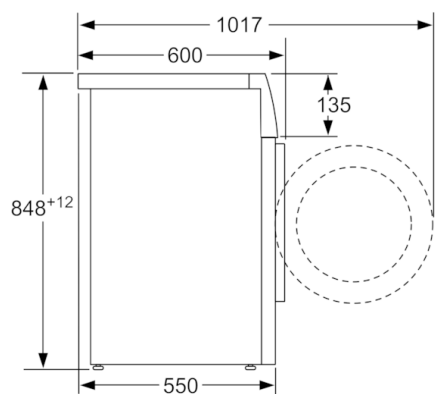

measurements in mm