

Serie | 8

**WAW325H0GB**  
Automatic washing machine



**A+++**

Enjoy this supremely quiet and reliable appliance. Control your washing machine from anywhere with Home Connect via the smartphone or tablet PC app.

- **EcoSilence Drive™**: extremely energy-efficient and quiet in operation with a 10-year warranty.
- **Home Connect**: home appliances with smart connectivity for an easier everyday life.
- **Energy efficiency class A+++ -30%**: 30% more efficient than the best efficiency class.
- **AutoStain**: removes the four most common stains.
- **Consumption indication**: easy operation and indication of energy and water consumption.

**Technical Data**

Construction type :	Free-standing
Height of removable worktop (mm) :	850
Dimensions of the product (mm) :	848 x 598 x 590
Net weight (kg) :	79.7
Connection rating (W) :	2300
Current (A) :	10
Voltage (V) :	220-240
Frequency (Hz) :	50
Approval certificates :	CE, VDE
Length of electrical supply cord (cm) :	160
Washing performance class :	A
Door hinge :	Left
Wheels :	No
Power consumption standby/network: Please check the user manual for how to switch off the WiFi module. :	0.9
Time auto-standby/network :	20.0
EAN code :	4242005074907
Capacity cotton (kg) - NEW (2010/30/EC) :	9.0
Energy efficiency class (2010/30/EC) :	A+++
Energy consumption annual (kWh/annum) - NEW (2010/30/EC) :	152
Power consumption in off-mode (W) - NEW (2010/30/EC) :	0.12
Power consumption in left-on mode - NEW (2010/30/EC) :	0.43
Water consumption annual (l/annum) - NEW (2010/30/EC) :	11220
Spin drying performance class :	A
Maximum spin speed (rpm) - NEW (2010/30/EC) :	1556
Average washing time cotton 40C (partial load) - NEW (2010/30/EC) :	285
Average washing time cotton 60C (full load) (min) - NEW (2010/30/EC) :	285
Average washing time cotton 60C (partial load) - NEW (2010/30/EC) :	285
Duration of the left-on mode - NEW (2012/30/EC) (min) :	20
Noise level washing (dB(A) re 1 pW) :	47
Noise level spinning (dB(A) re 1 pW) :	73
Installation type :	Free-standing



**Optional accessories**

- WMZ2200 : Floor securing component  
WMZ2380 : Extension for cold water inlet /Aquastop



## Serie | 8 Washing Machines

### WAW325H0GB

#### Automatic washing machine

**Enjoy this supremely quiet and reliable appliance. Control your washing machine from anywhere with Home Connect via the smartphone or tablet PC app.**

#### Performance

- Energy Efficiency Class: A+++ at a range of energy efficiency classes from A+++ to D
- Capacity: 9 kg
- Maximum spin speed: 1600 rpm
- A spin class
- Energy consumption :152 kWh per year, based on 220 standard washing cycles
- -30% more economical (152kWh/year) than the standard value (217 kWh/year) of energy efficiency class A+++
- Energy consumption: standard 60 °C cotton programme 0.92 kwh full load and 0.6 kwh partial load and 40 °C cotton programme 0.42 kwh partial load
- Cottons 60 Eco and Cottons 40 Eco are the standard washing programmes to which the information in the label relates. These programmes are suitable to clean normally soiled cotton laundry and are the most efficient programmes in terms of combined energy and water consumption.
- Weighted power consumption off-mode / left-on mode: 0.12 W / 0.43 W
- Duration of the left-on mode: 20 min
- Water consumption 11220 litres per year, based on 220 standard washing cycles
- Programme time:60 °C cotton programme 285 min at full load 285 min at partial load and 40 °C cotton programme 285 min partial load
- Drum volume: 65 litres
- Noise level washing : 47dB (A) re 1pW: Noise level spinning:73dB (A) re 1 pW

#### Programmes/functions

- Touch control buttons: start/pause with reload function, Prewash, Spin speed reduction, Aqua Plus option for best rinsing results, Temperature selection, SpeedPerfect, EcoPerfect, stain selection, Remote Start and 24 h Start time delay
- Special programmes: Night Wash, Shirts, Sportswear, Super Quick 15, Mixed Load, Allergy +, Duvet, Drum clean with reminder, rinse/spin/drain, Wool/Handwash, Delicate/Silk programme
- Safeguard monitoring system adjusts load distribution and programme settings to protect clothes

#### Key features

- Home Connect: Remote Monitoring and Control
- Fully electronic control dial for wash programmes, temperature and special programmes
- EcoBar Plus function: five possible levels of energy and water consumption
- AutoStain Removal System with 4 stain options - actioned with standard programmes
- VarioPerfect: speed or energy efficiency with perfect wash performance every time
- ActiveWater: water management system
- EcoSilence drive with 10 year warranty
- AntiVibration Design - for more stability and quietness
- Reload function: Flexibility in adding laundry items into the drum, even after the wash cycle has started.

#### Additional features

- Large LCD display for programme status indication, temperature selection, max. spin speed, remaining time and 24 hours end time delay, stain selection and consumption indication
- WaveDrum: gentle and efficient washing
- 3D AquaSpa wash system with cascade for faster water penetration
- Drum clean with reminder function
- Drum interior light
- Reload facility
- Easy cleaning detergent drawer
- Divider for Liquid Detergent
- Flow-through sensor for optimum water use
- Multiple Water Protection
- Continuous load adjustment
- Overdosage indication
- Foam detection system
- Child lock
- Buzzer to indicate the end of cycle

#### Technical Information

- Dimensions (H X W X D): 84.8 x 59.8 x 59 cm
- Slide-under installation
- Large chrome, white door with 171° opening and 32cm porthole opening

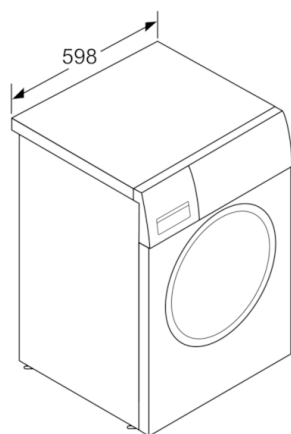
**Serie | 8 Washing Machines****WAW325H0GB****Automatic washing machine**

measurements in mm

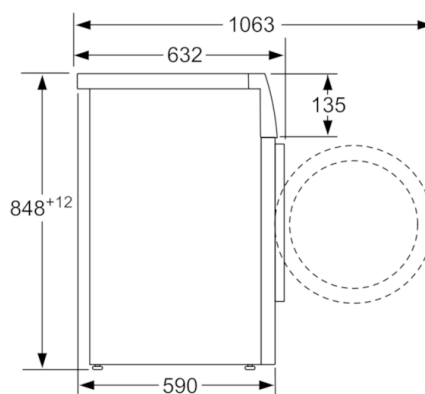

measurements in mm