

# PureMat<sup>e</sup>™

## PM 906 DIGITAL ULTRASONIC COOL & WARM MIST HUMIDIFIER

WITH IONISER



## INSTRUCTION MANUAL

**SUPER TECH HEALTH**

English©2015 – PM906

Thank you for purchasing the innovative PureMate PM 906 Digital Ultrasonic Cool and Warm Mist Humidifier .We wish you many years of healthy indoor air with this efficient and effective product.

Ensure that all safety precautions are followed when using this electrical appliance for the proper operation of the device. These instructions describe the safety precautions to be observed during operation. They are designed to prevent injuries or damage to this device.

## SAFETY PRECAUTIONS

The inner ultrasonic transducer is highly sensitive. Do not touch it with bare fingers or scrape it with metal tools, or it will reduce mist output. When cleaning this area please use a small cleaning brush, cotton swab or toothbrush. Do not use hot water as it may damage the missing parts.

Use proper voltage AC 220~240V 50Hz in UK and Europe. Use of improper voltage may cause fire hazard or electric shock.

To prevent electric shock, do not dismantle, repair or modify this product. Maintenance and cleaning should be followed exactly as instructed in this manual. In the event of a malfunction, please contact an authorized Pure Mate maintenance centre.

Do not use in areas where flammable or explosive materials are stored.

Do not place this device in direct sunlight or near objects that generate high temperature heat. The heat may cause deformation or warping of the outer casing. Do not operate the unit without water in the basin.

Do not insert foreign objects into the device. Do not touch the transducer or the lower water basin when the unit is operating. Do not scratch the transducer. Do not touch the mist output when producing warm mist.

Do not submerge this device in water. Water or cleaning liquids may only be used on parts to be cleaned according to the cleaning and maintenance instructions.

Only use lime scale remover or vinegar to clean mineral deposits from the basin or transducer. Do not use any harsh detergents that may damage the unit.

If you smell an abnormal odour please turn off and unplug the unit and call PureMate technical support.

Do not use fabrics or other materials to cover this device. Obstructed air inlets and outlets will result in improper operation of this unit and may result in fire or other damage

Do not plug in or pull out the power cable with wet hands. Do not disassemble the base unit. Before cleaning and maintenance, the appliance must be disconnected from the main supply. Do not touch water and components in the water basin when the unit is working.

Children should be supervised to ensure that they do not play with the appliance.

To prevent interference and damage to other electronic devices, this machine should be placed at least 1 meter away from a computer, television, radio or other electronic equipment.

For safety reasons and to prevent fire or electric shock, unplug the power cord from the electric outlet socket whenever you:

- o Do not use the device for a long period of time.
- o Remove the tank, clean or service the machine or the permanent filter.
- o Move or transport the device.

If the power cord is damaged, then it must be replaced by a qualified person to prevent electric shock or fire.

## IMPORTANT

The transducer, filter and basin should be cleaned regularly. Please refer to the cleaning and maintenance.

# COMPONENTS

## Major PM 906 components:

- 1 - "Power" button for switching on/off the unit
- 2 - "ION" button for switching on/off the ioniser mode
- 3 - "Max-Min" button for setting the mist release intensity
- 4 - "Heating" button for switching on/off the water heating mode
- 5 - "Humidity" button for setting the relative humidity in the room
- 6 - "Timer" setting button
- 7 - Display
- 8 - Mist release opening
- 9 - Handle for convenient filling/carrying the water tank
- 10 - Water Tank
- 11 - Water Inlet
- 12 - Cartridge filter
- 13 - Water tank lid
- 14 - Sprayer
- 15 - Water tank illumination
- 16 - Body

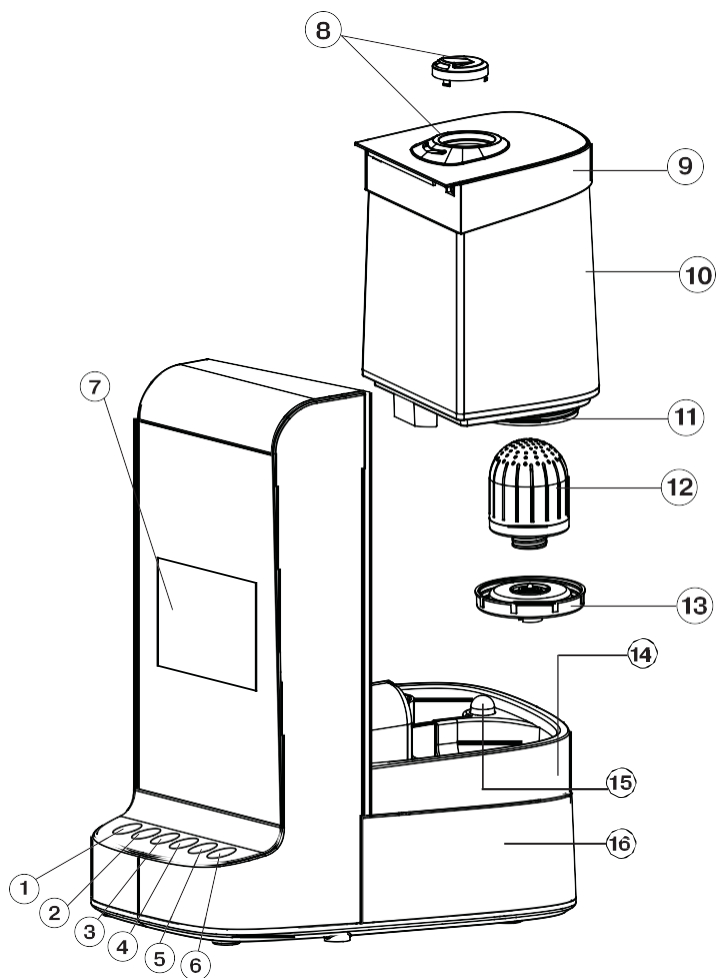

## LCD DISPLAY

The LCD display shows the numeric values for temperature and relative humidity and the length of time remaining on the timer. It also displays the icons used to indicate other humidifier functions.

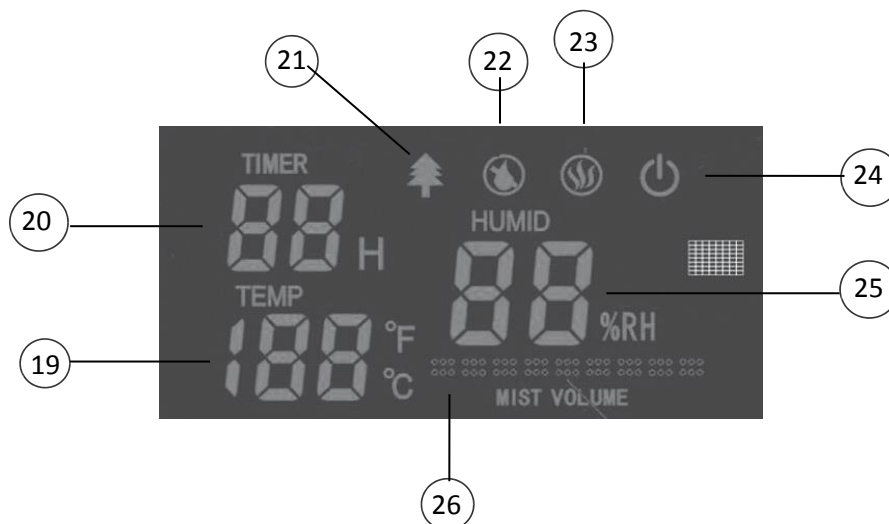

### Display (7) icons

- 19 - Room temperature indication
- 20 - Operation time left indication
- 21 - Ioniser mode icon
- 22 - Empty water tank icon
- 23 - Water heating-up mode icon
- 24 - Humidifier On/Off icon
- 25 - Room humidity/preset humidity indication
- 26 - Humidity level intensity indication

## REMOTE CONTROL

The PM 906 is equipped with a very useful remote control. You can activate the remote control by removing the protective film from the battery area located at the bottom edge of the unit just below our logo.

### Remote control (17)

- 27 - Button for setting the relative humidity in the room
- 28 - Button for setting the mist release density
- 29 - On/Off button of the unit
- 30 - On/Off button of Ioniser mode
- 31 - On/Off button of water heating-up mode
- 32 - Timer setting button

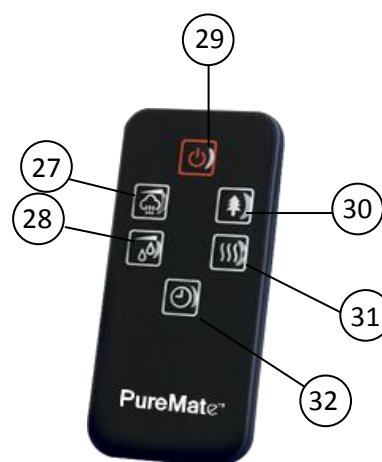

# OPERATING INSTRUCTIONS

Before getting started, please remove the PM 906 from its box and allow it to become accustomed to the room temperature for at least 30 minutes especially if the machine is cold from the outside air. The PM 906 is designed to operate at temperatures between 5-40 °C and relative humidity of less than 80%.

## Operation steps:

Take the water tank out of the unit, open the water tank cover, and fill the tank with clear water. Close the cover, and put the tank onto the base unit carefully.

Put the nozzle into the socket on top of the water tank.

Connect the main supply, switch on the unit (NEVER RUN THE UNIT WHEN THERE IS NO WATER IN WATER BASIN), the main connection lamp will be on. The unit starts working.

1. Put the machine on a flat surface.
2. Fill the water into the water tank, and then tighten the tank cover.
3. Put the water tank on the main body.
4. Check if the rated voltage meets the input voltage, and plug in the socket.
5. Switch on the machine; the background light of LCD will be on. The machine begins to work.
6. Touch the symbol "MAX-MIN", you may adjust the mist volume. On the remote control, just press the button of "MIST VOLUME".
7. Touch the symbol "ION", the Negative ion generator works. On the LCD display, it shows the shape of trees.  
Touch again to stop the function.
8. Touch the symbol "HEATING", the warm mist will come out after 10 minutes. On the LCD display, it shows the shape of fire. Touch again to stop the function. Mist will become cool.
9. Constant humidity: Before you touch the symbol "HUMIDITY", LCD display shows the current humidity. You may set the humidity arranged from 45%RH to 90%RH. Press once, it will increase by 5%RH. When it reaches 90%RH, press again, it will go back to 45%RH. After you set the expected humidity, the machine will keep the memory after 5 seconds. 5 seconds later, LCD display shows the current humidity. If the expected humidity is less than the current humidity, the machine will be in sleeping state. But if the expected humidity is higher than the current humidity, the humidify function will work.
10. Timer setting: There are 12 timer setting: 1,2,3,4,5,6,7,8,9,10,11,12 hours. Touch the symbol "TIMER", LCD display shows the timer. The timer shows the rest operation time and decrease by 1 hours, i.e., if set the timer at 12 hours, LCD display shows 11 after one hour.
11. Once the water in the basin is too little to keep the machine working, the machine will automatically stop working. LCD shows the shape of lack of water. Refill the water, and the machine will restart.

# CLEANING AND MAINTENANCE

**Attention! Always switch off and unplug the unit before cleaning.**

You can ensure many years of trouble free operation of your PM 906 humidifier by following a few simple maintenance procedures. If your water is hard, containing high concentrations of calcium and other minerals, then over a period of time white dust will start to deposit on the various surfaces in the room. A white, film-like substance will also start to develop in the water basin, on the transducer and on the inner surface of the water tank. This white film will impede the proper function of the transducer and the operation of the machine.

**We recommend the following :**

1. If your water is very hard, we recommend that you boil it first, allow it to cool completely before use in the humidifier. The boiling will reduce the mineral concentration in the water. The other option is to use distilled water if your mineral level is still too high.
2. If you are using the machine on a daily basis, clean the transducer, water tank and basin once a week.
3. When the water tank needs a refill, empty the remaining water from the tank and fill it with fresh water.
4. Clean the whole machine and make sure to keep all the parts completely dry when the machine is not in use.

**How to clean the transducer:**

1. Place 5-10 drops of vinegar on the surface of the transducer and wait for 2-5 minutes.
2. Using a small brush, cotton swab or toothbrush, gently clean the mineral film from the surface of the transducer.
3. Rinse the transducer with clean water.
4. Never use sharp or solid objects for cleaning the transducer

**How to clean the water basin:**

1. Clean the water with a soft damp cloth. If there is excess film on the surfaces, then soak the cloth with vinegar and repeat the process.
2. If there is a film in any of the depressions along the basin, drop a bit of vinegar into depression and clean it out with a brush.
3. Rinse the basin with clean water.

**How to clean the White Dust & Anti-Microbial Filter:**

1. Remove the filter from the water tank.
2. Put some white vinegar into a glass. Soak the filter in the vinegar for about 10 minutes.
3. Remove the filter from the glass and shake it several times.
4. Clean and rinse the filter once again with fresh water.

If you don't plan to use the humidifier for a long time, remove the filter from the water tank and let it dry thoroughly. Then wrap it in protective packaging and keep it next to the humidifier in a cool, dry and dark storage space.

## STORAGE

- If you are not going to use the humidifier for a long time, make sure that all its parts are dry, including the operating chamber of the sprayer.
- Do not store the unit with water in the water tank and in the operating chamber of the sprayer.
- Clean and dry the filter-cartridge before taking it away for storage. Keep the filter-cartridge in a cool darkened place
- Keep the humidifier away from children in a dry cool place.

# TROUBLESHOOTING

The following is a troubleshooting guide to help you solve any issues that may have with the operation of the PM 906.

Trouble	Possible reasons	Solution
Power icon is off or does not work.	Humidifier is not plugged into the power outlet.	Connect power cord to electrical outlet and press power button.
Power light is on but no mist	No water in water tank.	Fill water tank with water.
The mist has a strange odour.	A new machine.	Remove the water tank, unscrew the lid and let it air out in a cool area for 12 hours.
	It either has dirty water or the water has been stagnant too long.	Clean the water tank and refill with clean water.
Power light is on, but the machine doesn't work.	Too much water in the water basin.	Remove the water tank. Take a small cup and remove some of the water from the machine's water basin. Reinsert the water tank and make sure that it sits properly.
The volume of spray mist is too low.	Too much mineral scale in the water basin.	Clean transducer.
	Water is too dirty or water was kept too long in the tank.	Clean the water tank and refill with clean water.
Abnormal noise	Vibration in the water tank because the water level is too low.	Fill the water tank.
	Machine is on an unstable surface.	Move the unit to a stable flat surface.
Spray mist is coming out of the area around the jets.	There are gaps between the housing around jet nozzles and the top of the water tank.	Dip the nozzle in water for a while, clean it with a damp cloth and put it back to the tank.

## TROUBLESHOOTING

### The following is not considered faulty operation:

- If your water is very hard (containing abnormally high levels of minerals) the humidifier may produce white dust. This is not a malfunction. The solution would be to clean the filter more often or use softer water.
- If you stand very close to the humidifier, you will hear the gurgling sound of water. This is normal.
- The machine operates very quietly but it is not completely silent. Noise levels less than 35 db is considered normal.

### **WARNING!**

If the above recommended solutions do not work, please contact PureMate technical support at the telephone number for your region. Do not attempt to disassemble, repair and reassemble the machine as it may void the warranty.

## PRODUCT SPECIFICATIONS

Model:	PM906
Power supply:	220~240V 50Hz
Energy Consumption:	30W (Cool Mist)110W (Warm Mist)
Water tank capacity:	5L
Mist Evaporation Rate:	Low: 50ml/hr (1.7 oz), Med: 200ml/hr (6.8 oz), High: 300ml/hr (10.1 oz)
Room Coverage Area:	Small: 6.7 m <sup>2</sup> (72 ft <sup>2</sup> ), Med: 26.8 m <sup>2</sup> (287 ft <sup>2</sup> ), Large: 40 m <sup>2</sup> (430 ft <sup>2</sup> )
Noise level:	Low: 30dB(A), High: ≤35dB(A)
Negative Ion Output:	3,000,000/cm <sup>3</sup> (49,161,000/inch <sup>3</sup> )
Dimensions (LxWxH):	20 x 26 x 36 cm
Weight:	2.9 kg dry
Warranty:	One Year Warranty
Safety Certifications:	CE, GS, Rohs



## WARRANTY INFORMATION

PureMate products are subject to strict quality control before leaving the manufacturer. This allows our customers to benefit from repairs, replacement of parts and even replacements for free.

The product has 1 year warranty from the date of purchase.

The warranty shall not apply:

- To any product subjected to misuse, alteration, act of God, improper handling, improper transport, improper testing or unauthorized repair.
- To cosmetic problems or defects which result from normal wear and tear under ordinary use yet not affecting the performance or use of the product.
- If the product is disassembled or altered.
- To any packing, transportation, export / import tax or any related expenses.
- Regular replacement parts such as air filter cartridges and UV-C Lamp.

Customer must present the sales invoice or receipt for 1 year warranty services.

### What You Must Do

1. Contact PureMate customer Service at:



+44 121 270 9423 [www.PureMate.co.uk](http://www.PureMate.co.uk)

for Return Authorization Number.

2. Pack the product in its original carton, and in the same manner in which you received it, or as identical as possible.
3. Include proof of purchase inside box along with the Return Authorization Number.
4. Label and ship the unit, freight pre-paid, to the address provided.

### Other Conditions

The provisions of this warranty are in lieu of any other written warranty whether express or implied, written or oral, including any warranty of merchantability or fitness for a particular purpose. The manufacturer's maximum liability shall not exceed the actual purchase price paid by you for the product. In no event shall the manufacturer be liable for special, incidental, consequential, or indirect damages. This warranty does not cover a defect that has resulted from improper or unreasonable use or maintenance, faulty assembly, accident, natural catastrophes, improper packing, or unauthorized tampering, alteration, or modification as determined solely by us. This warranty is void if the label bearing the serial number has been removed or defaced.

## DISPOSAL OF THIS DEVICE

At the end of the product life cycle, you should not throw this machine into the normal household garbage but bring the product to a collection point for the recycling of electrical and electronic equipment.

